

February 2015

## System:- NV8 System

aluminium support system for  
rain screen cladding panels

### NVELOPE SYSTEM NV8

#### CONTENTS:

- NV8-01 Tolerances for adjustment
- NV8-02 Horizontal section – NVELOPE 90
- NV8-03 Vertical section – NVELOPE 90 SINGLE
- NV8-04 Vertical section – NVELOPE 90 DOUBLE
- NV8-05 Horizontal section–external corner
- NV8-06 Horizontal section–internal corner
- NV8-07 Final fix detail
- NV8-08 Hanger and rail dims
- NV8-09 Adjusting screw details

#### LEGEND:

- A – Cladding SHEET
- C1 – Secret fixing hanger with levelling screw
- C2 – Secret fixing hanger.
- D – Screw
- E – Fixing screw
- F – Window profile
- 1 – Steel frame wall
- 2 – NVELOPE – support bracket
- 3 – Primary Fixing
- 4 – L profile vertical ( 60 X 40 X 2.2 )
- 5 – SR2 self drilling stainless steel screw
- 6 – Horizontal Profile
- 7 – Insulation
- 8 – Ventilation
- 10 – NVELOPE Isolator

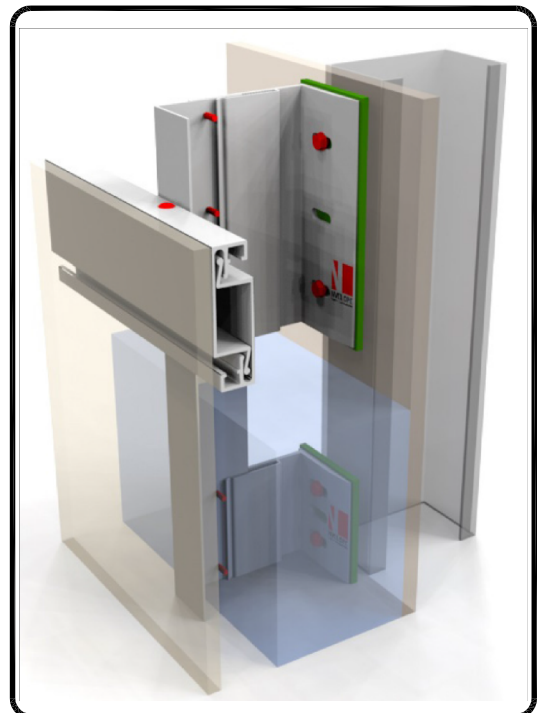
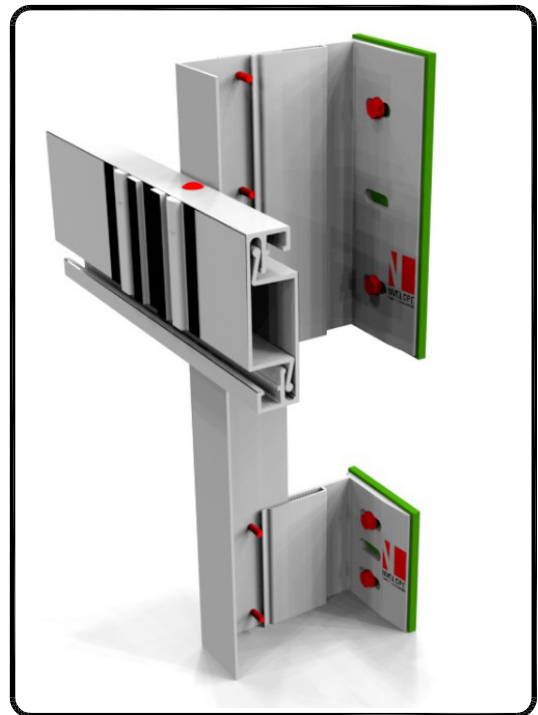

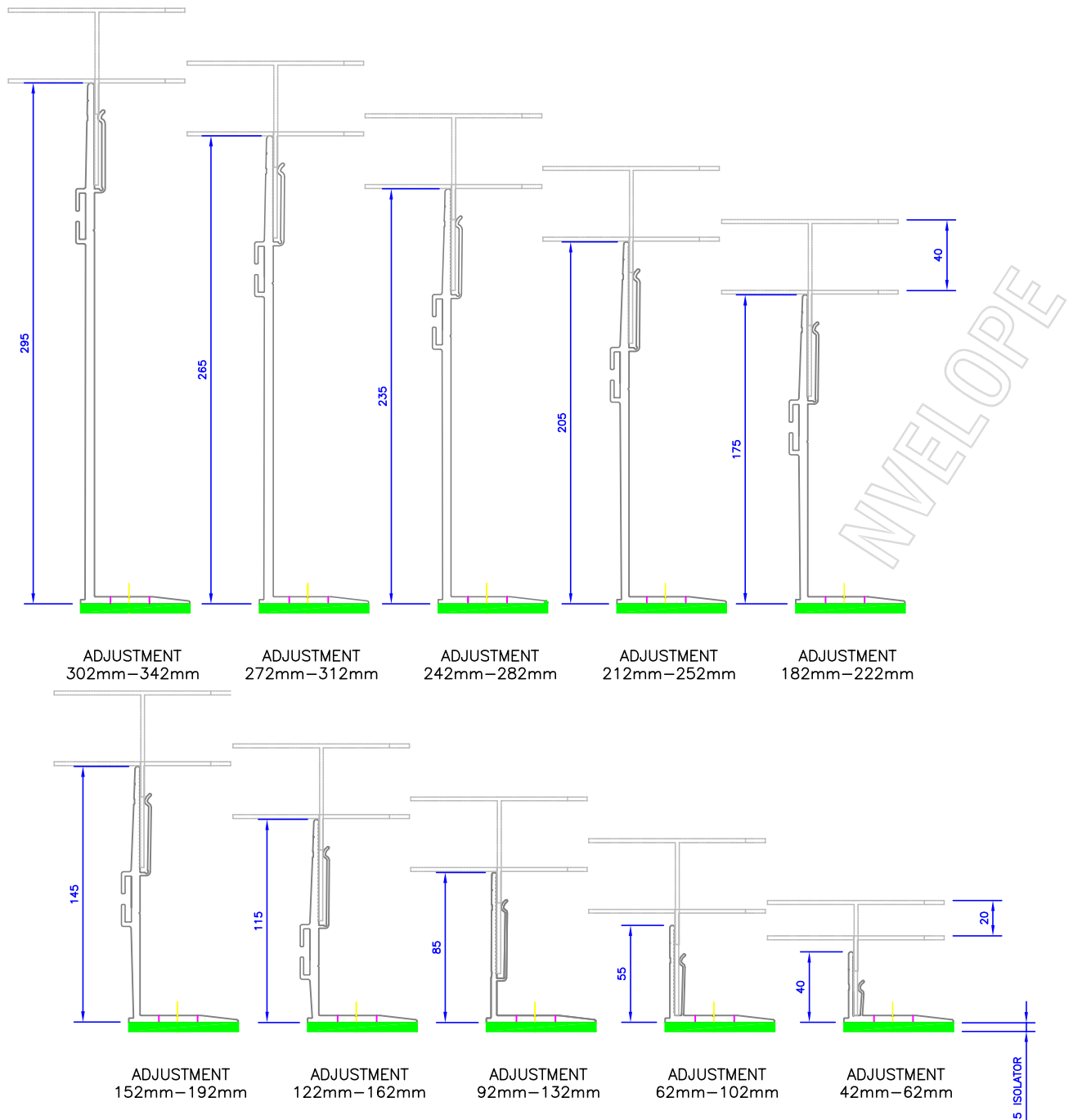

| BRACKETS    | Adjustment range for each bracket ( mm ) |        |
|-------------|--|--------|
| Nvelope 40  | from 42                                  | to 62  |
| Nvelope 60  | from 62                                  | to 102 |
| Nvelope 90  | from 92                                  | to 132 |
| Nvelope 120 | from 122                                 | to 162 |
| Nvelope 150 | from 152                                 | to 192 |
| Nvelope 180 | from 182                                 | to 222 |
| Nvelope 210 | from 212                                 | to 252 |
| Nvelope 240 | from 242                                 | to 282 |
| Nvelope 270 | from 272                                 | to 312 |
| Nvelope 300 | from 302                                 | to 342 |

HORIZONTAL SECTIONS  
TOLERANCES FOR ADJUSTMENT

February 2015

System:- NV8 SYSTEM

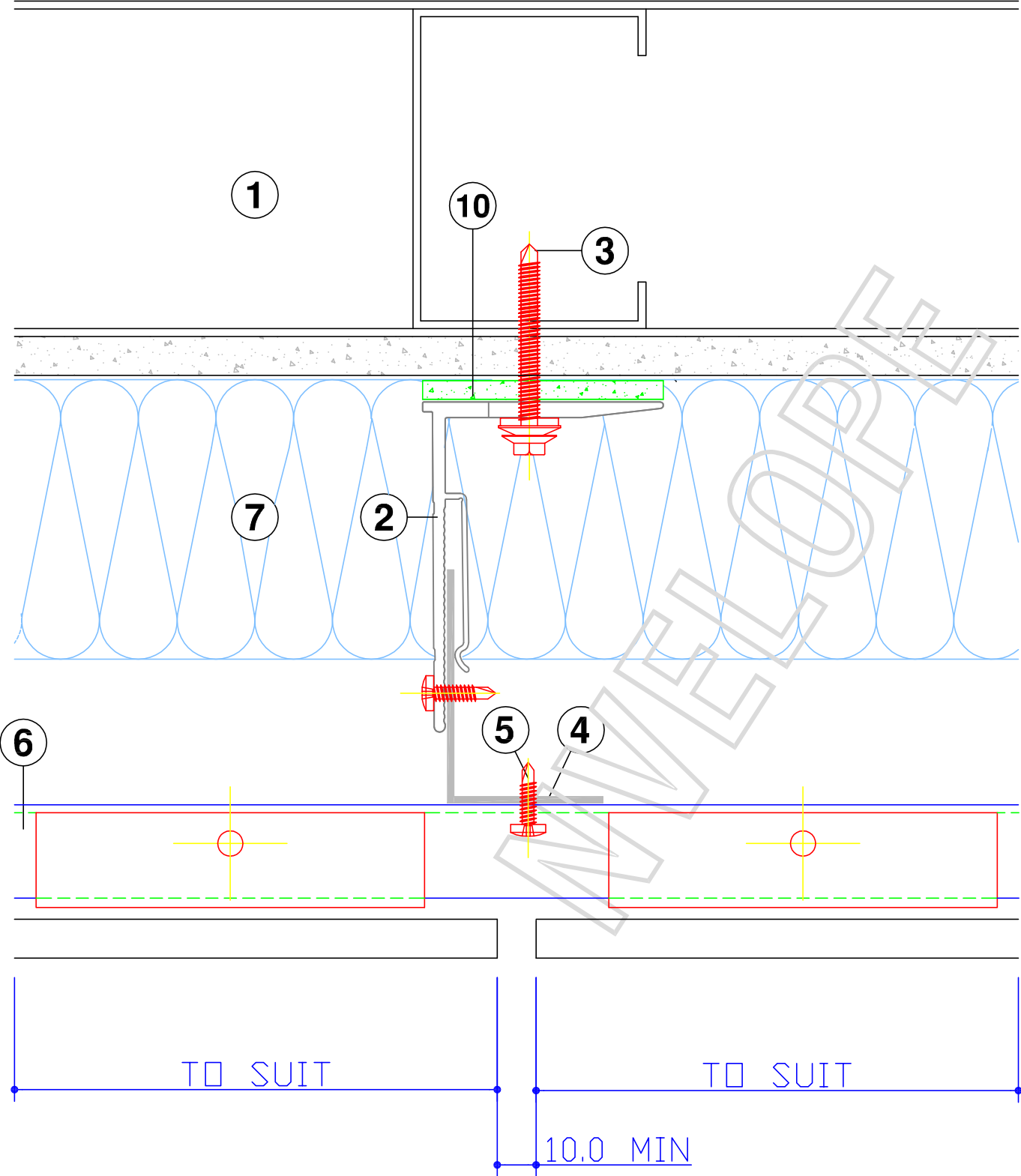

HORIZONTAL SECTION - NVELOPE 90

February 2015

System:- NV8 SYSTEM

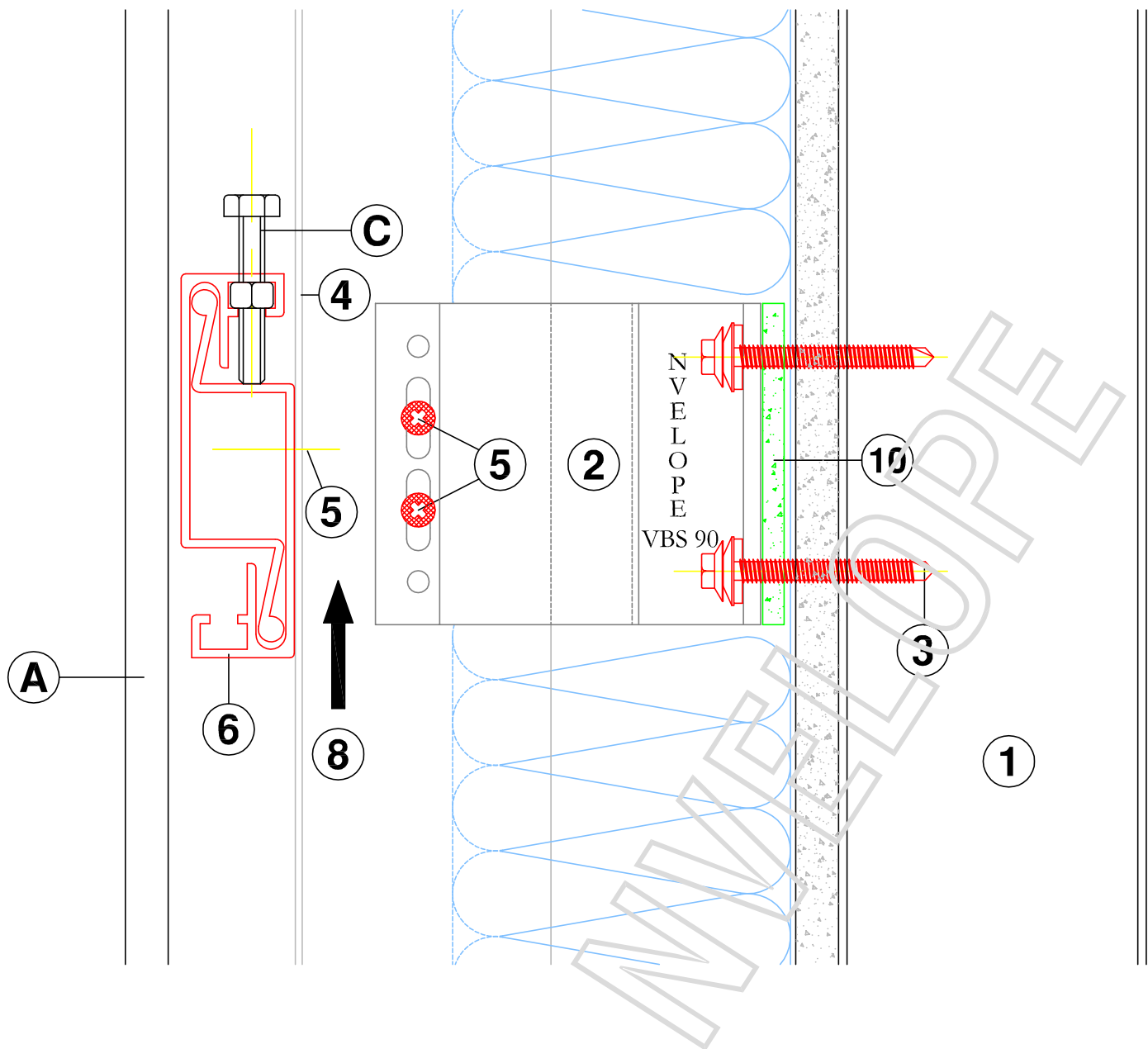

VERTICAL SECTION - NVELOPE 90 SINGLE

NVELOPE RAINSCREEN SYSTEMS Ltd - tel - 01707 333396 - fax - 01707 333343

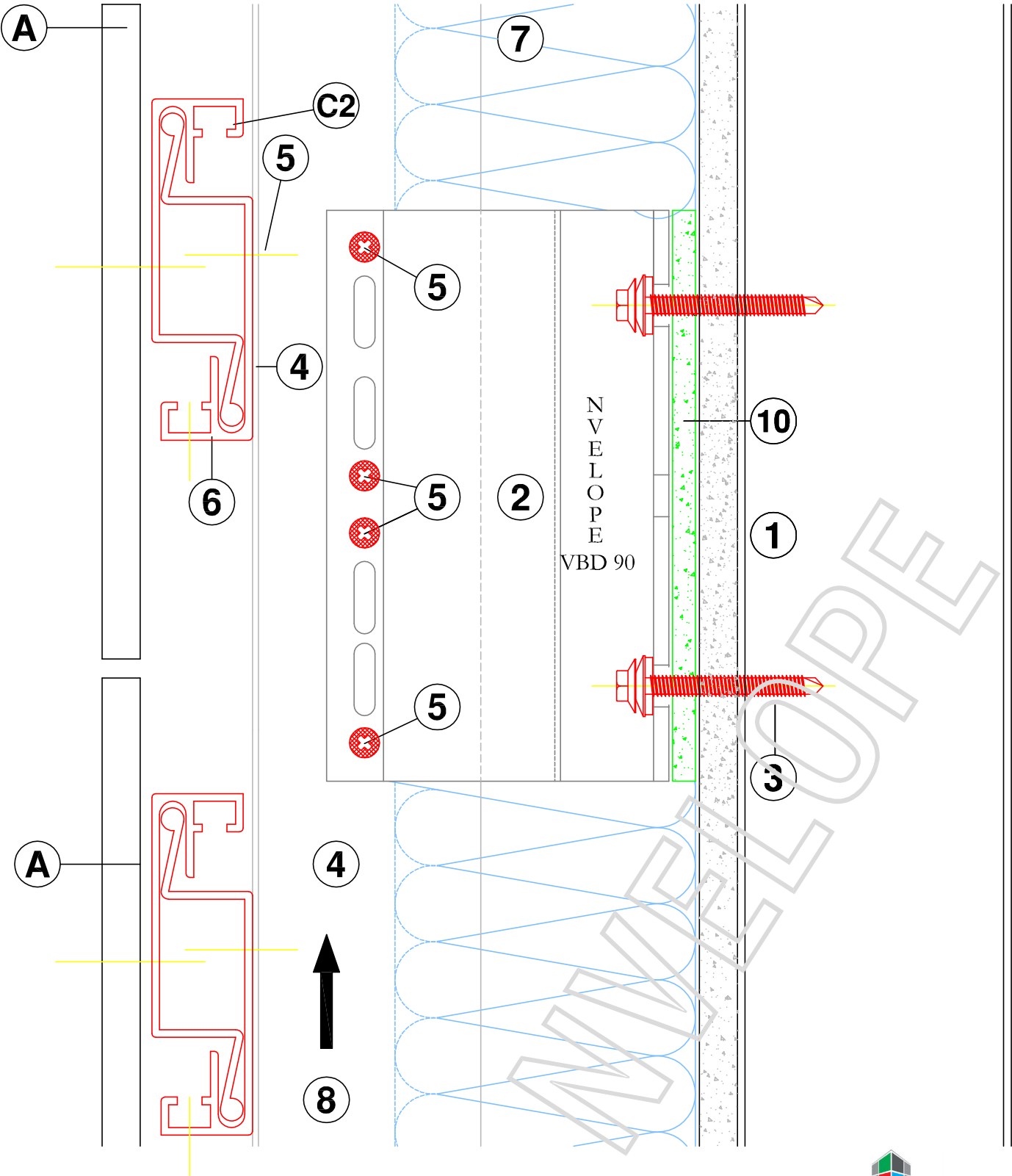

VERTICAL SECTION - NVELOPE DOUBLE

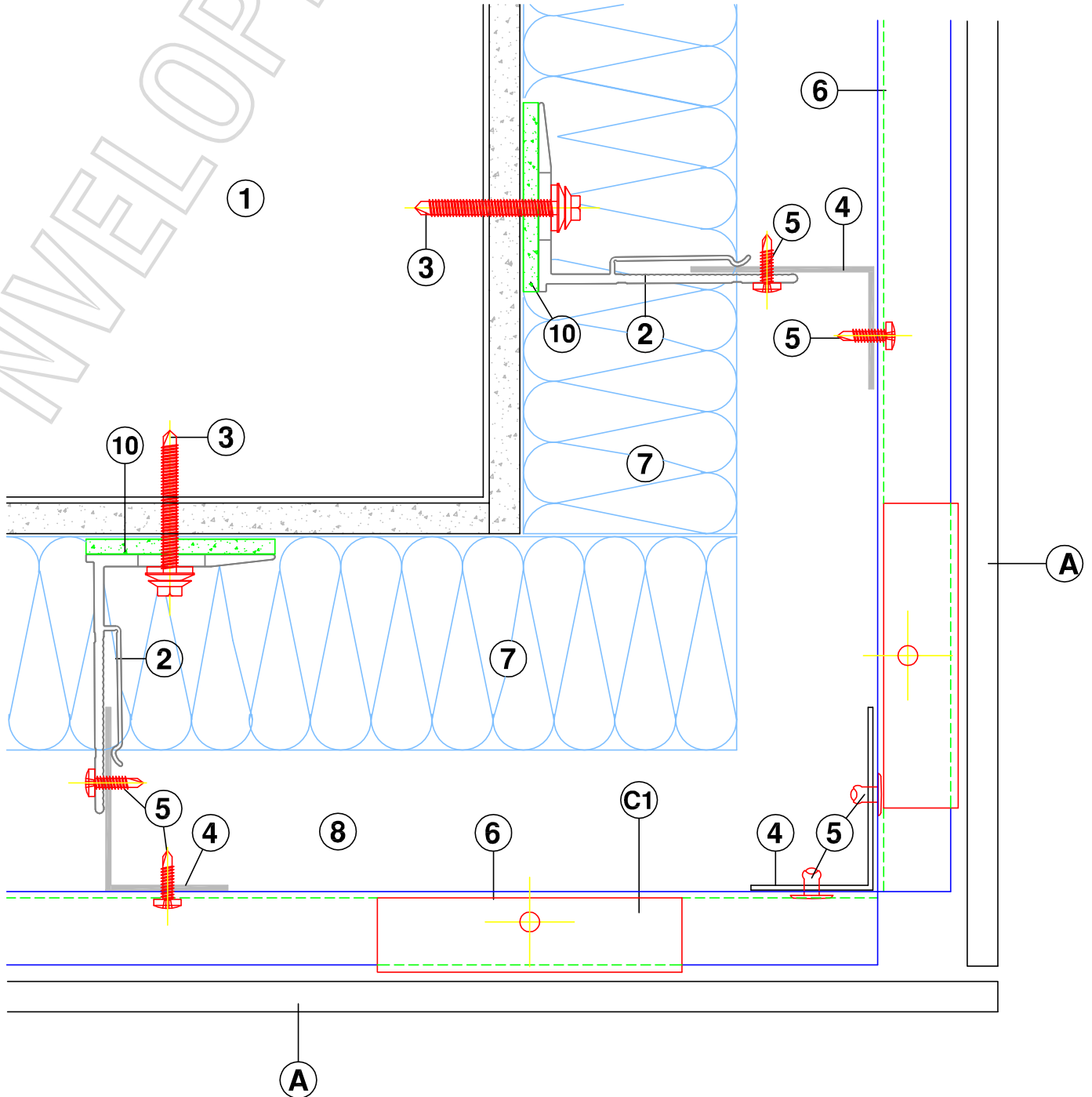

## HORIZONTAL SECTION - EXTERNAL CORNER

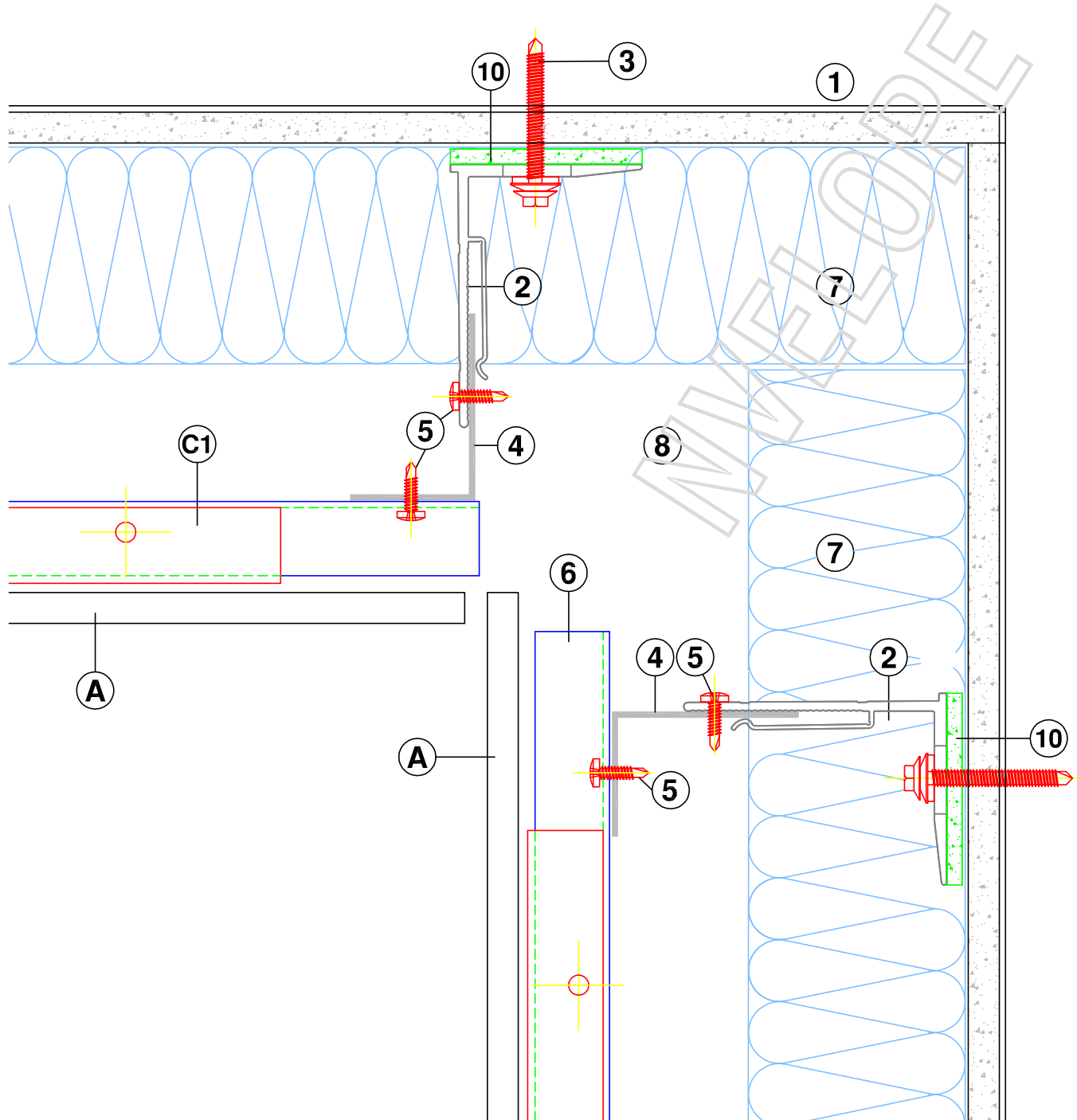

## HORIZONTAL SECTION - INTERNAL CORNER

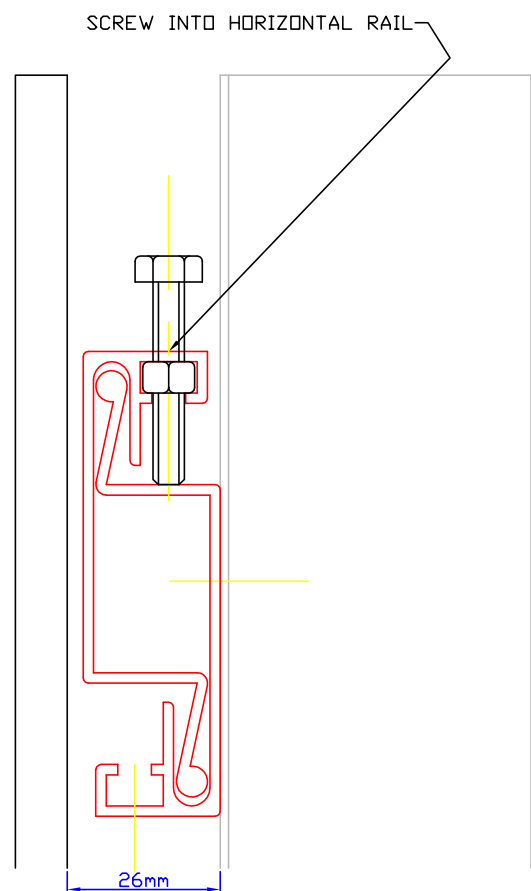
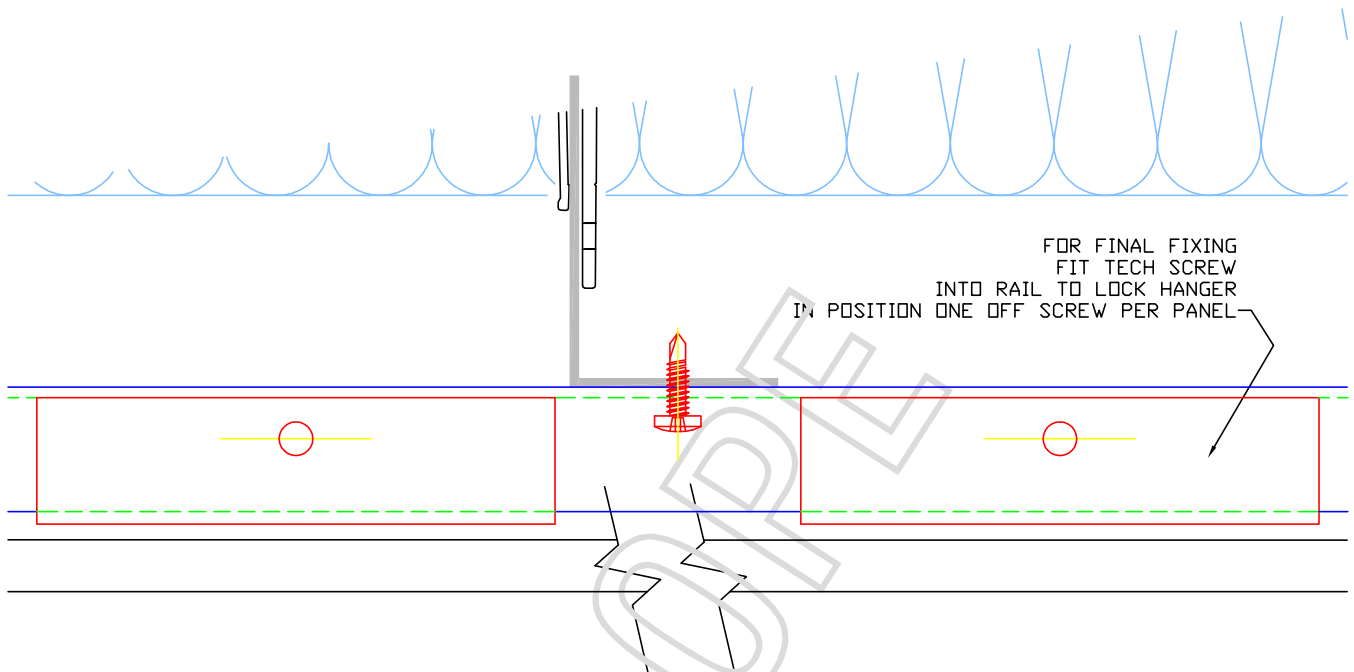

### FINAL FIXING SCREW



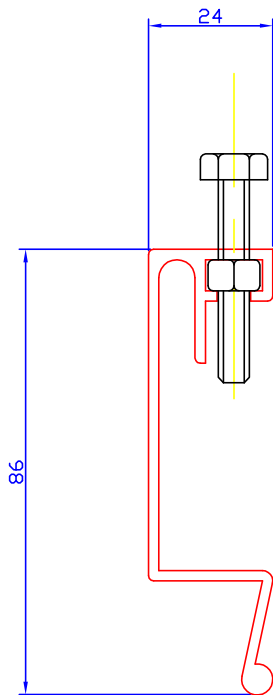

NV8 CLIP

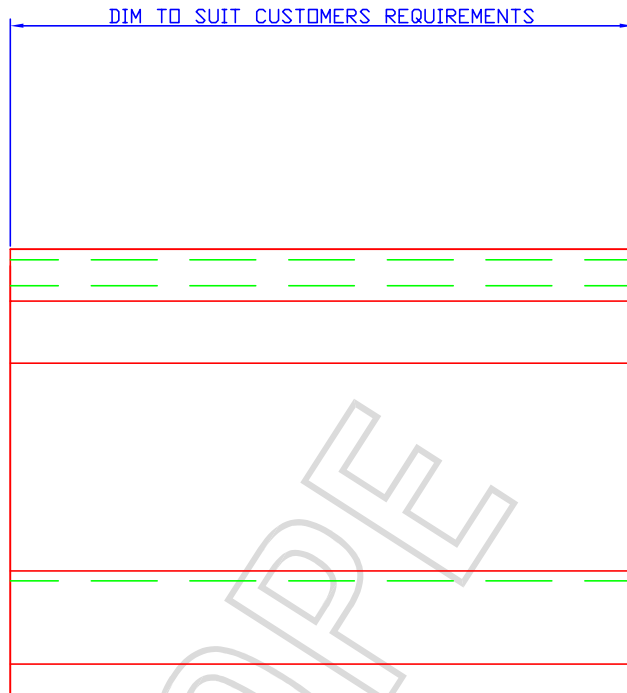

NV8 RAILS

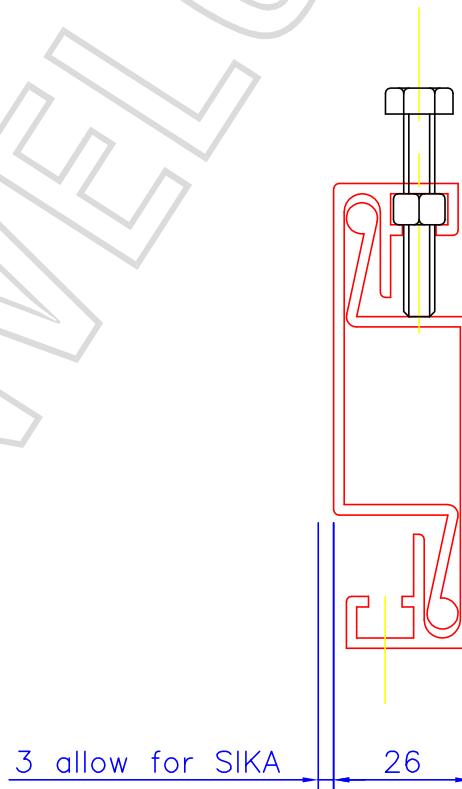

ASSEMBLY DIM

