

Facade System

Ventilated facade

EL-CB-MG

Elemental-Concrete Bracket-MSF GFRC

GFRC, Glass Fiber Reinforced Concrete

GFRC

Mechanical Secret Fix onto 2-layers

Metal substructure

Contents:

EL-CB-MG01	SYSTEM LAYOUT	EL-CB-MG21	WINDOW HEAD DETAIL - METAL FLASHING OPTION 2
EL-CB-MG02	BRACKET TYPES AVAILABLE	EL-CB-MG22	SOFFIT DETAIL
EL-CB-MG03	BASE DETAIL	EL-CB-MG23	WINDOW JAMB REVEAL - OPEN OPTION
EL-CB-MG04	HORIZONTAL JOINT DETAIL - OPEN OPTION	EL-CB-MG24	WINDOW JAMB REVEAL - CLOSED OPTION
EL-CB-MG05	RAIL SUPPORT AND HORIZONTAL PANEL JOINT	EL-CB-MG25	WINDOW JAMB REVEAL - METAL FLASHING OPTION
EL-CB-MG06	JOINT PROFILE DETAILS - CLOSED OPTIONS	EL-CB-MG26	WINDOW JAMB REVEAL - COMPLETE PIECE OPTION 1
EL-CB-MG07	GENERIC PARAPET DETAIL	EL-CB-MG27	WINDOW JAMB REVEAL - COMPLETE PIECE OPTION 2
EL-CB-MG08	GENERIC PARAPET DETAILS - OPTIONS	EL-CB-MG28	PANEL HANGERS
EL-CB-MG09	VERTICAL JOINT DETAIL - OPEN OPTION		
EL-CB-MG10	RAIL SUPPORT AND VERTICAL JOINT		
EL-CB-MG11	INTERMEDIATE PANEL SUPPORT DETAIL		
EL-CB-MG12	EXTERNAL CORNER - CLOSED JOINT OPTION		
EL-CB-MG13	EXTERNAL CORNER - OPEN JOINT OPTION		
EL-CB-MG14	EXTERNAL CORNER - PROFILE OPTION		
EL-CB-MG15	INTERNAL CORNER - OPEN JOINT OPTION		
EL-CB-MG16	GENERIC WINDOW CILL DETAIL		
EL-CB-MG17	GENERIC WINDOW CILL DETAIL - COMPLETE PIECE OPTION		
EL-CB-MG18	WINDOW HEAD DETAIL - OPEN JOINT OPTION		
EL-CB-MG19	WINDOW HEAD DETAIL - CLOSED JOINT OPTION		
EL-CB-MG20	WINDOW HEAD DETAIL - METAL FLASHING OPTION 1		

Image for illustration purposes

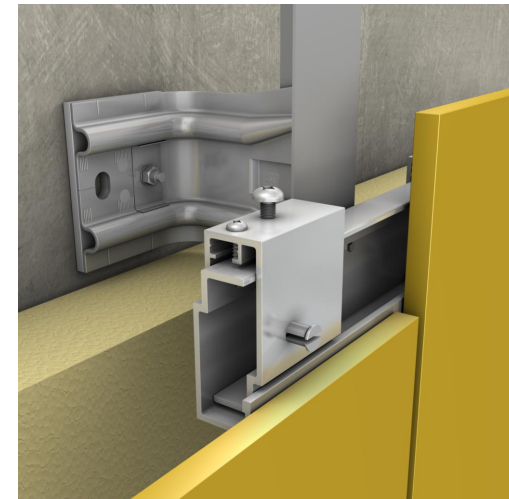

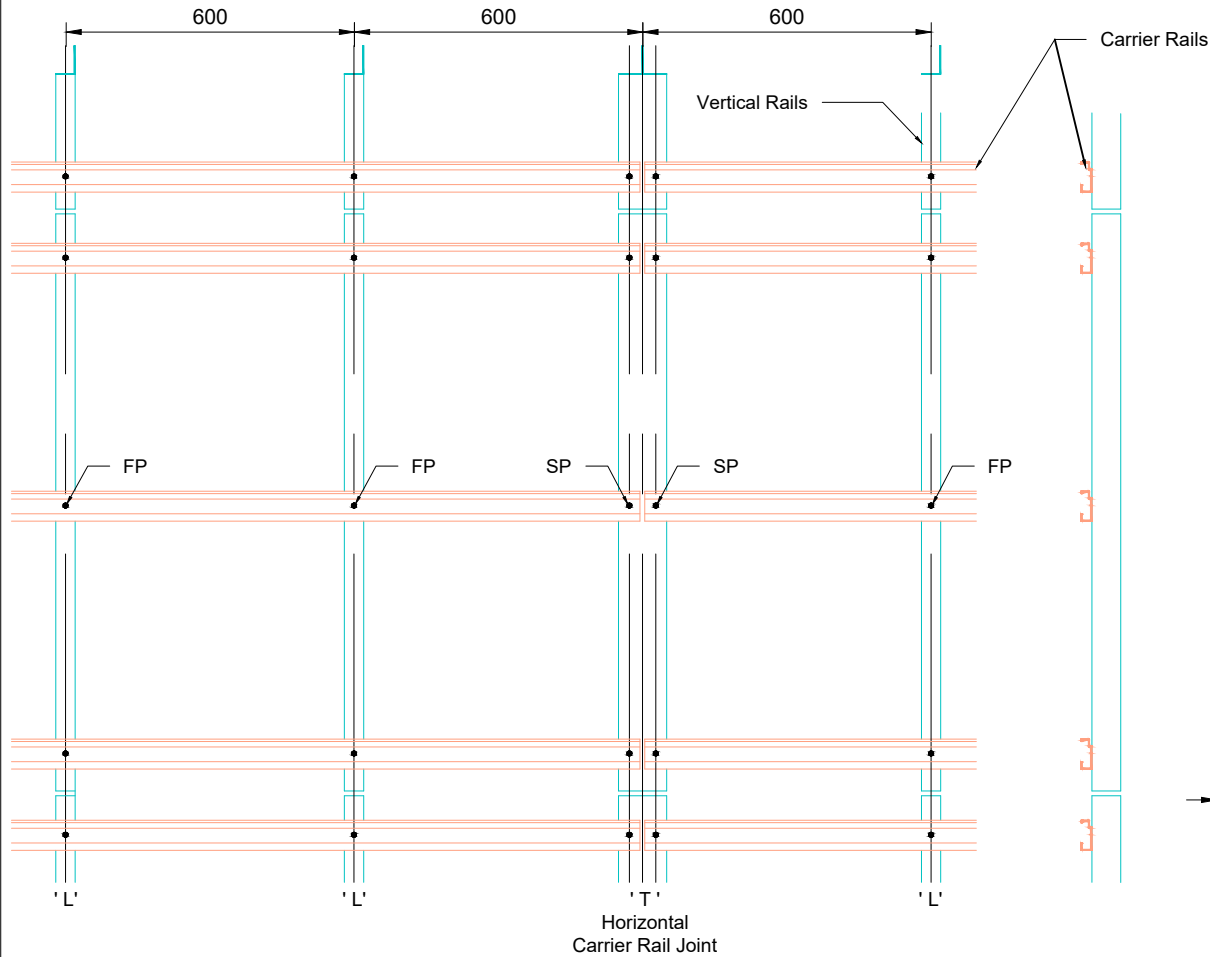

These drawings are indicative only, for use as a guide. The customer is always responsible for any specific design, structural calculations and calculating exact sizes & quantities of panels. Any project details and calculations supplied by Elemental Architectural Cladding Specialists are provided in good faith and should always be checked and approved by the project engineer responsible. Elemental Architectural Cladding Specialists will not accept any liability should the system be designed / installed incorrectly.

Rail Centres

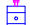

Fixing guidelines

-  Fixed Adjustable Hanger
-  Adjustable Hanger
-  Standard Hanger

Single Span

Multiple Span

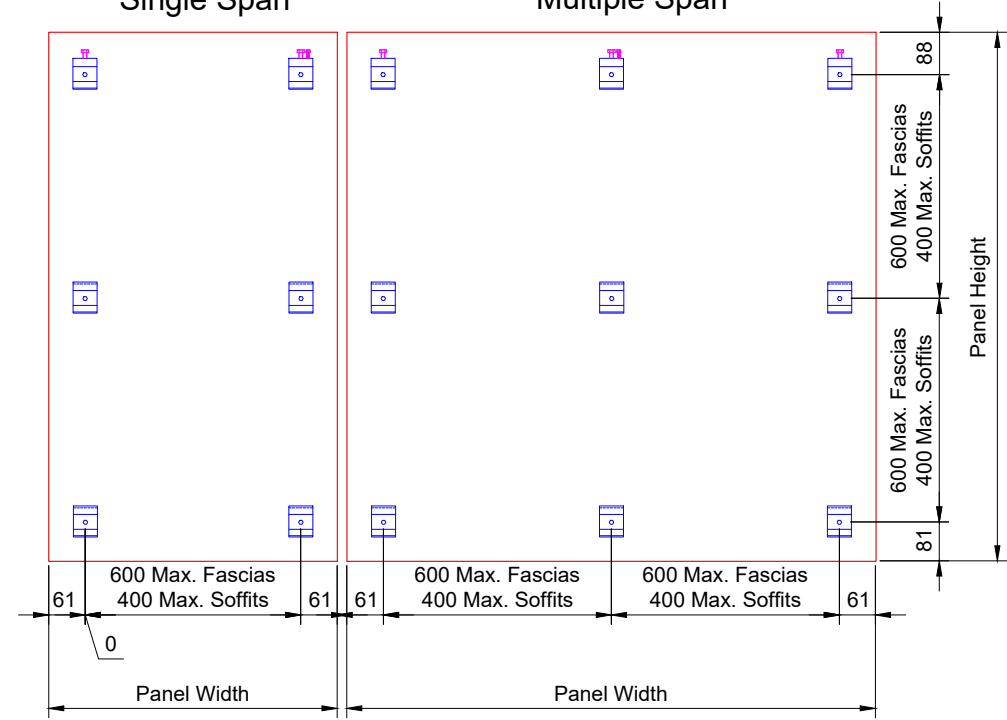

Panels Viewed from Rear

The fixing procedure for the horizontal carrier rail in max. 3m lengths is as follows:

- fixing HCR to L rail - all double fixed point (FP)
- fixing HCR ends to T rail - all double sliding point (SP) - HCR **only** drill holes 10mm



Elemental Architectural Cladding Specialists
 #29 The Cubes Offices, Beacon South Quarter,
 Sandyford
 Dublin 18, D18 A264
 Phone: +353 (0)1 293 8951
 Email: info@elemental.ie

Drawing Title

**ELEMENTAL GFRC - MSF
 SYSTEM LAYOUT**

Drawing No.

EL-CB-MG01

System:

**EL-MSF
 GFRC**

Size:

A4

Scale:

NTS

Drawn:

V.C.

Rev.

01

BRACKET TYPES AVAILABLE FROM ELEMENTAL

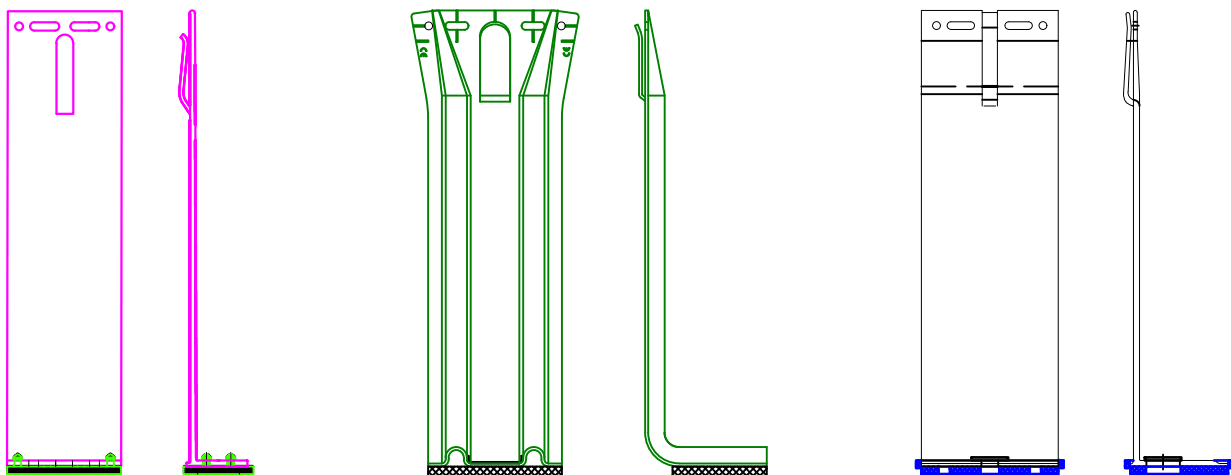

SPIDI MAX BRACKETS LENGTH

TOLERANCE COMPENSATION

SLIDING POINT

FIXED POINT

SPIDI-max wall bracket			SPIDI-max wall bracket		
description	length L		description	length L	
SPIDI max 65/80	65		SPIDI max 480/80	480	
SPIDI max 85/80	85		SPIDI max 510/80	510	
SPIDI max 110/80	110		SPIDI max 540/80	540	
SPIDI max 135/80	135		SPIDI max 570/80	570	
SPIDI max 160/80	160		SPIDI max 600/80	600	
SPIDI max 170/80	170		SPIDI max 630/80	630	
SPIDI max 185/80	185		SPIDI max 660/80	660	
SPIDI max 210/80	210		SPIDI max 690/80	690	
SPIDI max 240/80	240		SPIDI max 720/80	720	
SPIDI max 270/80	270		SPIDI max 750/80	750	
SPIDI max 300/80	300		SPIDI max 780/80	780	
SPIDI max 330/80	330		SPIDI max 810/80	810	
SPIDI max 360/80	360		SPIDI max 840/80	840	
SPIDI max 390/80	390		SPIDI max 870/80	870	
SPIDI max 420/80	420		SPIDI max 900/80	900	
SPIDI max 450/80	450		special length	on request	



Elemental Architectural Cladding Specialists
 #29 The Cubes Offices, Beacon South Quarter,
 Sandyford
 Dublin 18, D18 A264
 Phone: +353 (0)1 293 8951
 Email: info@elemental.ie

Drawing Title

BRACKET TYPES AVAILABLE

Drawing No.

EL-CB-MG02

System:

**EL-MSF
GFRC**

Size:

A4

Scale:

NTS

Drawn:

V.C.

Rev.

01

These drawings are indicative only, for use as a guide. The customer is always responsible for any specific design, structural calculations and calculating exact sizes & quantities of panels. Any project details and calculations supplied by Elemental Architectural Cladding Specialists are provided in good faith and should always be checked and approved by the project engineer responsible. Elemental Architectural Cladding Specialists will not accept any liability should the system be designed / installed incorrectly.

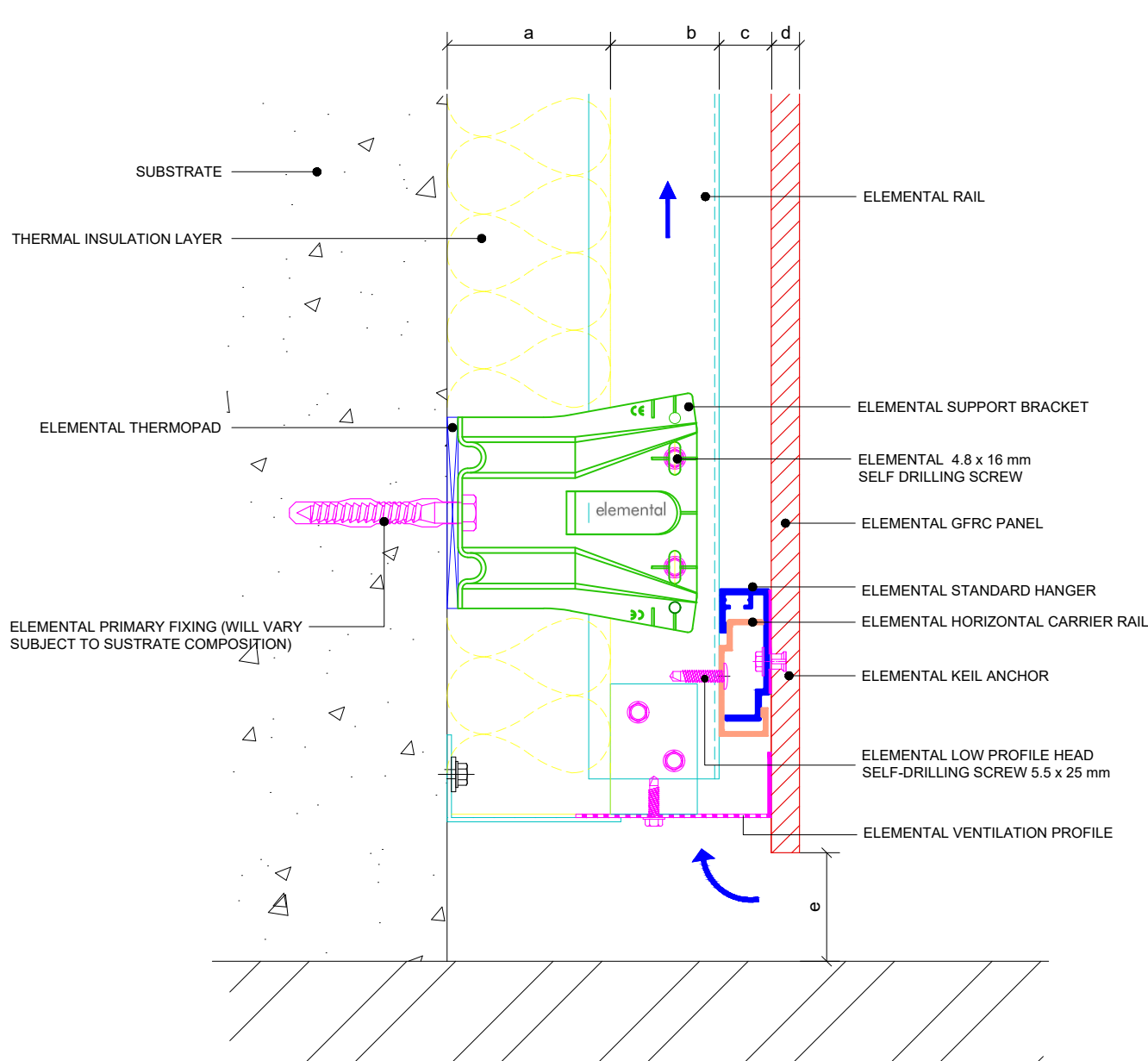

Dimensions	
a	Insulation thickness (varies)
b	Free vertical ventilation gap
c	Horizontal Carrier rail and Panel Hanger
d	Panel nominal thickness
e	Distance min. 50mm
a+b+c	Clad Zone



Elemental Architectural Cladding Specialists
 #29 The Cubes Offices, Beacon South Quarter,
 Sandyford
 Dublin 18, D18 A264
 Phone: +353 (0)1 293 8951
 Email: info@elemental.ie

Drawing Title

**ELEMENTAL GFRF - MSF
 BASE DETAIL**

Drawing No.

EL-CB-MG03

System:

**EL-MSF
 GFRF**

Size:

A4

Scale:

NTS

Drawn:

V.C.

Rev.

01

Elemental Architectural Cladding Specialists reserve the right to amend details at any time without prior notice. Reproduction or disclosure to third parties is strictly prohibited and can only be attained through signed, written consent from Elemental ACS.

These drawings are indicative only, for use as a guide. The customer is always responsible for any specific design, structural calculations and calculating exact sizes & quantities of panels. Any project details and calculations supplied by Elemental Architectural Cladding Specialists are provided in good faith and should always be checked and approved by the project engineer responsible. Elemental Architectural Cladding Specialists will not accept any liability should the system be designed / installed incorrectly.

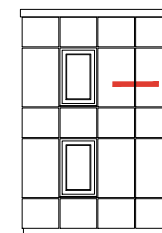
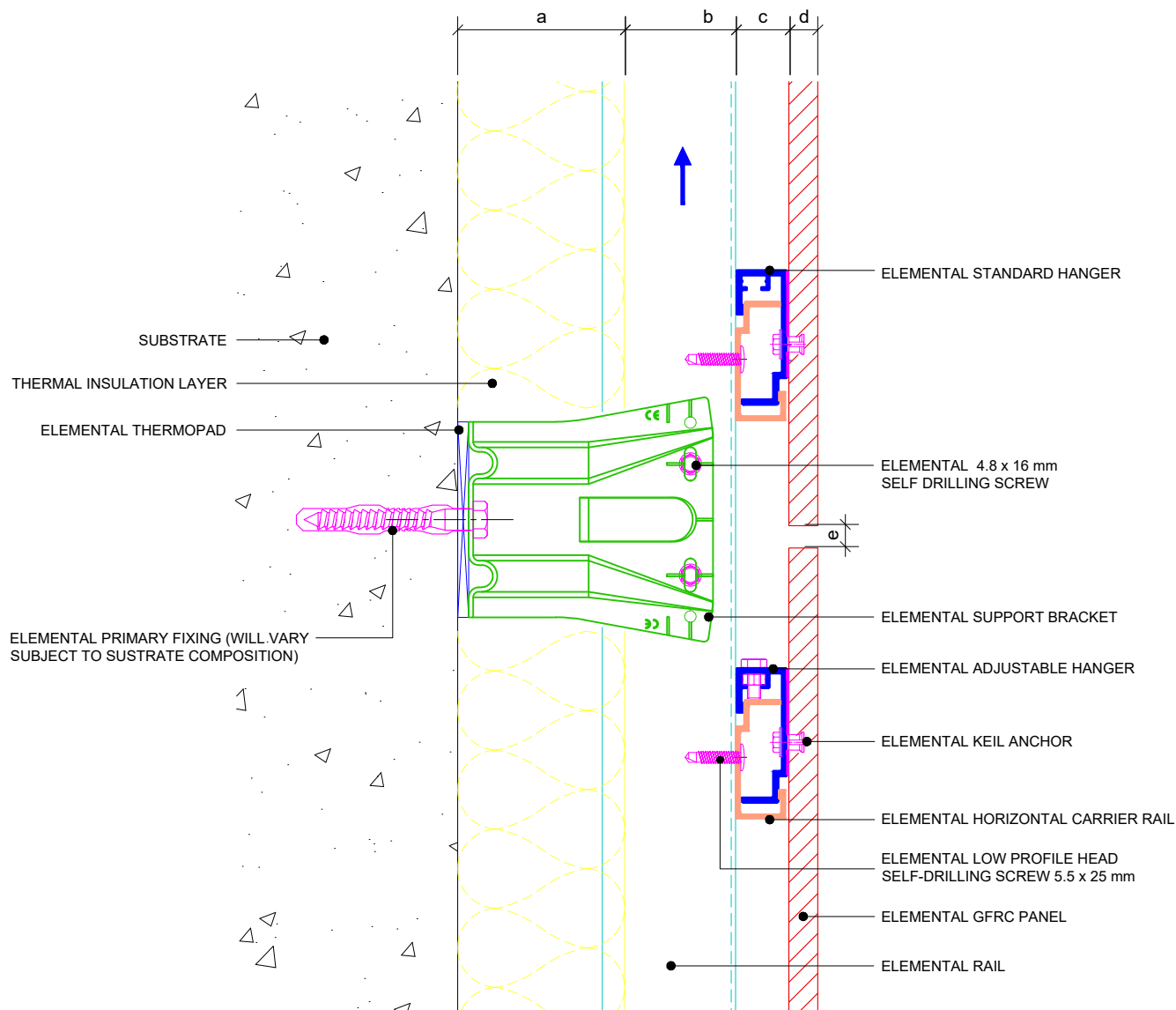

Dimensions	
a	Insulation thickness (varies)
b	Free vertical ventilation gap
c	Horizontal Carrier rail and Panel Hanger
d	Panel nominal thickness
e	Panel joint - min 10mm
a+b+c	Clad Zone



Elemental Architectural Cladding Specialists
 #29 The Cubes Offices, Beacon South Quarter,
 Sandyford
 Dublin 18, D18 A264
 Phone: +353 (0)1 293 8951
 Email: info@elemental.ie

Drawing Title

**ELEMENTAL GFRP - MSF
 HORIZONTAL JOINT DETAIL OPEN OPTION**

Drawing No.

EL-CB-MG04

System:

**EL-MSF
 GFRP**

Size:

A4

Scale:

NTS

Drawn:

V.C.

Rev.

01

These drawings are indicative only, for use as a guide. The customer is always responsible for any specific design, structural calculations and calculating exact sizes & quantities of panels. Any project details and calculations supplied by Elemental Architectural Cladding Specialists are provided in good faith and should always be checked and approved by the project engineer responsible. Elemental Architectural Cladding Specialists will not accept any liability should the system be designed / installed incorrectly.

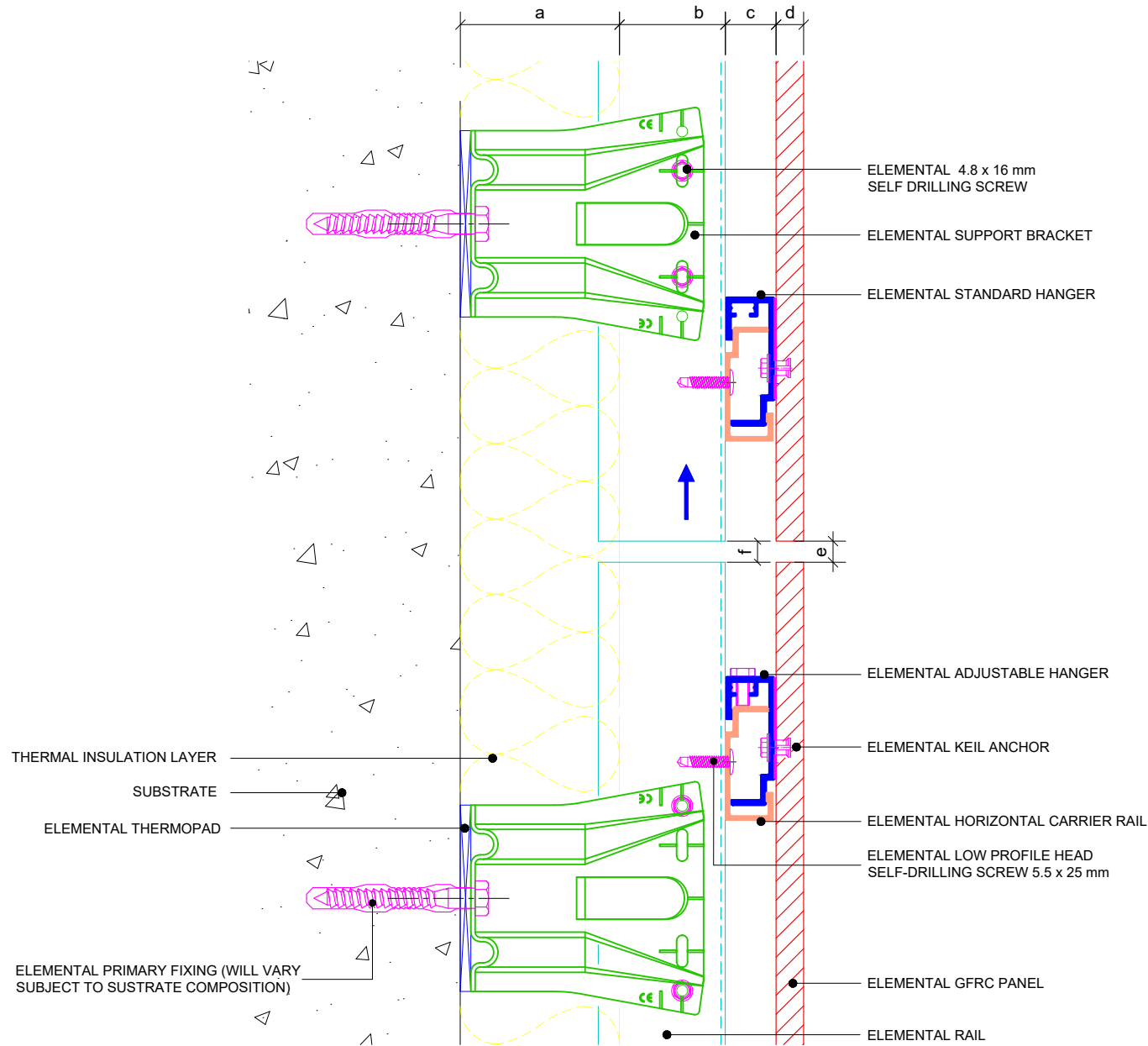

Dimensions	
a	Insulation thickness (varies)
b	Free vertical ventilation gap
c	Horizontal Carrier rail and Panel Hanger
d	Panel nominal thickness
e	Panel joint - min 10mm
f	Rail joint - Min 10mm
a+b+c	Clad Zone

Elemental Architectural Cladding Specialists
 #29 The Cubes Offices, Beacon South Quarter,
 Sandyford
 Dublin 18, D18 A264
 Phone: +353 (0)1 293 8951
 Email: info@elemental.ie

Drawing Title	ELEMENTAL GFRC - MSF - RAIL SUPPORT AND HORIZONTAL PANEL JOINT DETAIL										
Drawing No.	EL-CB-MG05	System:	EL-MSF GFRC	Size:	A4	Scale:	NTS	Drawn:	V.C.	Rev.	01

Elemental Architectural Cladding Specialists reserve the right to amend details at any time without prior notice. Reproduction or disclosure to third parties is strictly prohibited and can only be attained through signed, written consent from Elemental ACS.

These drawings are indicative only, for use as a guide. The customer is always responsible for any specific design, structural calculations and calculating exact sizes & quantities of panels. Any project details and calculations supplied by Elemental Architectural Cladding Specialists are provided in good faith and should always be checked and approved by the project engineer responsible. Elemental Architectural Cladding Specialists will not accept any liability should the system be designed / installed incorrectly.

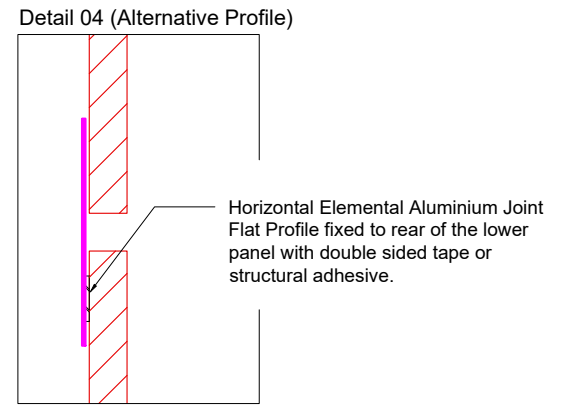
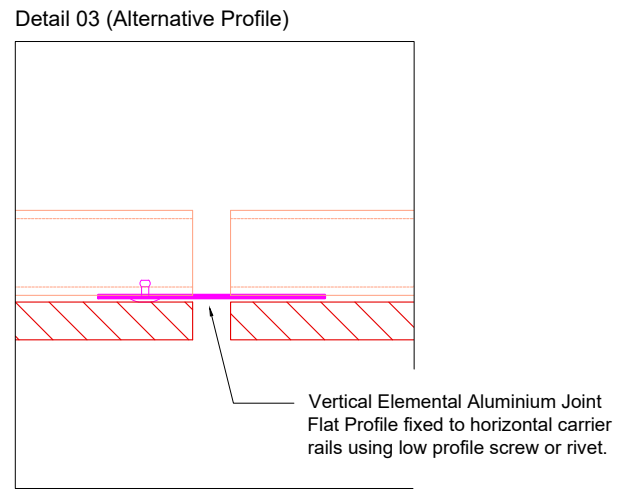
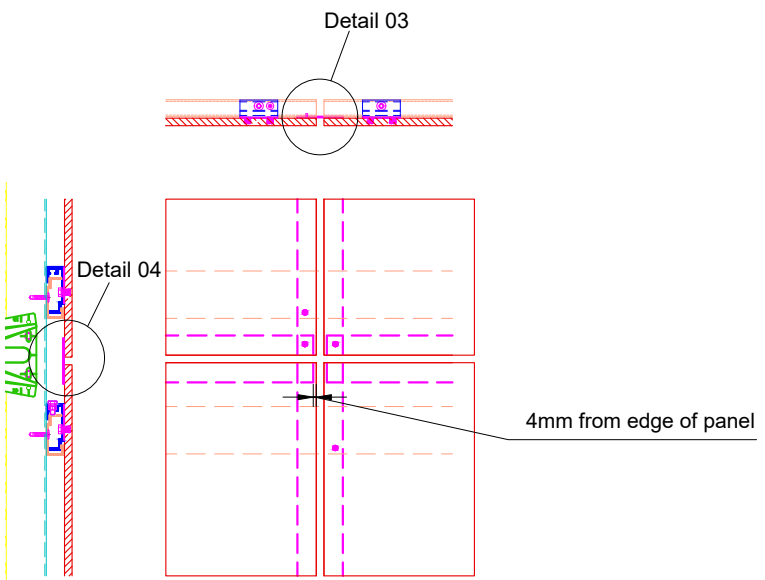
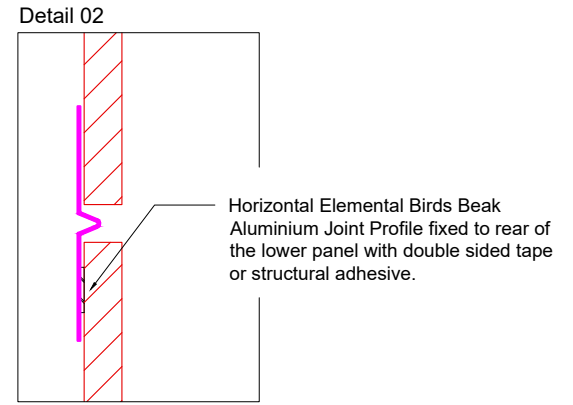
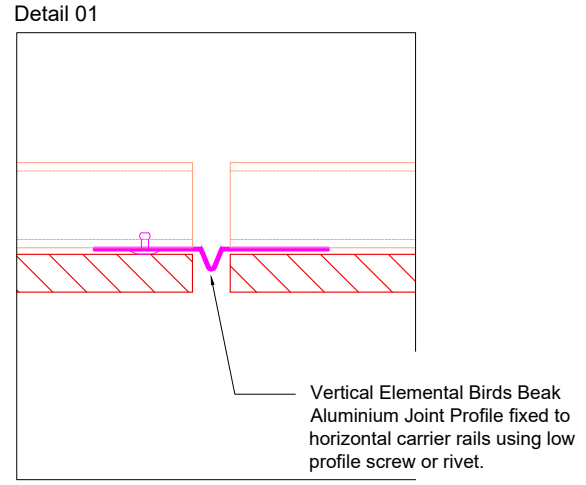
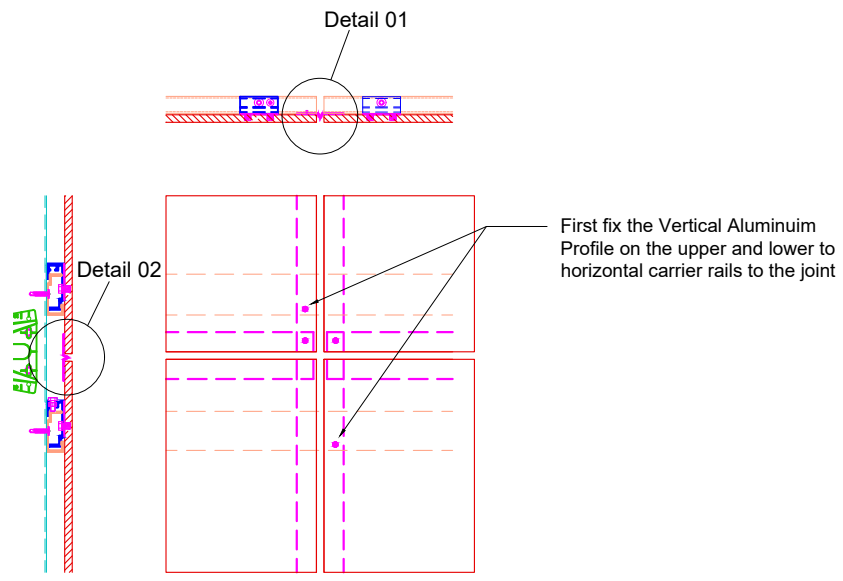

Elemental Architectural Cladding Specialists
 #29 The Cubes Offices, Beacon South Quarter,
 Sandyford
 Dublin 18, D18 A264
 Phone: +353 (0)1 293 8951
 Email: info@elemental.ie

Drawing Title	ELEMENTAL PETRARCH - MSF JOINT PROFILE DETAILS - CLOSED OPTIONS										
Drawing No.	EL-CB-MG06	System:	EL-MSF GFRC	Size:	A4	Scale:	NTS	Drawn:	V.C.	Rev.	01

Elemental Architectural Cladding Specialists reserve the right to amend details at any time without prior notice. Reproduction or disclosure to third parties is strictly prohibited and can only be attained through signed, written consent from Elemental ACS.

These drawings are indicative only, for use as a guide. The customer is always responsible for any specific design, structural calculations and calculating exact sizes & quantities of panels. Any project details and calculations supplied by Elemental Architectural Cladding Specialists are provided in good faith and should always be checked and approved by the project engineer responsible. Elemental Architectural Cladding Specialists will not accept any liability should the system be designed / installed incorrectly.

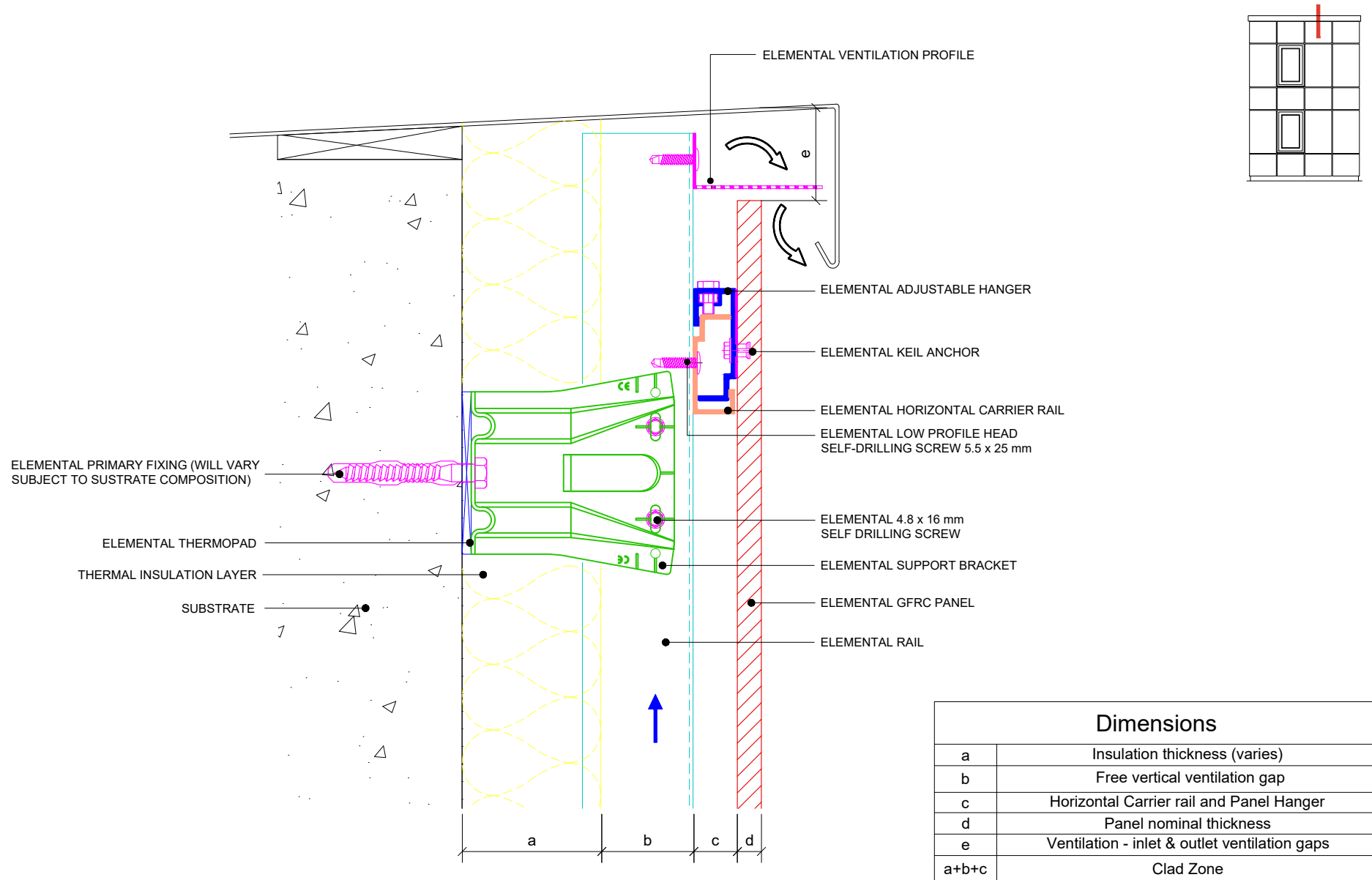

Dimensions	
a	Insulation thickness (varies)
b	Free vertical ventilation gap
c	Horizontal Carrier rail and Panel Hanger
d	Panel nominal thickness
e	Ventilation - inlet & outlet ventilation gaps
a+b+c	Clad Zone



Elemental Architectural Cladding Specialists
 #29 The Cubes Offices, Beacon South Quarter,
 Sandyford
 Dublin 18, D18 A264
 Phone: +353 (0)1 293 8951
 Email: info@elemental.ie

Drawing Title

**ELEMENTAL GFRP - MSF
 GENERIC PARAPET DETAIL**

Drawing No.

EL-CB-MG07

System:

**EL-MSF
 GFRP**

Size:

A4

Scale:

NTS

Drawn:

V.C.

Rev.

01

These drawings are indicative only, for use as a guide. The customer is always responsible for any specific design, structural calculations and calculating exact sizes & quantities of panels. Any project details and calculations supplied by Elemental Architectural Cladding Specialists are provided in good faith and should always be checked and approved by the project engineer responsible. Elemental Architectural Cladding Specialists will not accept any liability should the system be designed / installed incorrectly.

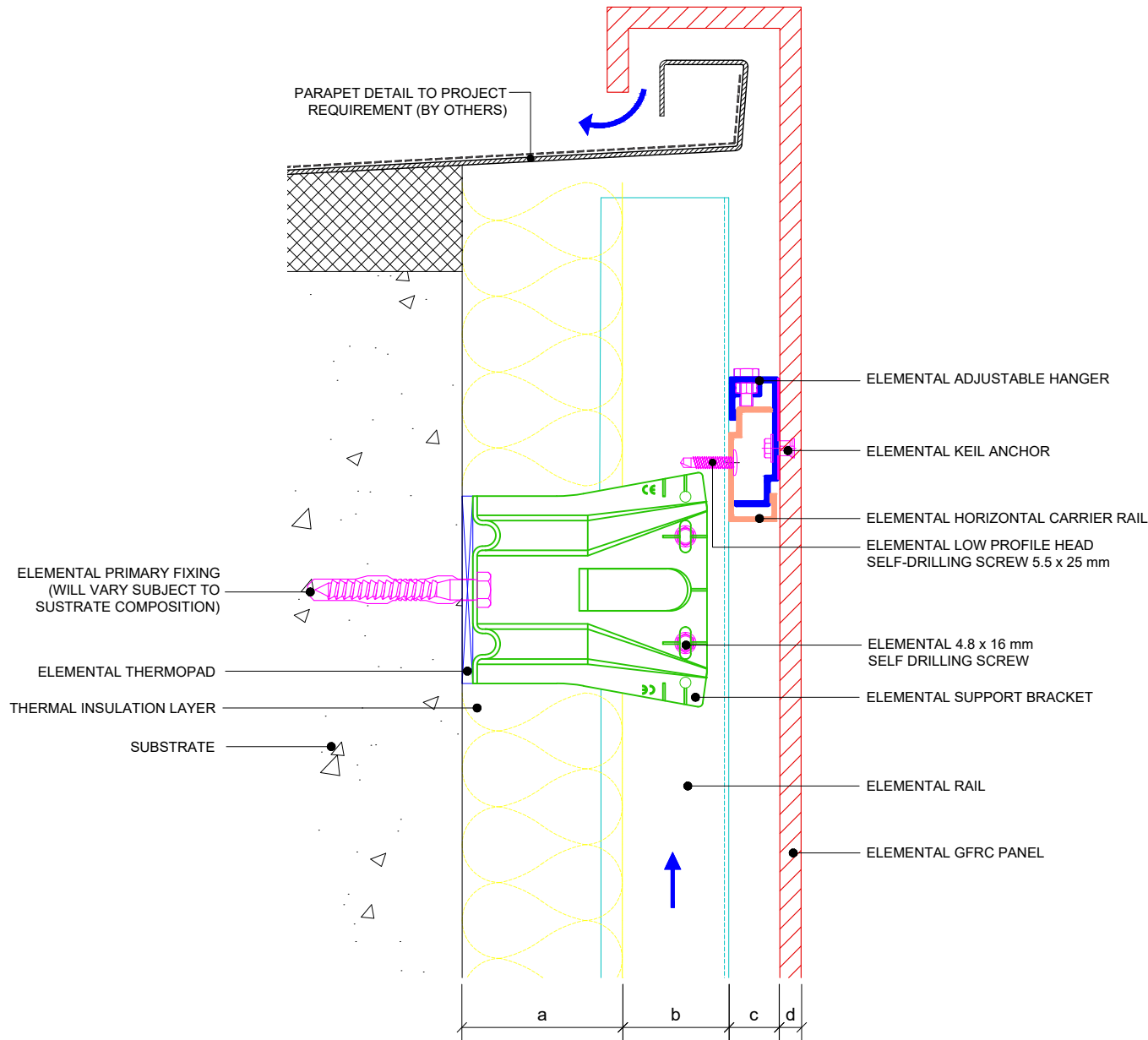

PARAPET OPTION

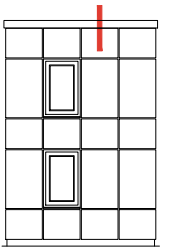
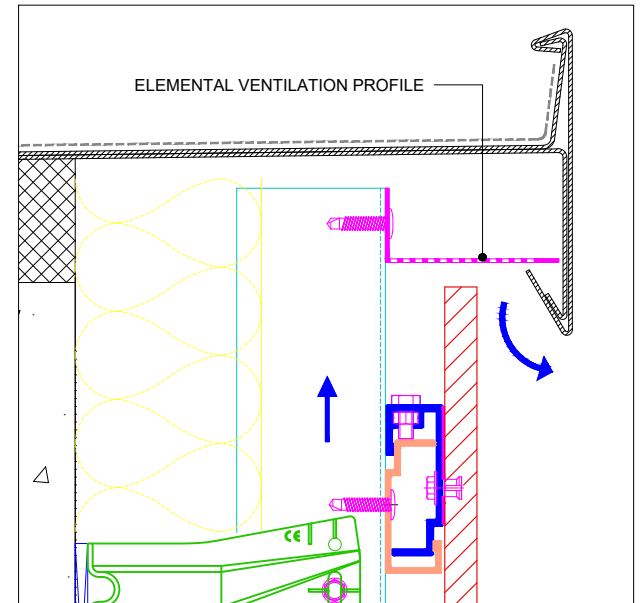

Dimensions

a	Insulation thickness (varies)
b	Free vertical ventilation gap
c	Horizontal Carrier rail and Panel Hanger
d	Panel nominal thickness
e	Ventilation - inlet & outlet ventilation gaps
a+b+c	Clad Zone



Elemental Architectural Cladding Specialists
 #29 The Cubes Offices, Beacon South Quarter,
 Sandyford
 Dublin 18, D18 A264
 Phone: +353 (0)1 293 8951
 Email: info@elemental.ie

Drawing Title

**ELEMENTAL GFR - MSF
 PARAPET DETAILS OPTIONS**

Drawing No.

EL-CB-MG08

System:

**EL-MSF
 GFR**

Size:

A4

Scale:

NTS

Drawn:

V.C.

Rev.

01

These drawings are indicative only, for use as a guide. The customer is always responsible for any specific design, structural calculations and calculating exact sizes & quantities of panels. Any project details and calculations supplied by Elemental Architectural Cladding Specialists are provided in good faith and should always be checked and approved by the project engineer responsible. Elemental Architectural Cladding Specialists will not accept any liability should the system be designed / installed incorrectly.

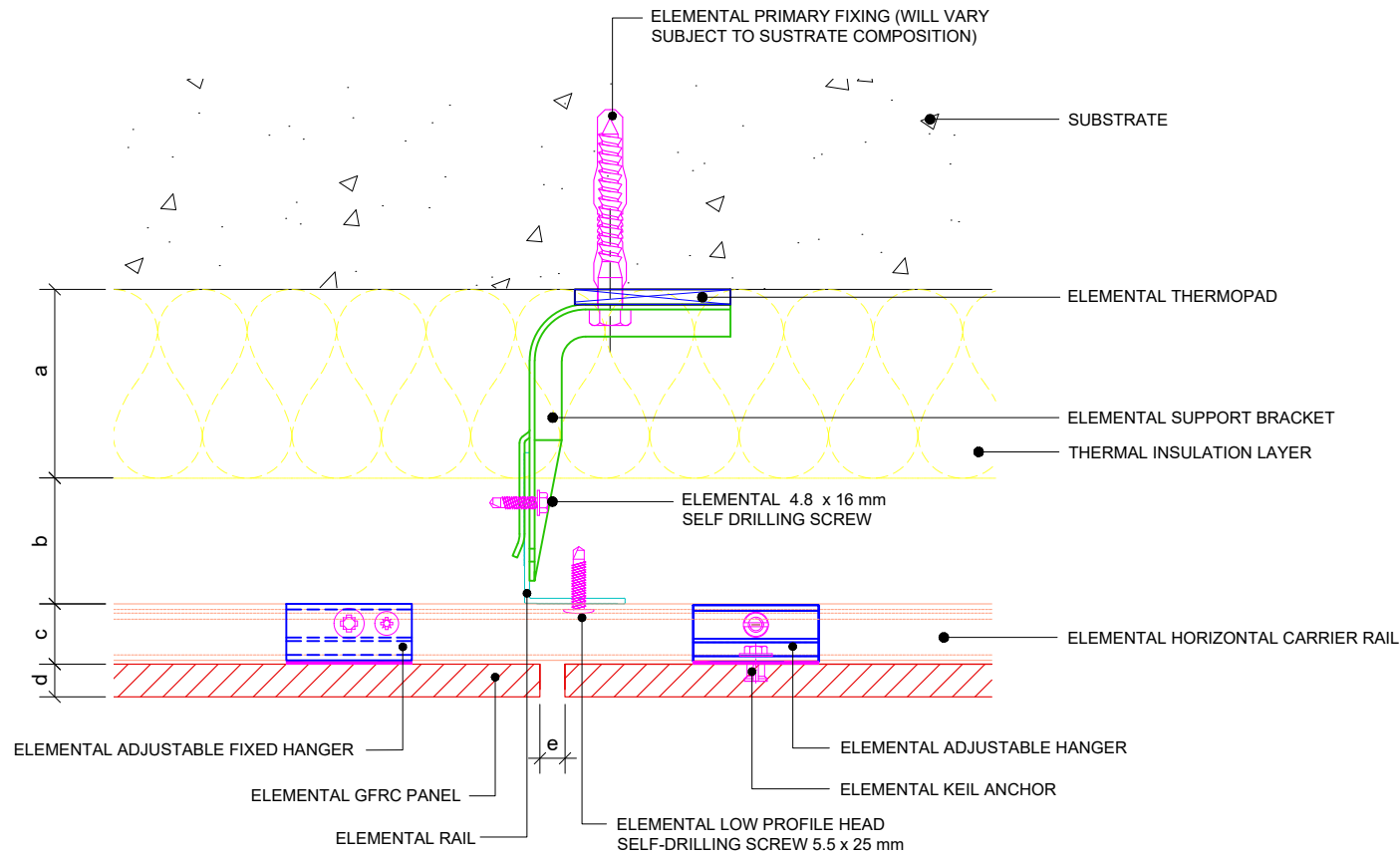

Dimensions	
a	Insulation thickness (varies)
b	Free vertical ventilation gap
c	Horizontal Carrier rail and Panel Hanger
d	Panel nominal thickness
e	Panel joint - min 10mm
a+b+c	Clad Zone



Elemental Architectural Cladding Specialists
 #29 The Cubes Offices, Beacon South Quarter,
 Sandyford
 Dublin 18, D18 A264
 Phone: +353 (0)1 293 8951
 Email: info@elemental.ie

Drawing Title

**ELEMENTAL GFRP - MSF
 VERTICAL JOINT DETAIL - OPEN OPTION**

Drawing No.

EL-CB-MG09

System:

**EL-MSF
 GFRP**

Size:

A4

Scale:

NTS

Drawn:

V.C.

Rev.

01

Elemental Architectural Cladding Specialists reserve the right to amend details at any time without prior notice. Reproduction or disclosure to third parties is strictly prohibited and can only be attained through signed, written consent from Elemental ACS.

These drawings are indicative only, for use as a guide. The customer is always responsible for any specific design, structural calculations and calculating exact sizes & quantities of panels. Any project details and calculations supplied by Elemental Architectural Cladding Specialists are provided in good faith and should always be checked and approved by the project engineer responsible. Elemental Architectural Cladding Specialists will not accept any liability should the system be designed / installed incorrectly.

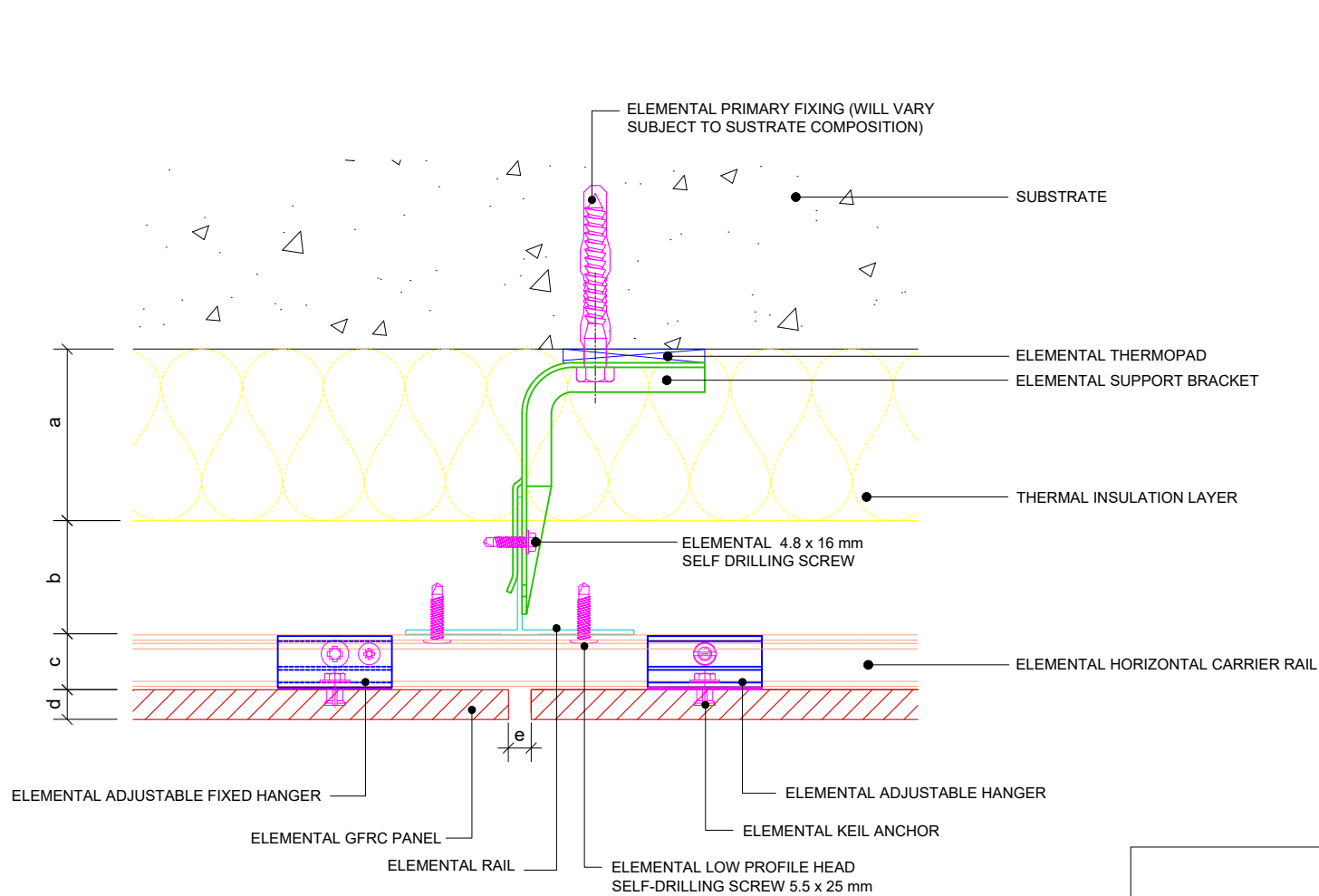

Dimensions	
a	Insulation thickness (varies)
b	Free vertical ventilation gap
c	Horizontal Carrier rail and Panel Hanger
d	Panel nominal thickness
e	Panel joint - min 10mm
a+b+c	Clad Zone



Elemental Architectural Cladding Specialists
 #29 The Cubes Offices, Beacon South Quarter,
 Sandyford
 Dublin 18, D18 A264
 Phone: +353 (0)1 293 8951
 Email: info@elemental.ie

Drawing Title

**ELEMENTAL GFRG - MSF
 RAIL SUPPORT AND VERTICAL JOINT DETAIL**

Drawing No.

EL-CB-MG10

System:

**EL-MSF
 GFRG**

Size:

A4

Scale:

NTS

Drawn:

V.C.

Rev.

01

These drawings are indicative only, for use as a guide. The customer is always responsible for any specific design, structural calculations and calculating exact sizes & quantities of panels. Any project details and calculations supplied by Elemental Architectural Cladding Specialists are provided in good faith and should always be checked and approved by the project engineer responsible. Elemental Architectural Cladding Specialists will not accept any liability should the system be designed / installed incorrectly.

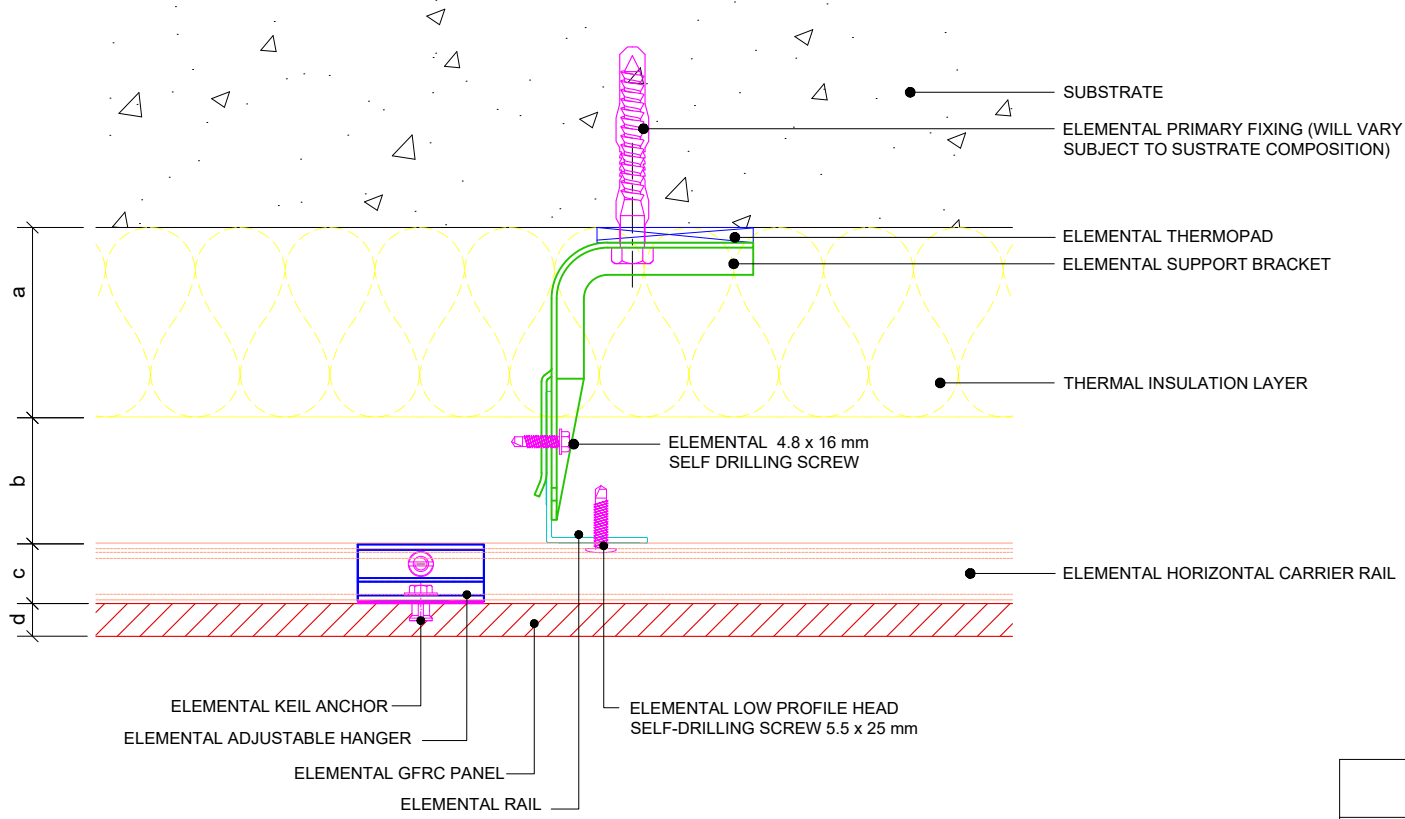
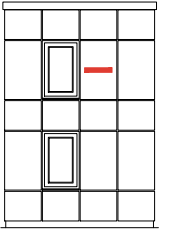

Dimensions	
a	Insulation thickness (varies)
b	Free vertical ventilation gap
c	Horizontal Carrier rail and Panel Hanger
d	Panel nominal thickness
a+b+c	Clad Zone



Elemental Architectural Cladding Specialists
 #29 The Cubes Offices, Beacon South Quarter,
 Sandyford
 Dublin 18, D18 A264
 Phone: +353 (0)1 293 8951
 Email: info@elemental.ie

Drawing Title	ELEMENTAL GFRc - MSF - INTERMEDIATE PANEL SUPPORT DETAIL										
Drawing No.	EL-CB-MG11	System:	EL-MSF GFRc	Size:	A4	Scale:	NTS	Drawn:	V.C.	Rev.	01

Elemental Architectural Cladding Specialists reserve the right to amend details at any time without prior notice. Reproduction or disclosure to third parties is strictly prohibited and can only be attained through signed, written consent from Elemental ACS.

These drawings are indicative only, for use as a guide. The customer is always responsible for any specific design, structural calculations and calculating exact sizes & quantities of panels. Any project details and calculations supplied by Elemental Architectural Cladding Specialists are provided in good faith and should always be checked and approved by the project engineer responsible. Elemental Architectural Cladding Specialists will not accept any liability should the system be designed / installed incorrectly.

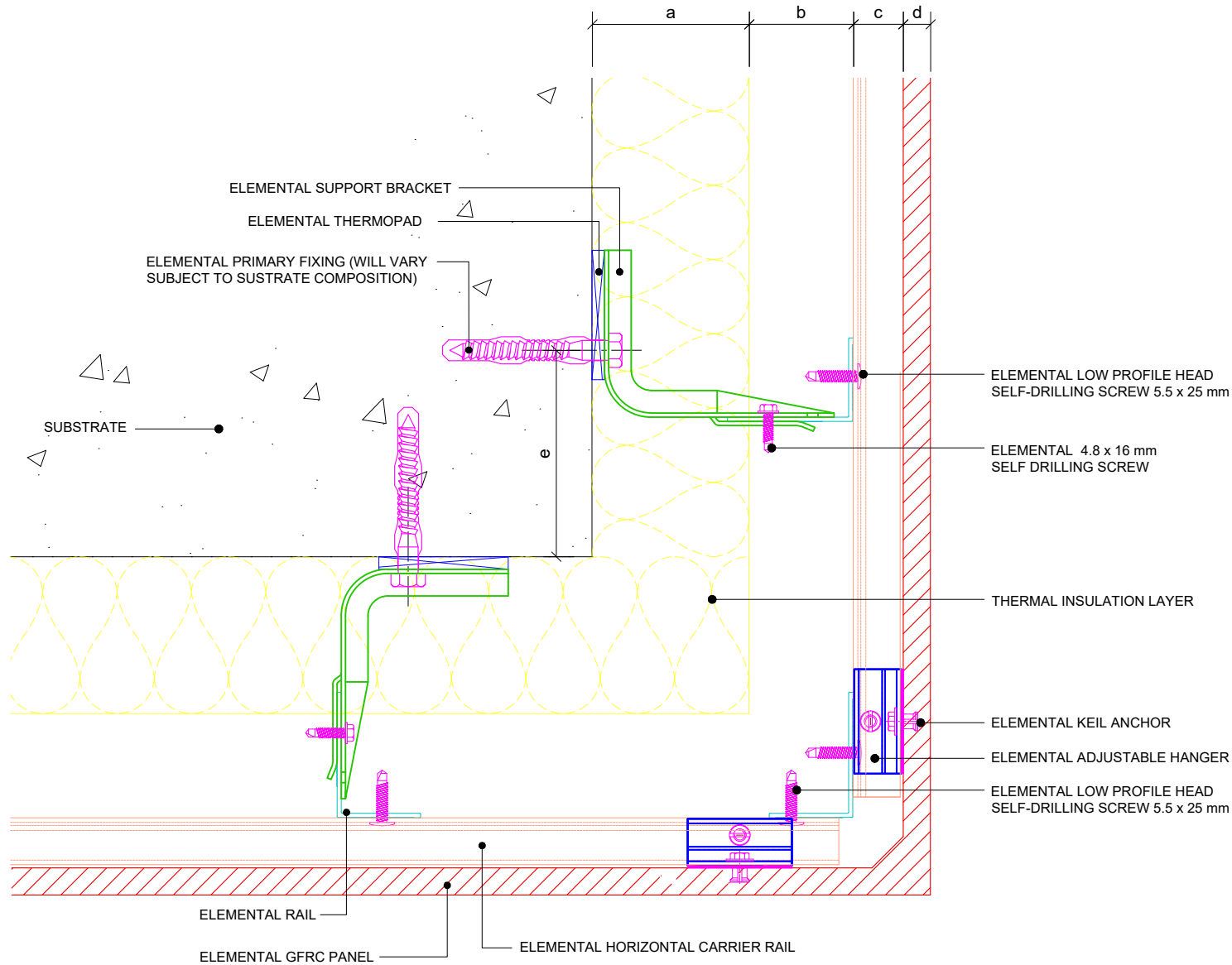

Dimensions	
a	Insulation thickness (varies)
b	Free vertical ventilation gap
c	Horizontal Carrier rail and Panel Hanger
d	Panel nominal thickness
e	Min. recommended 100mm
a+b+c	Clad Zone



Elemental Architectural Cladding Specialists
 #29 The Cubes Offices, Beacon South Quarter,
 Sandyford
 Dublin 18, D18 A264
 Phone: +353 (0)1 293 8951
 Email: info@elemental.ie

Drawing Title

**ELEMENTAL GFRG - MSF
 EXTERNAL CORNER - CLOSED JOINT OPTION**

Drawing No.

EL-CB-MG12

System:

**EL-MSF
 GFRG**

Size:

A4

Scale:

NTS

Drawn:

V.C.

Rev.

01

These drawings are indicative only, for use as a guide. The customer is always responsible for any specific design, structural calculations and calculating exact sizes & quantities of panels. Any project details and calculations supplied by Elemental Architectural Cladding Specialists are provided in good faith and should always be checked and approved by the project engineer responsible. Elemental Architectural Cladding Specialists will not accept any liability should the system be designed / installed incorrectly.

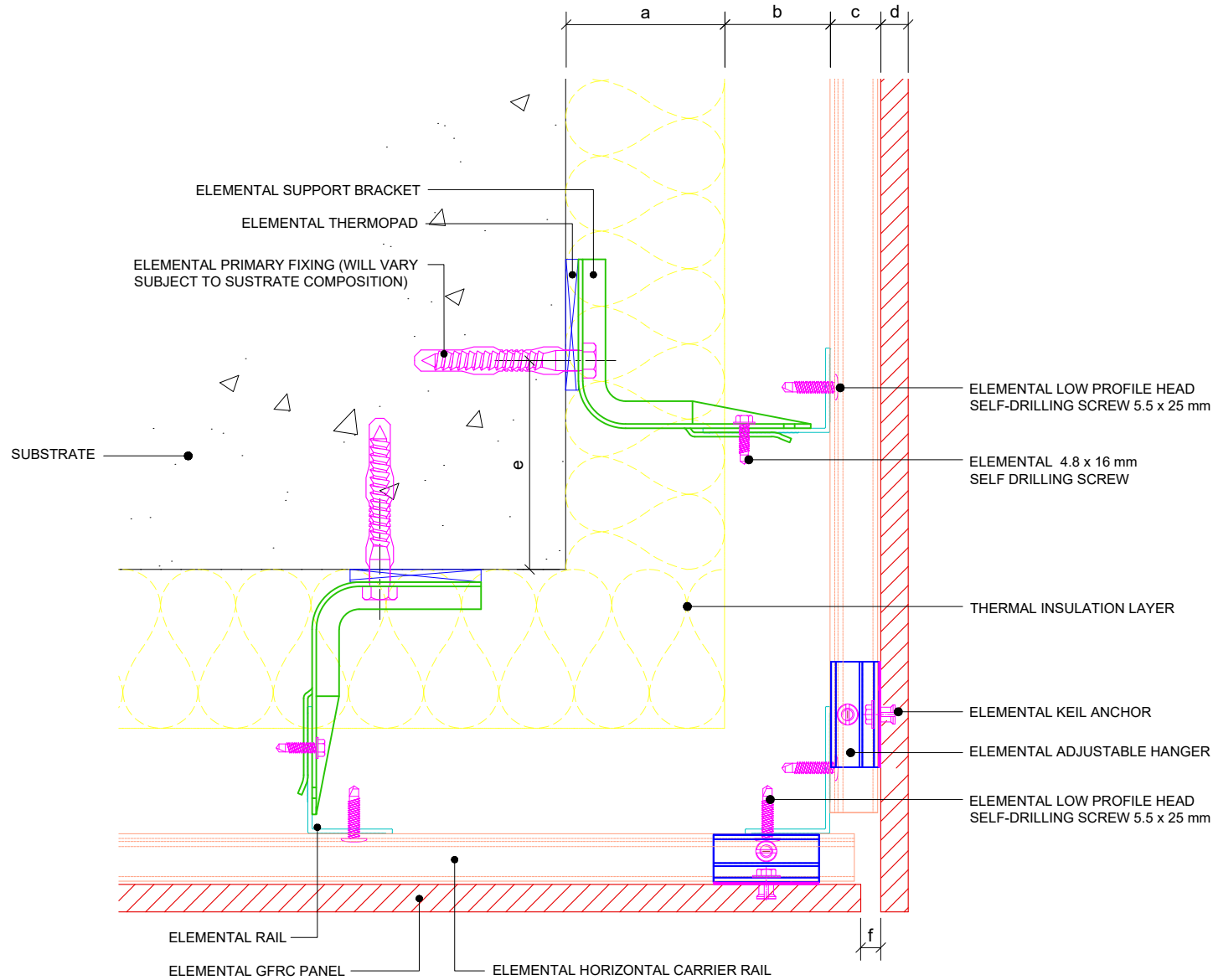

Dimensions	
a	Insulation thickness (varies)
b	Free vertical ventilation gap
c	Horizontal Carrier rail and Panel Hanger
d	Panel nominal thickness
e	Min. recommended 100mm
f	Panel joint - 10mm
a+b+c	Clad Zone



Elemental Architectural Cladding Specialists
 #29 The Cubes Offices, Beacon South Quarter,
 Sandyford
 Dublin 18, D18 A264
 Phone: +353 (0)1 293 8951
 Email: info@elemental.ie

Drawing Title

**ELEMENTAL GFRG - MSF
 EXTERNAL CORNER - OPEN JOINT OPTION**

Drawing No.

EL-CB-MG13

System:

**EL-MSF
 GFRG**

Size:

A4

Scale:

NTS

Drawn:

V.C.

Rev.

01

These drawings are indicative only, for use as a guide. The customer is always responsible for any specific design, structural calculations and calculating exact sizes & quantities of panels. Any project details and calculations supplied by Elemental Architectural Cladding Specialists are provided in good faith and should always be checked and approved by the project engineer responsible. Elemental Architectural Cladding Specialists will not accept any liability should the system be designed / installed incorrectly.

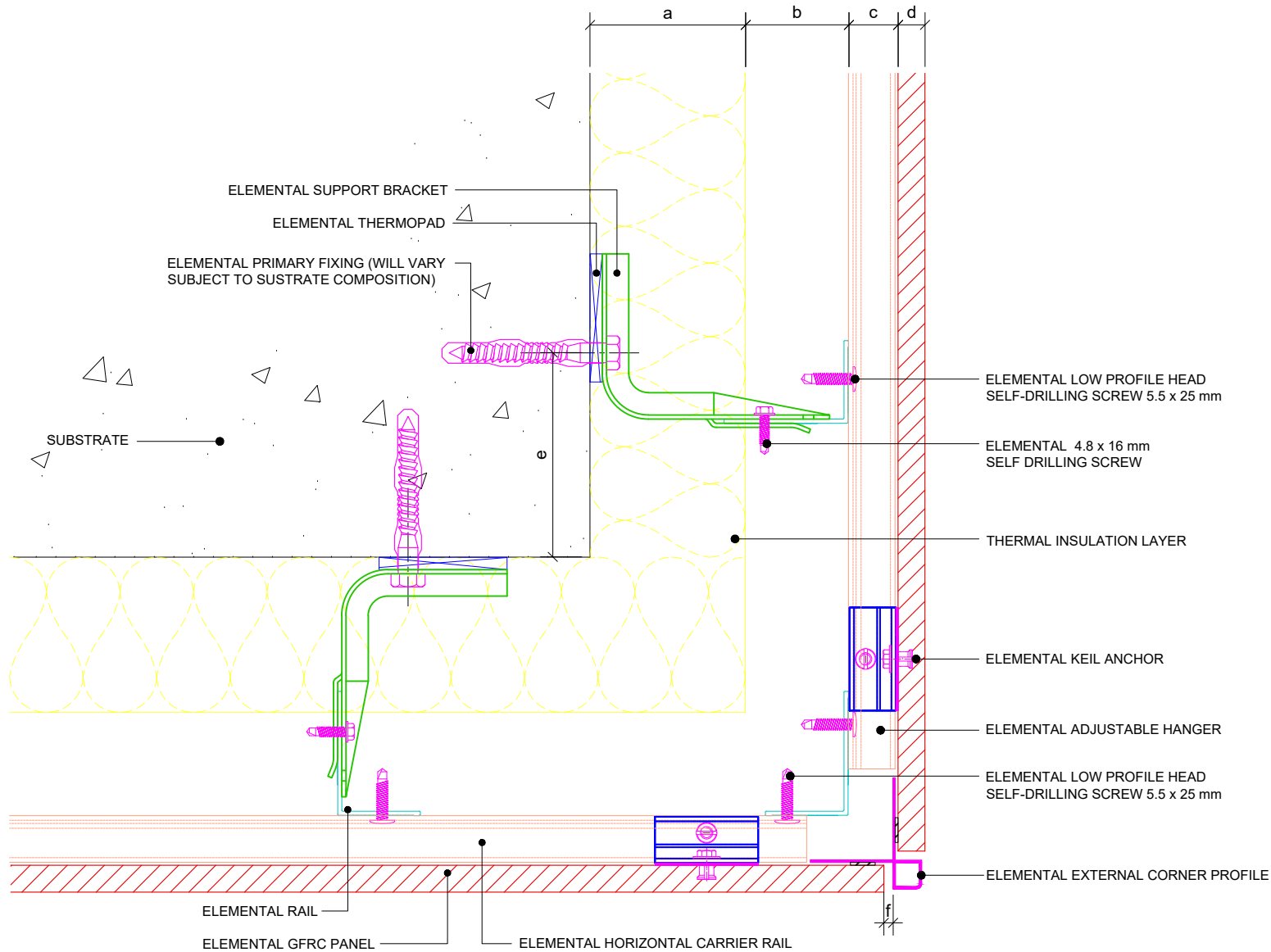

Dimensions	
a	Insulation thickness (varies)
b	Free vertical ventilation gap
c	Horizontal Carrier rail and Panel Hanger
d	Panel nominal thickness
e	Min. recommended 100mm
f	Minimum 5mm
a+b+c	Clad Zone



Elemental Architectural Cladding Specialists
 #29 The Cubes Offices, Beacon South Quarter,
 Sandyford
 Dublin 18, D18 A264
 Phone: +353 (0)1 293 8951
 Email: info@elemental.ie

Drawing Title

**ELEMENTAL GFRG - MSF
 EXTERNAL CORNER - PROFILE OPTION**

Drawing No.

EL-CB-MG14

System:

**EL-MSF
 GFRG**

Size:

A4

Scale:

NTS

Drawn:

V.C.

Rev.

01

These drawings are indicative only, for use as a guide. The customer is always responsible for any specific design, structural calculations and calculating exact sizes & quantities of panels. Any project details and calculations supplied by Elemental Architectural Cladding Specialists are provided in good faith and should always be checked and approved by the project engineer responsible. Elemental Architectural Cladding Specialists will not accept any liability should the system be designed / installed incorrectly.

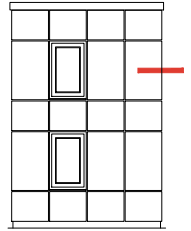
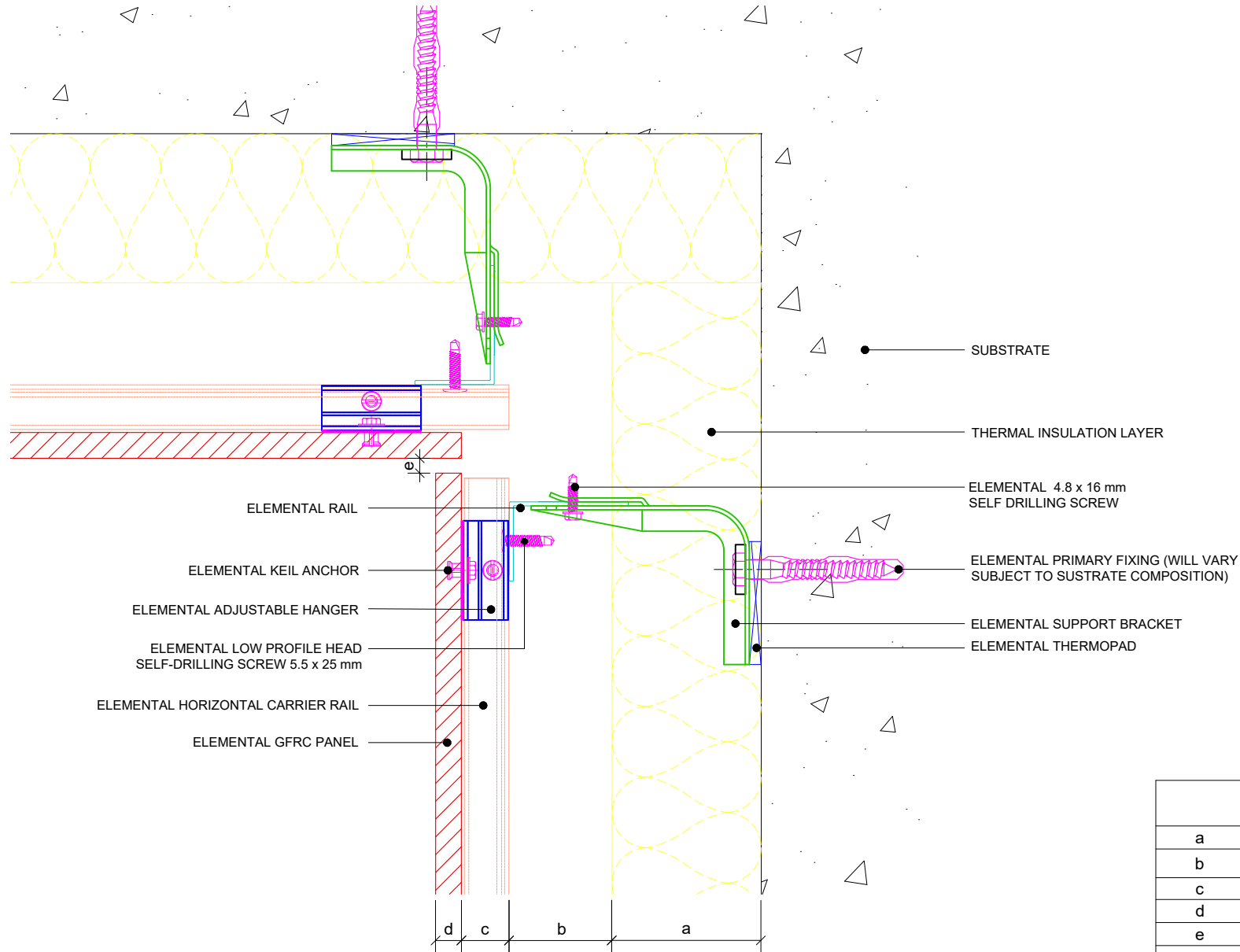

Dimensions	
a	Insulation thickness (varies)
b	Free vertical ventilation gap
c	Horizontal Carrier rail and Panel Hanger
d	Panel nominal thickness
e	Recommended 10mm
a+b+c	Clad Zone



Elemental Architectural Cladding Specialists
 #29 The Cubes Offices, Beacon South Quarter,
 Sandyford
 Dublin 18, D18 A264
 Phone: +353 (0)1 293 8951
 Email: info@elemental.ie

Drawing Title

**ELEMENTAL GFRC - MSF
 INTERNAL CORNER - OPEN JOINT OPTION**

Drawing No.

EL-CB-MG15

System:

**EL-MSF
 GFRC**

Size:

A4

Scale:

NTS

Drawn:

V.C.

Rev.

01

These drawings are indicative only, for use as a guide. The customer is always responsible for any specific design, structural calculations and calculating exact sizes & quantities of panels. Any project details and calculations supplied by Elemental Architectural Cladding Specialists are provided in good faith and should always be checked and approved by the project engineer responsible. Elemental Architectural Cladding Specialists will not accept any liability should the system be designed / installed incorrectly.

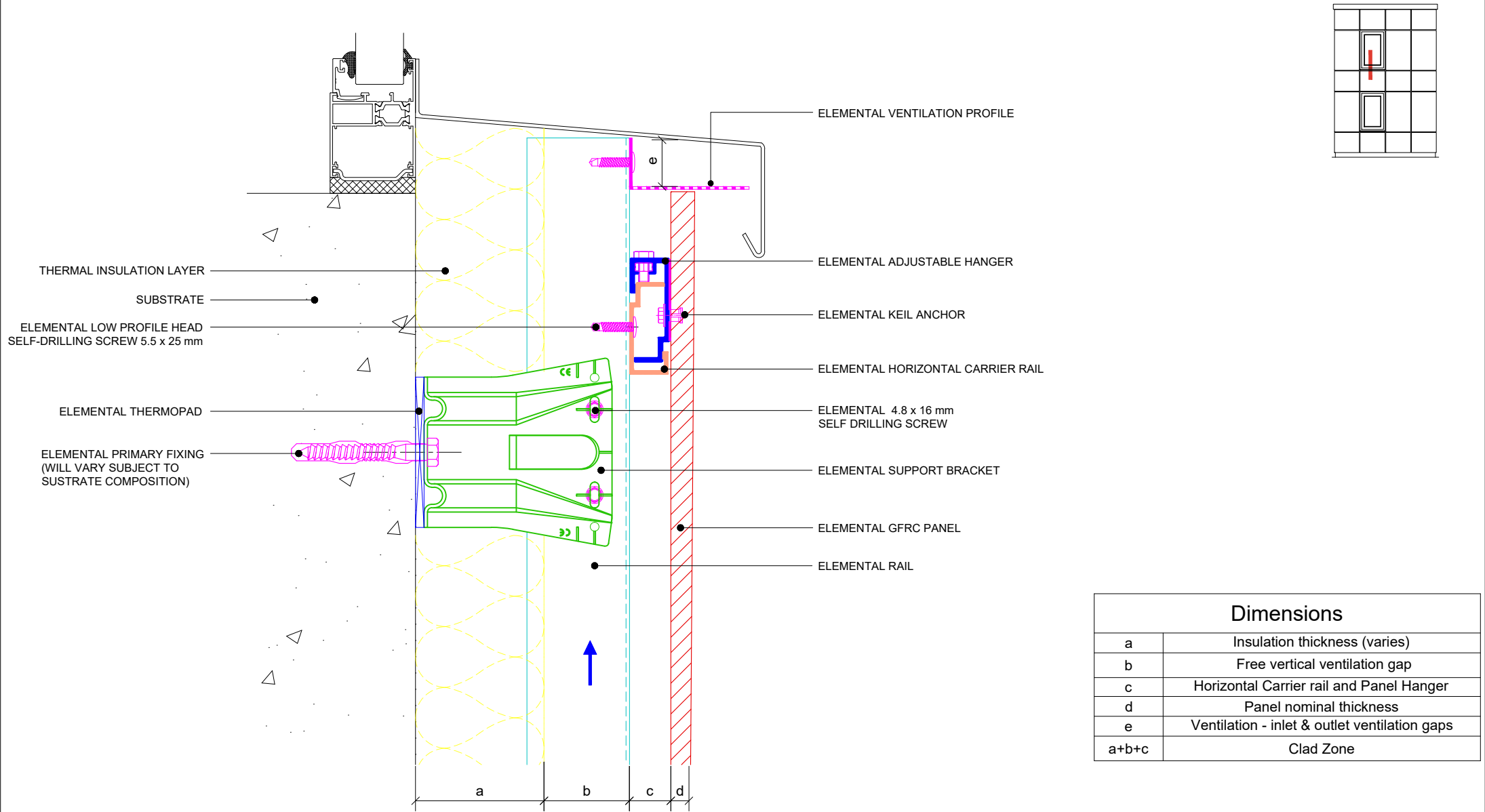

Dimensions	
a	Insulation thickness (varies)
b	Free vertical ventilation gap
c	Horizontal Carrier rail and Panel Hanger
d	Panel nominal thickness
e	Ventilation - inlet & outlet ventilation gaps
a+b+c	Clad Zone



Elemental Architectural Cladding Specialists
 #29 The Cubes Offices, Beacon South Quarter,
 Sandyford
 Dublin 18, D18 A264
 Phone: +353 (0)1 293 8951
 Email: info@elemental.ie

Drawing Title

**ELEMENTAL GFRc - MSF
 GENERIC WINDOW CILL DETAIL**

Drawing No.

EL-CB-MG16

System:

**EL-MSF
 GFRc**

Size:

A4

Scale:

NTS

Drawn:

V.C.

Rev.

01

These drawings are indicative only, for use as a guide. The customer is always responsible for any specific design, structural calculations and calculating exact sizes & quantities of panels. Any project details and calculations supplied by Elemental Architectural Cladding Specialists are provided in good faith and should always be checked and approved by the project engineer responsible. Elemental Architectural Cladding Specialists will not accept any liability should the system be designed / installed incorrectly.

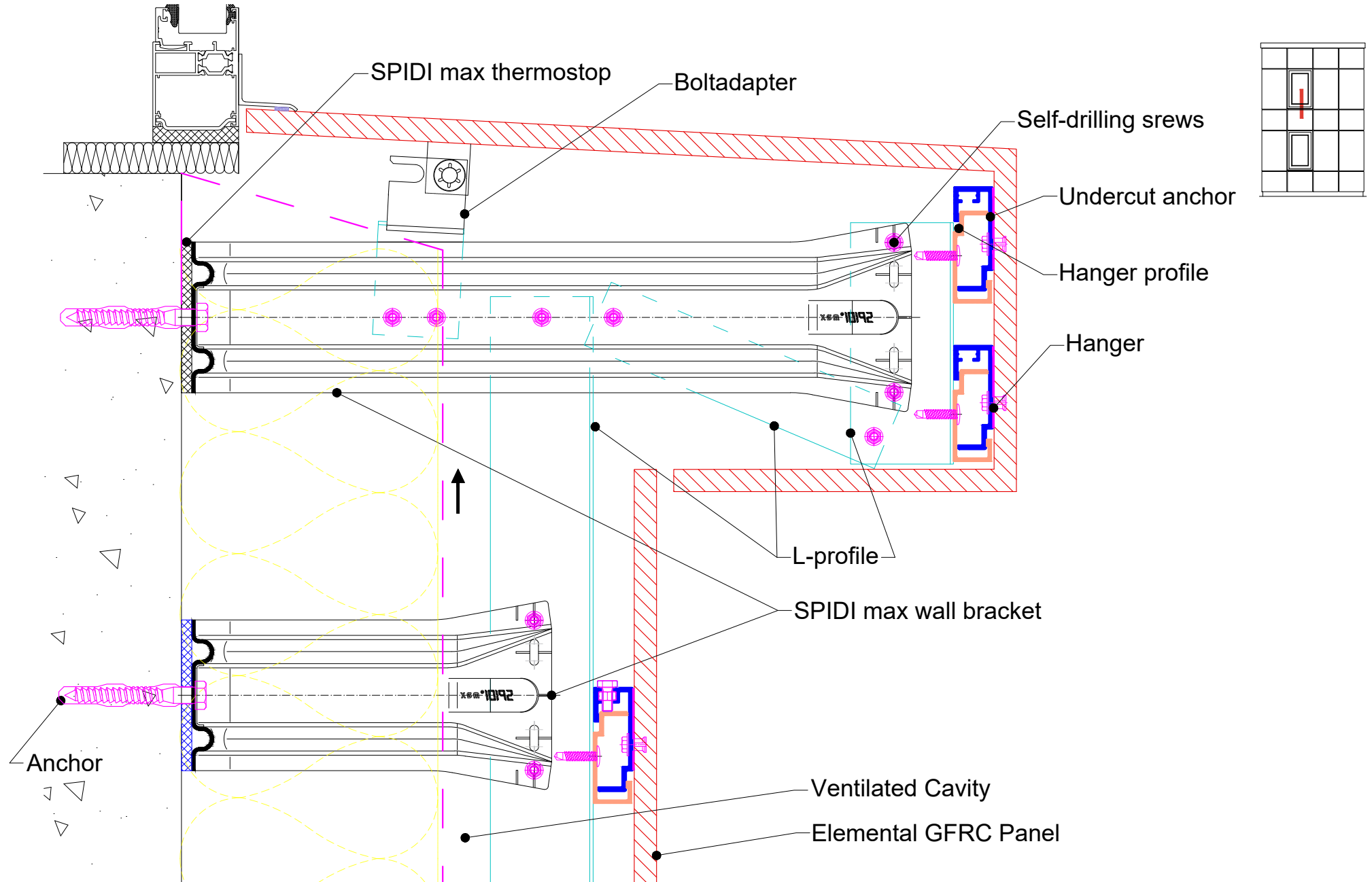

Elemental Architectural Cladding Specialists
 #29 The Cubes Offices, Beacon South Quarter,
 Sandyford
 Dublin 18, D18 A264
 Phone: +353 (0)1 293 8951
 Email: info@elemental.ie

Drawing Title

ELEMENTAL GFRC - MSF
GENERIC WINDOW CILL DETAIL-COMPLETE PIECE OPTION

Drawing No.

EL-CB-MG17

System:

EL-MSF
 GFRC

Size:

A4

Scale:

NTS

Drawn:

V.C.

Rev.

01

These drawings are indicative only, for use as a guide. The customer is always responsible for any specific design, structural calculations and calculating exact sizes & quantities of panels. Any project details and calculations supplied by Elemental Architectural Cladding Specialists are provided in good faith and should always be checked and approved by the project engineer responsible. Elemental Architectural Cladding Specialists will not accept any liability should the system be designed / installed incorrectly.

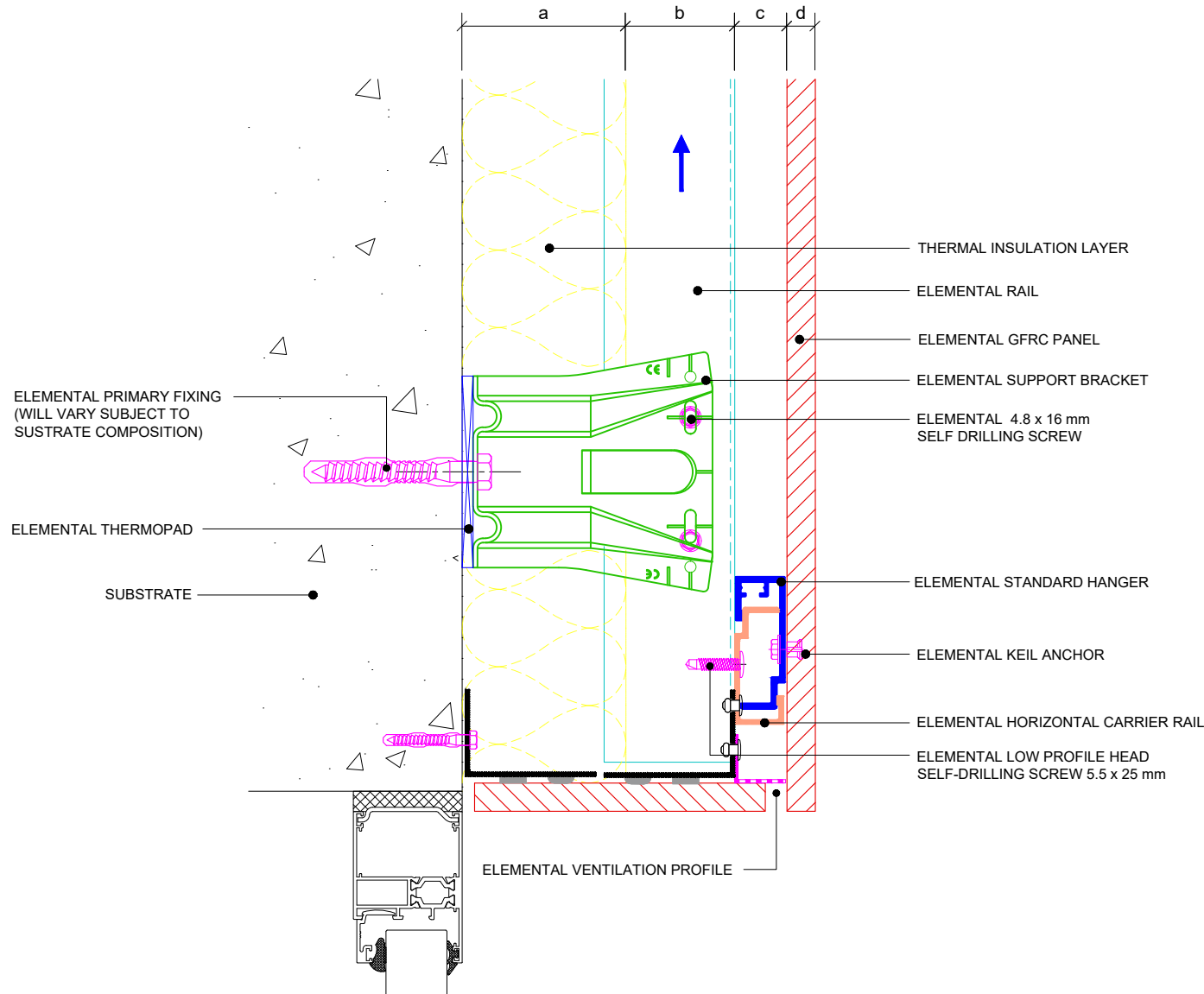

ELEMENTAL PRIMARY FIXING
(WILL VARY SUBJECT TO
SUBSTRATE COMPOSITION)

ELEMENTAL THERMOPAD

SUBSTRATE

THERMAL INSULATION LAYER

ELEMENTAL RAIL

ELEMENTAL GFRG PANEL

ELEMENTAL SUPPORT BRACKET

ELEMENTAL 4.8 x 16 mm
SELF DRILLING SCREW

ELEMENTAL STANDARD HANGER

ELEMENTAL KEIL ANCHOR

ELEMENTAL HORIZONTAL CARRIER RAIL

ELEMENTAL LOW PROFILE HEAD
SELF-DRILLING SCREW 5.5 x 25 mm

ELEMENTAL VENTILATION PROFILE

Dimensions

a	Insulation thickness (varies)
b	Free vertical ventilation gap
c	Horizontal Carrier rail and Panel Hanger
d	Panel nominal thickness
a+b+c	Clad Zone



Elemental Architectural Cladding Specialists
 #29 The Cubes Offices, Beacon South Quarter,
 Sandyford
 Dublin 18, D18 A264
 Phone: +353 (0)1 293 8951
 Email: info@elemental.ie

Drawing Title

**ELEMENTAL GFRG - MSF
 WINDOW HEAD DETAIL - OPEN JOINT OPTION**

Drawing No.

EL-CB-MG18

System:

**EL-MSF
 GFRG**

Size:

A4

Scale:

NTS

Drawn:

V.C.

Rev.

01

These drawings are indicative only, for use as a guide. The customer is always responsible for any specific design, structural calculations and calculating exact sizes & quantities of panels. Any project details and calculations supplied by Elemental Architectural Cladding Specialists are provided in good faith and should always be checked and approved by the project engineer responsible. Elemental Architectural Cladding Specialists will not accept any liability should the system be designed / installed incorrectly.

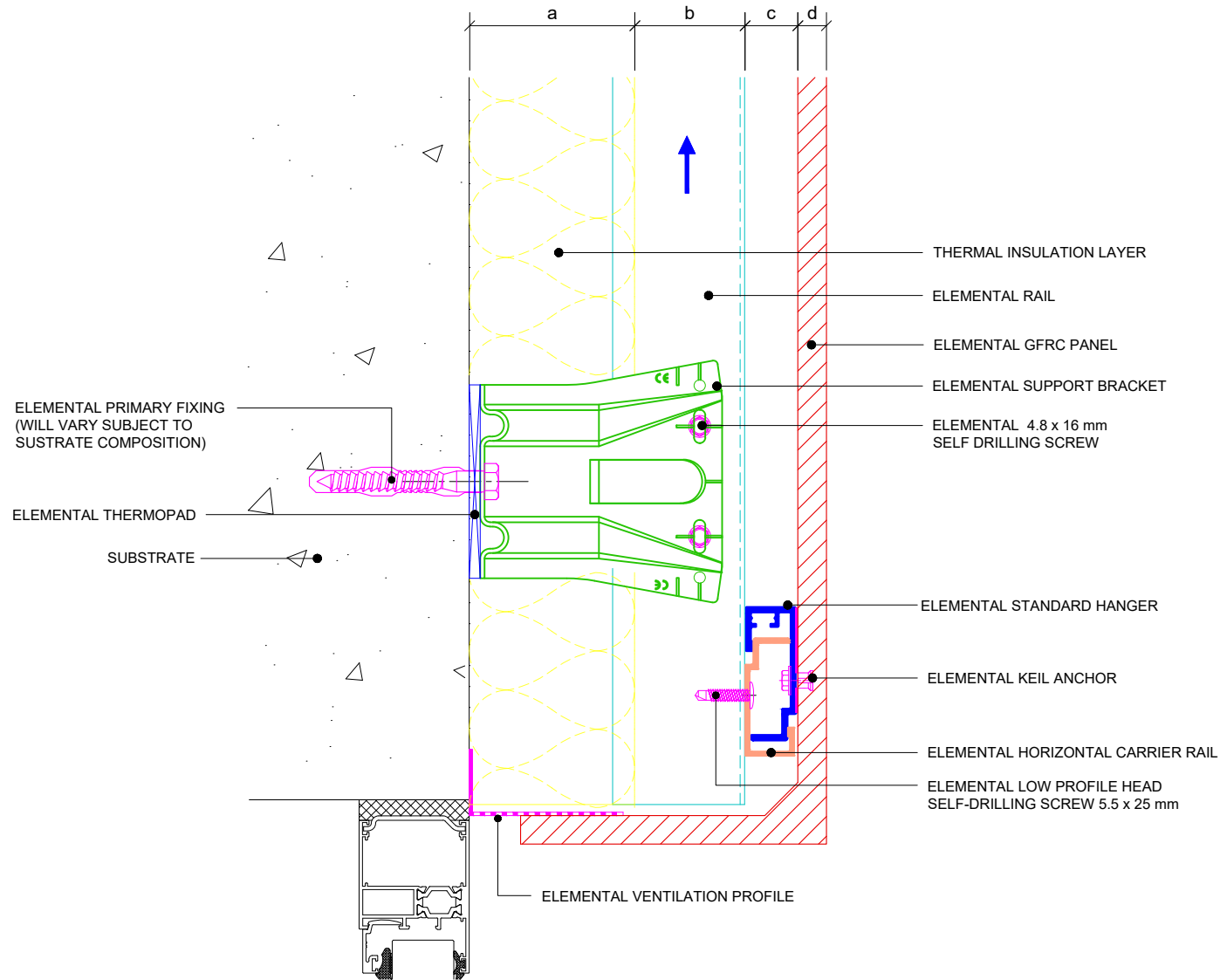

Dimensions	
a	Insulation thickness (varies)
b	Free vertical ventilation gap
c	Horizontal Carrier rail and Panel Hanger
d	Panel nominal thickness
a+b+c	Clad Zone



Elemental Architectural Cladding Specialists
 #29 The Cubes Offices, Beacon South Quarter,
 Sandyford
 Dublin 18, D18 A264
 Phone: +353 (0)1 293 8951
 Email: info@elemental.ie

Drawing Title

**ELEMENTAL GFRc - MSF
 WINDOW HEAD DETAIL - CLOSED JOINT OPTION**

Drawing No.

EL-CB-MG19

System:

**EL-MSF
 GFRc**

Size:

A4

Scale:

NTS

Drawn:

V.C.

Rev.

01

These drawings are indicative only, for use as a guide. The customer is always responsible for any specific design, structural calculations and calculating exact sizes & quantities of panels. Any project details and calculations supplied by Elemental Architectural Cladding Specialists are provided in good faith and should always be checked and approved by the project engineer responsible. Elemental Architectural Cladding Specialists will not accept any liability should the system be designed / installed incorrectly.

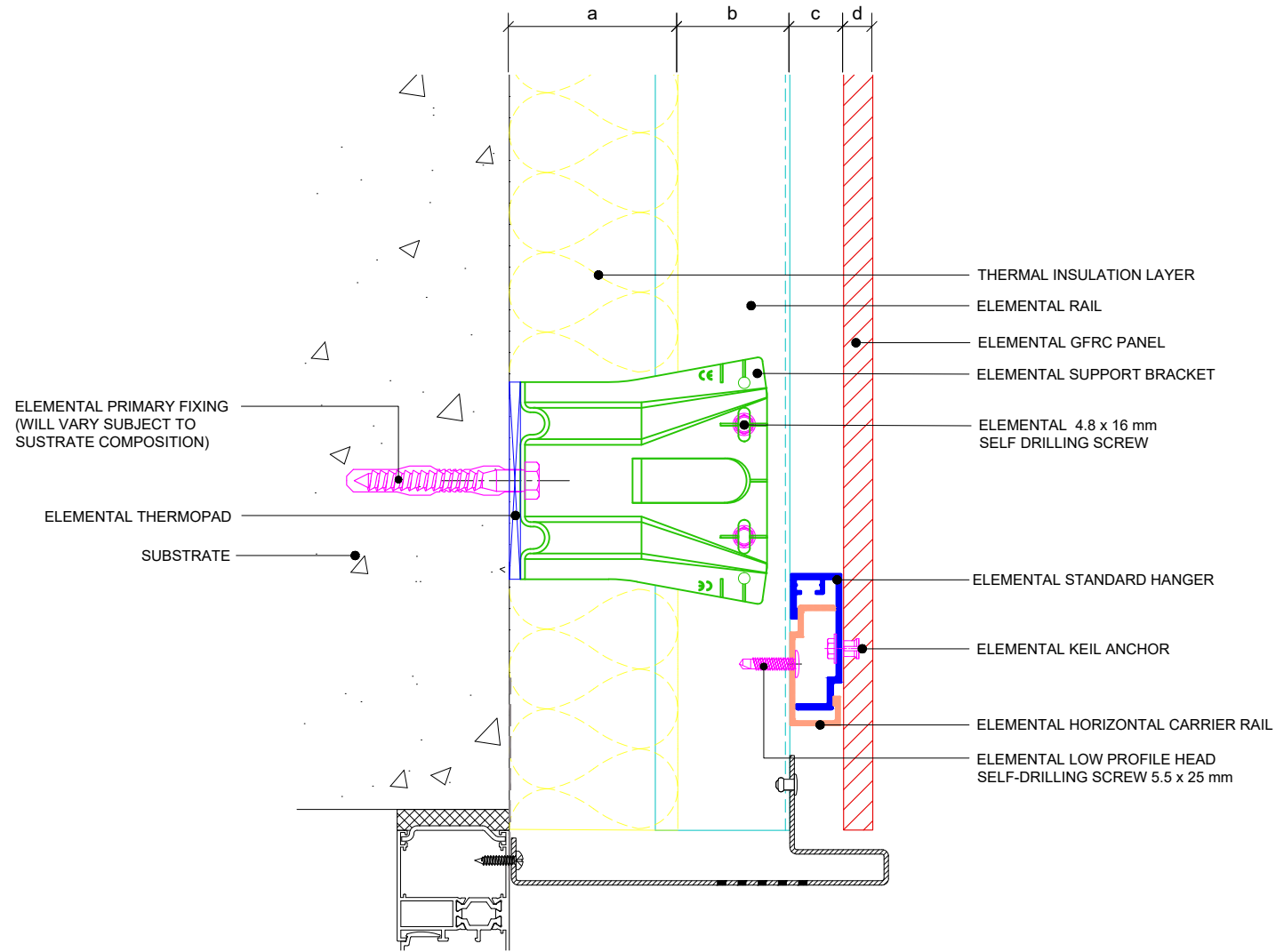

Dimensions	
a	Insulation thickness (varies)
b	Free vertical ventilation gap
c	Horizontal Carrier rail and Panel Hanger
d	Panel nominal thickness
a+b+c	Clad Zone



Elemental Architectural Cladding Specialists
 #29 The Cubes Offices, Beacon South Quarter,
 Sandyford
 Dublin 18, D18 A264
 Phone: +353 (0)1 293 8951
 Email: info@elemental.ie

Drawing Title

**ELEMENTAL GFRP - MSF
 WINDOW HEAD DETAIL- METAL FLASHING OPTION 1**

Drawing No.

EL-CB-MG20

System:

**EL-MSF
 GFRP**

Size:

A4

Scale:

NTS

Drawn:

V.C.

Rev.

01

These drawings are indicative only, for use as a guide. The customer is always responsible for any specific design, structural calculations and calculating exact sizes & quantities of panels. Any project details and calculations supplied by Elemental Architectural Cladding Specialists are provided in good faith and should always be checked and approved by the project engineer responsible. Elemental Architectural Cladding Specialists will not accept any liability should the system be designed / installed incorrectly.

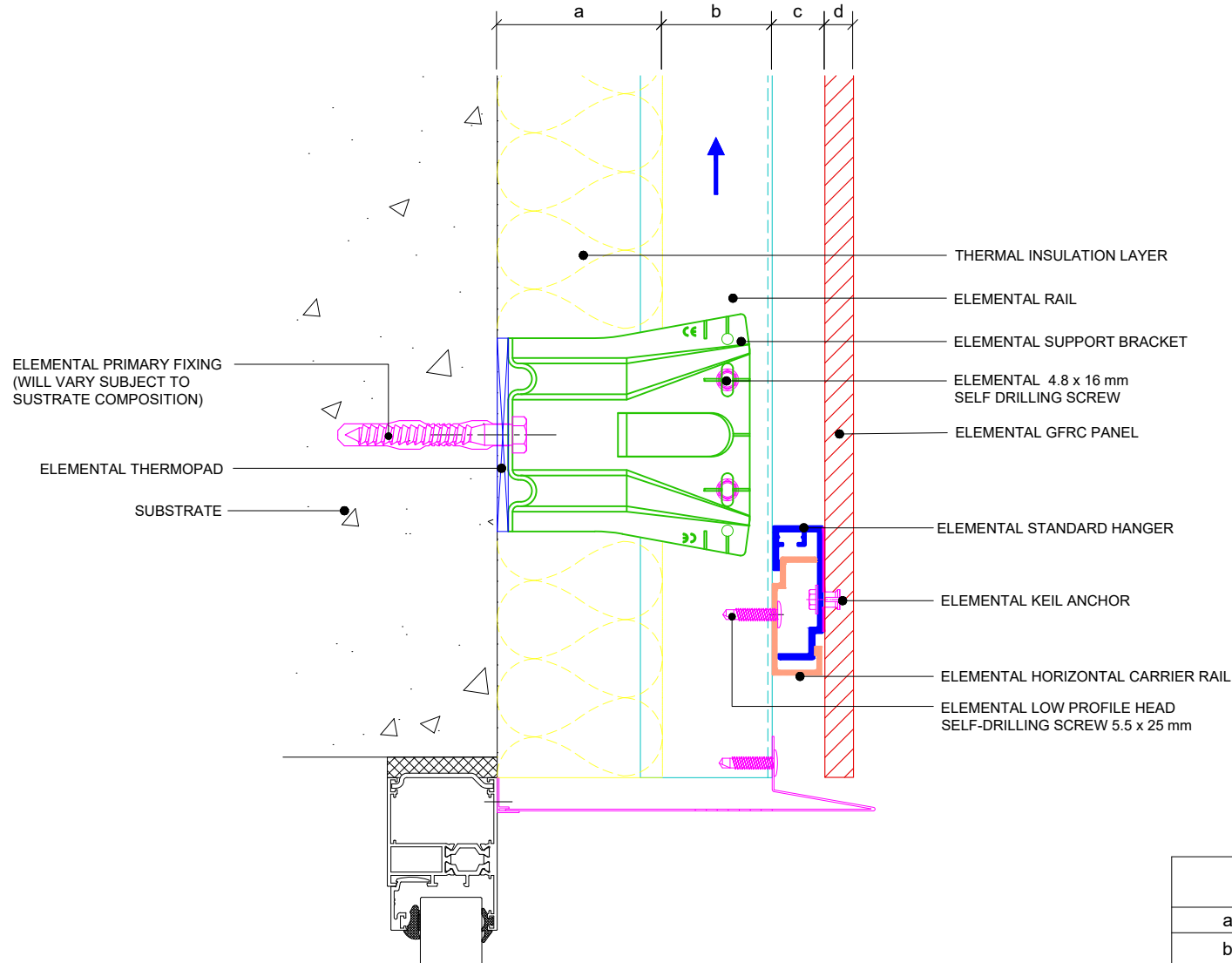

Dimensions	
a	Insulation thickness (varies)
b	Free vertical ventilation gap
c	Horizontal Carrier rail and Panel Hanger
d	Panel nominal thickness
a+b+c	Clad Zone



Elemental Architectural Cladding Specialists
 #29 The Cubes Offices, Beacon South Quarter,
 Sandyford
 Dublin 18, D18 A264
 Phone: +353 (0)1 293 8951
 Email: info@elemental.ie

Drawing Title

**ELEMENTAL GFRG - MSF
 WINDOW HEAD DETAIL - METAL FLASHING OPTION 2**

Drawing No.

EL-CB-MG21

System:

**EL-MSF
 GFRG**

Size:

A4

Scale:

NTS

Drawn:

V.C.

Rev.

01

These drawings are indicative only, for use as a guide. The customer is always responsible for any specific design, structural calculations and calculating exact sizes & quantities of panels. Any project details and calculations supplied by Elemental Architectural Cladding Specialists are provided in good faith and should always be checked and approved by the project engineer responsible. Elemental Architectural Cladding Specialists will not accept any liability should the system be designed / installed incorrectly.

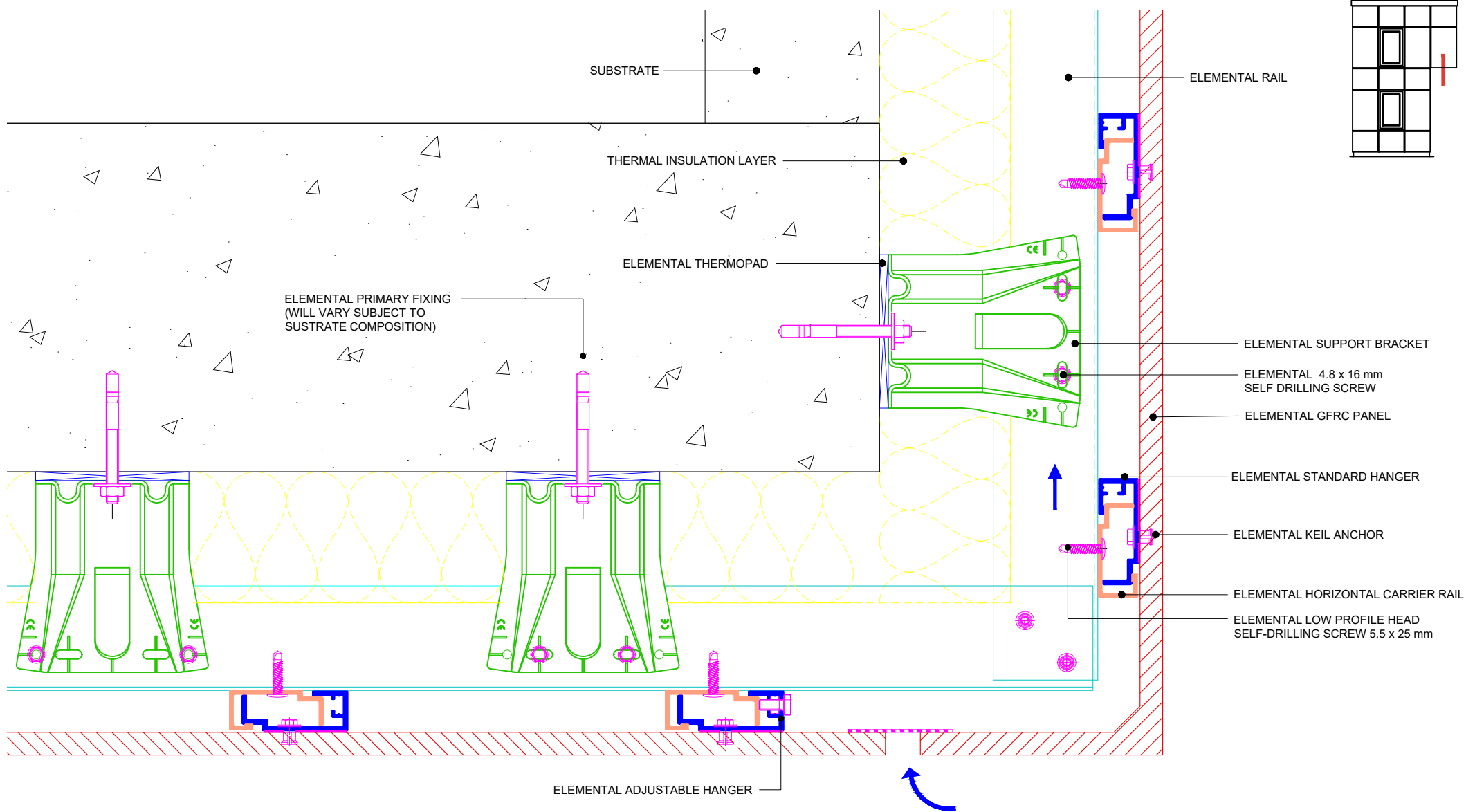

Elemental Architectural Cladding Specialists
 #29 The Cubes Offices, Beacon South Quarter,
 Sandyford
 Dublin 18, D18 A264
 Phone: +353 (0)1 293 8951
 Email: info@elemental.ie

Drawing Title

**ELEMENTAL GFRP - MSF
 SOFFIT DETAIL**

Drawing No.

EL-CB-MG22

System:

EL-MSF
 GFRP

Size:

A4

Scale:

NTS

Drawn:

V.C.

Rev.

01

These drawings are indicative only, for use as a guide. The customer is always responsible for any specific design, structural calculations and calculating exact sizes & quantities of panels. Any project details and calculations supplied by Elemental Architectural Cladding Specialists are provided in good faith and should always be checked and approved by the project engineer responsible. Elemental Architectural Cladding Specialists will not accept any liability should the system be designed / installed incorrectly.

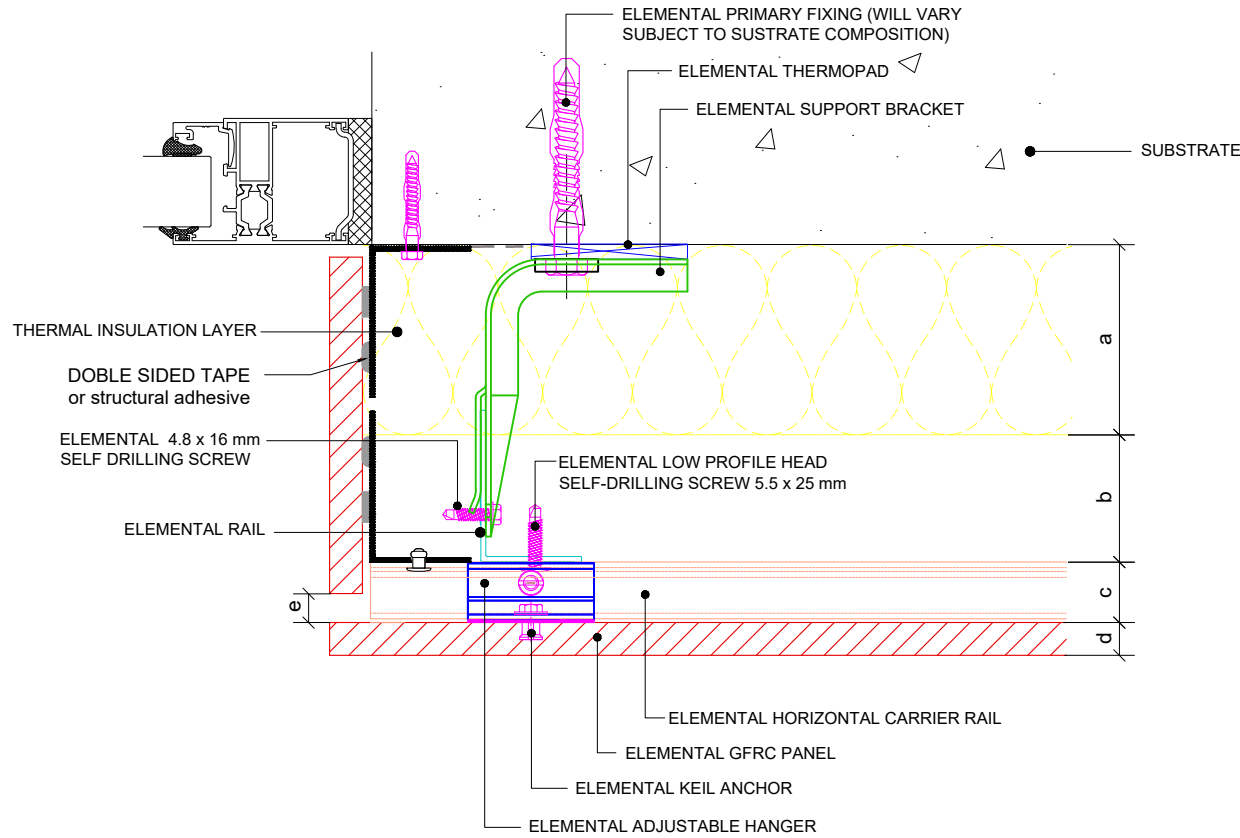
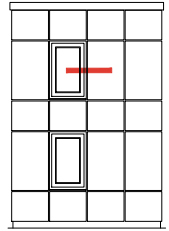

Dimensions	
a	Insulation thickness (varies)
b	Free vertical ventilation gap
c	Horizontal Carrier rail and Panel Hanger
d	Panel nominal thickness
e	recommended 10mm
a+b+c	Clad Zone



Elemental Architectural Cladding Specialists
 #29 The Cubes Offices, Beacon South Quarter,
 Sandyford
 Dublin 18, D18 A264
 Phone: +353 (0)1 293 8951
 Email: info@elemental.ie

Drawing Title

**ELEMENTAL GFRP - MSF
 WINDOW JAM REVEAL - OPEN OPTION**

Drawing No.

EL-CB-MG23

System:

**EL-MSF
 GFRP**

Size:

A4

Scale:

NTS

Drawn:

V.C.

Rev.

01

These drawings are indicative only, for use as a guide. The customer is always responsible for any specific design, structural calculations and calculating exact sizes & quantities of panels. Any project details and calculations supplied by Elemental Architectural Cladding Specialists are provided in good faith and should always be checked and approved by the project engineer responsible. Elemental Architectural Cladding Specialists will not accept any liability should the system be designed / installed incorrectly.

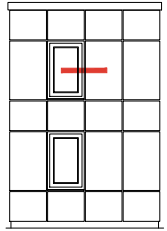
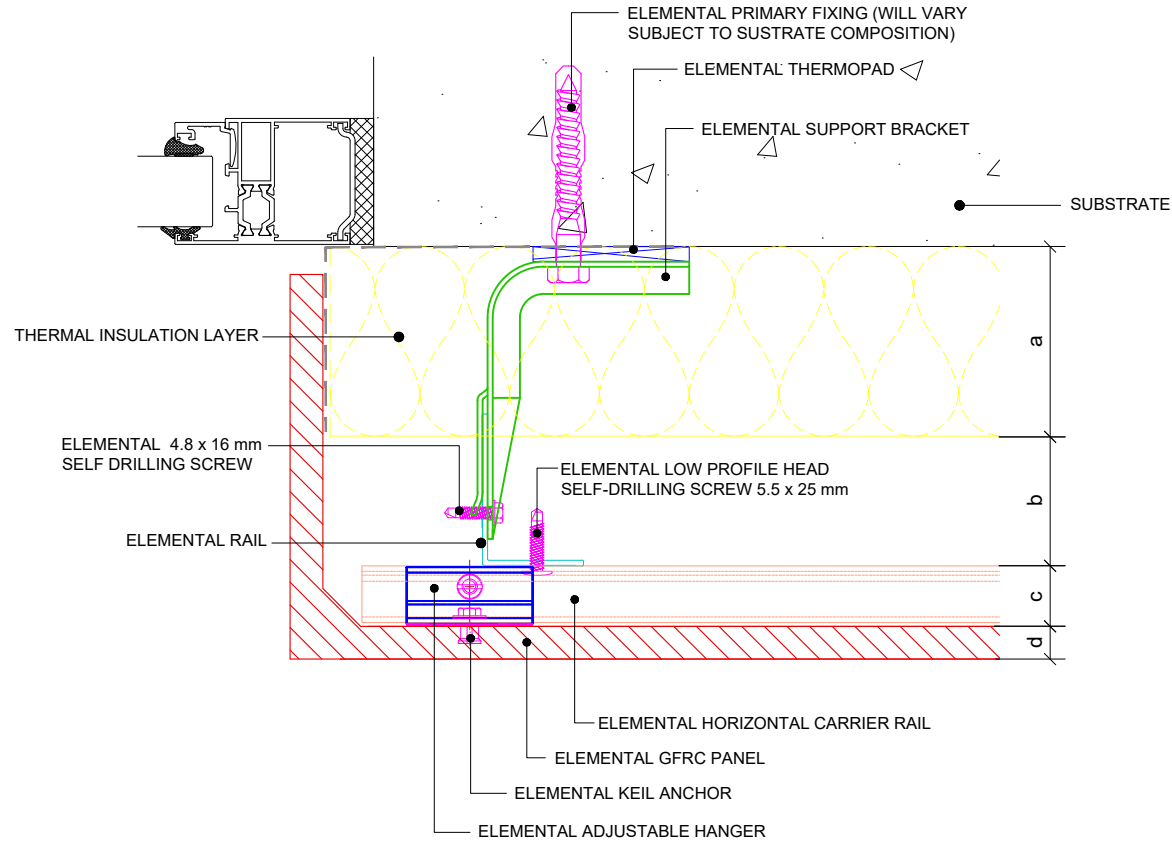

Dimensions	
a	Insulation thickness (varies)
b	Free vertical ventilation gap
c	Horizontal Carrier rail and Panel Hanger
d	Panel nominal thickness
a+b+c	Clad Zone



Elemental Architectural Cladding Specialists
 #29 The Cubes Offices, Beacon South Quarter,
 Sandyford
 Dublin 18, D18 A264
 Phone: +353 (0)1 293 8951
 Email: info@elemental.ie

Drawing Title

**ELEMENTAL GFRc - MSF
 WINDOW JAM REVEAL - CLOSED OPTION**

Drawing No.

EL-CB-MG24

System:

**EL-MSF
 GFRc**

Size:

A4

Scale:

NTS

Drawn:

V.C.

Rev.

01

These drawings are indicative only, for use as a guide. The customer is always responsible for any specific design, structural calculations and calculating exact sizes & quantities of panels. Any project details and calculations supplied by Elemental Architectural Cladding Specialists are provided in good faith and should always be checked and approved by the project engineer responsible. Elemental Architectural Cladding Specialists will not accept any liability should the system be designed / installed incorrectly.

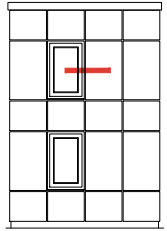
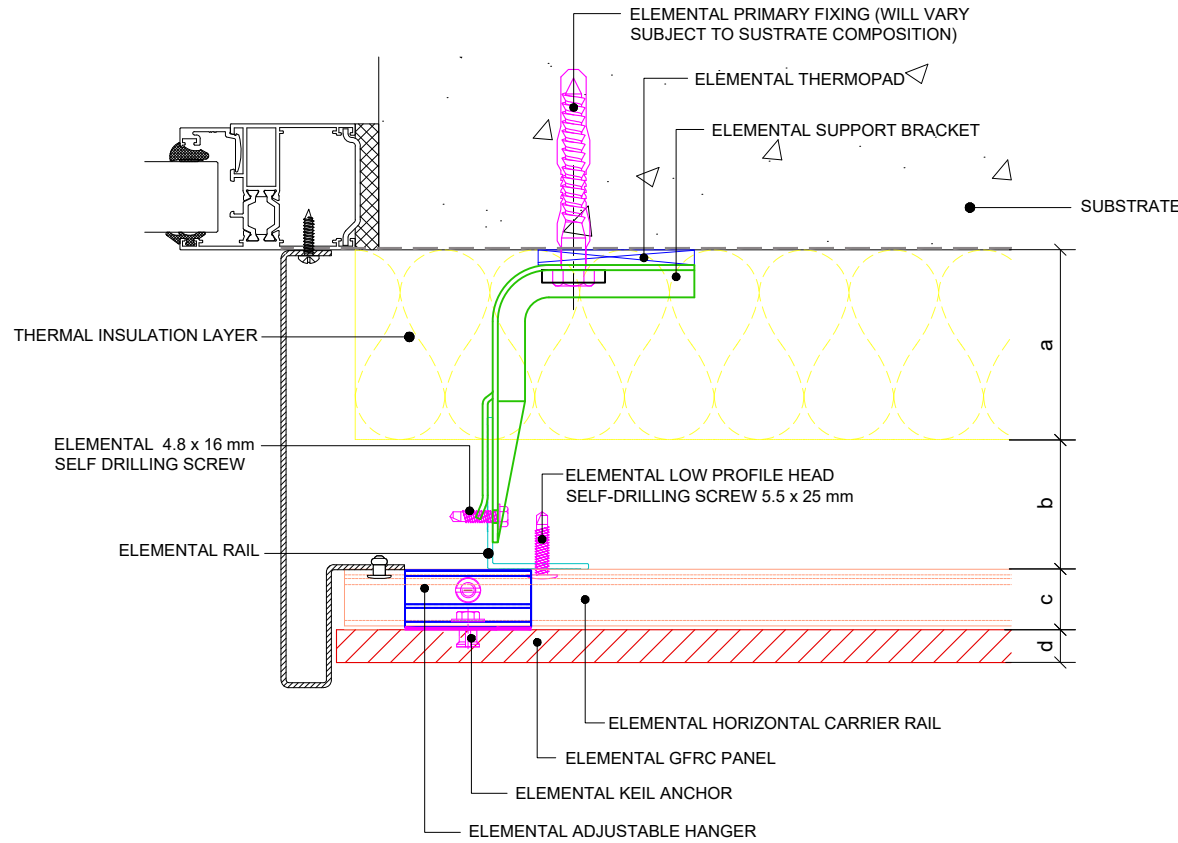

Dimensions	
a	Insulation thickness (varies)
b	Free vertical ventilation gap
c	Horizontal Carrier rail and Panel Hanger
d	Panel nominal thickness
a+b+c	Clad Zone



Elemental Architectural Cladding Specialists
 #29 The Cubes Offices, Beacon South Quarter,
 Sandyford
 Dublin 18, D18 A264
 Phone: +353 (0)1 293 8951
 Email: info@elemental.ie

Drawing Title

**ELEMENTAL GFRc - MSF
 WINDOW JAM REVEAL - METAL FLASHING OPTION**

Drawing No.

EL-CB-MG25

System:

**EL-MSF
 GFRc**

Size:

A4

Scale:

NTS

Drawn:

V.C.

Rev.

01

These drawings are indicative only, for use as a guide. The customer is always responsible for any specific design, structural calculations and calculating exact sizes & quantities of panels. Any project details and calculations supplied by Elemental Architectural Cladding Specialists are provided in good faith and should always be checked and approved by the project engineer responsible. Elemental Architectural Cladding Specialists will not accept any liability should the system be designed / installed incorrectly.

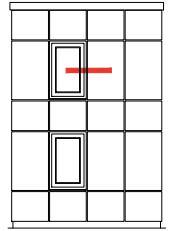
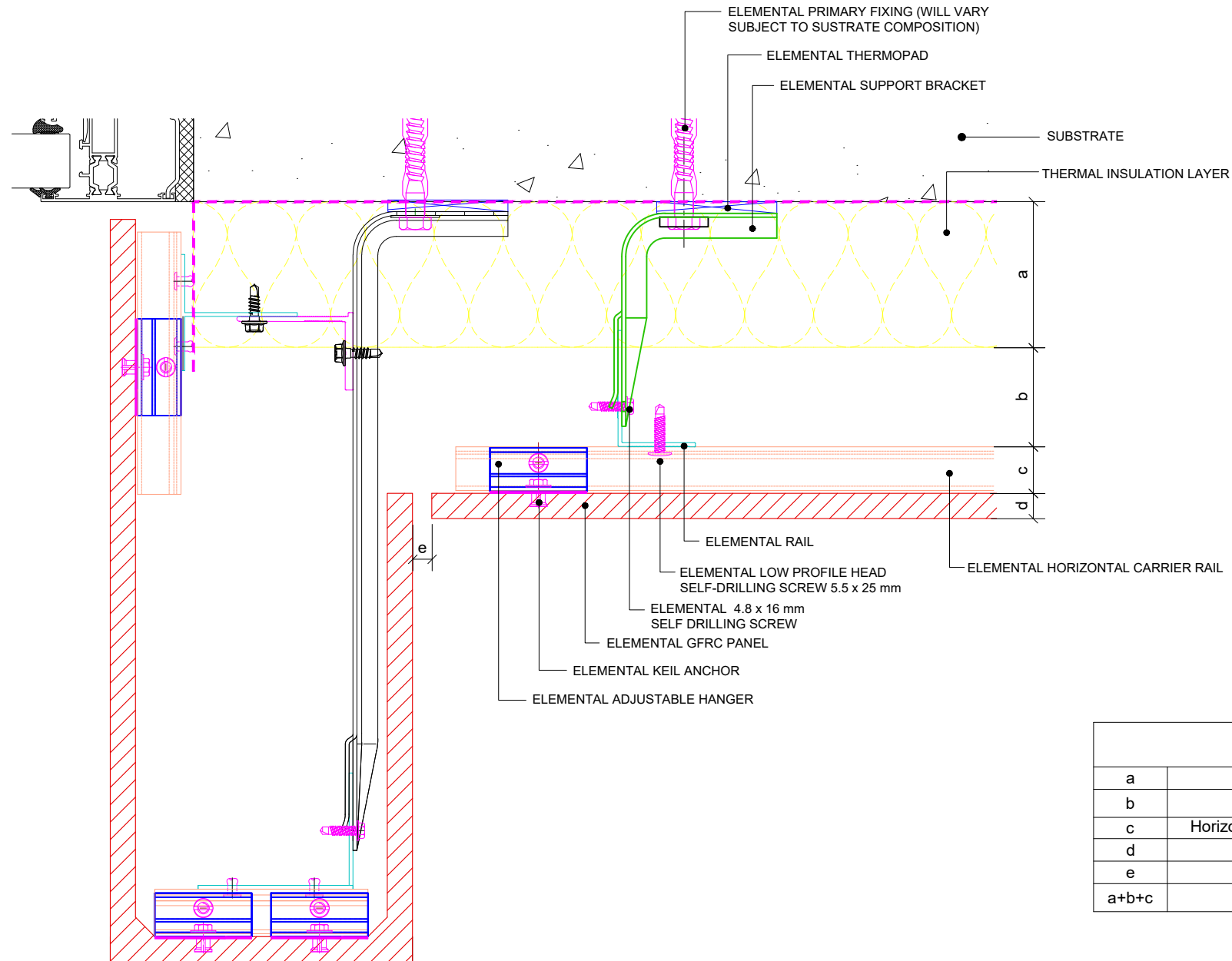

Dimensions

a	Insulation thickness (varies)
b	Free vertical ventilation gap
c	Horizontal Carrier rail and Panel Hanger
d	Panel nominal thickness
e	10 mm
a+b+c	Clad Zone



Elemental Architectural Cladding Specialists
 #29 The Cubes Offices, Beacon South Quarter,
 Sandyford
 Dublin 18, D18 A264
 Phone: +353 (0)1 293 8951
 Email: info@elemental.ie

Drawing Title

**ELEMENTAL GFRc - MSF
 WINDOW JAM REVEAL - COMPLETE PIECE OPTION 1**

Drawing No.

EL-CB-MG26

System:

**EL-MSF
 GFRc**

Size:

A4

Scale:

NTS

Drawn:

V.C.

Rev.

01

These drawings are indicative only, for use as a guide. The customer is always responsible for any specific design, structural calculations and calculating exact sizes & quantities of panels. Any project details and calculations supplied by Elemental Architectural Cladding Specialists are provided in good faith and should always be checked and approved by the project engineer responsible. Elemental Architectural Cladding Specialists will not accept any liability should the system be designed / installed incorrectly.

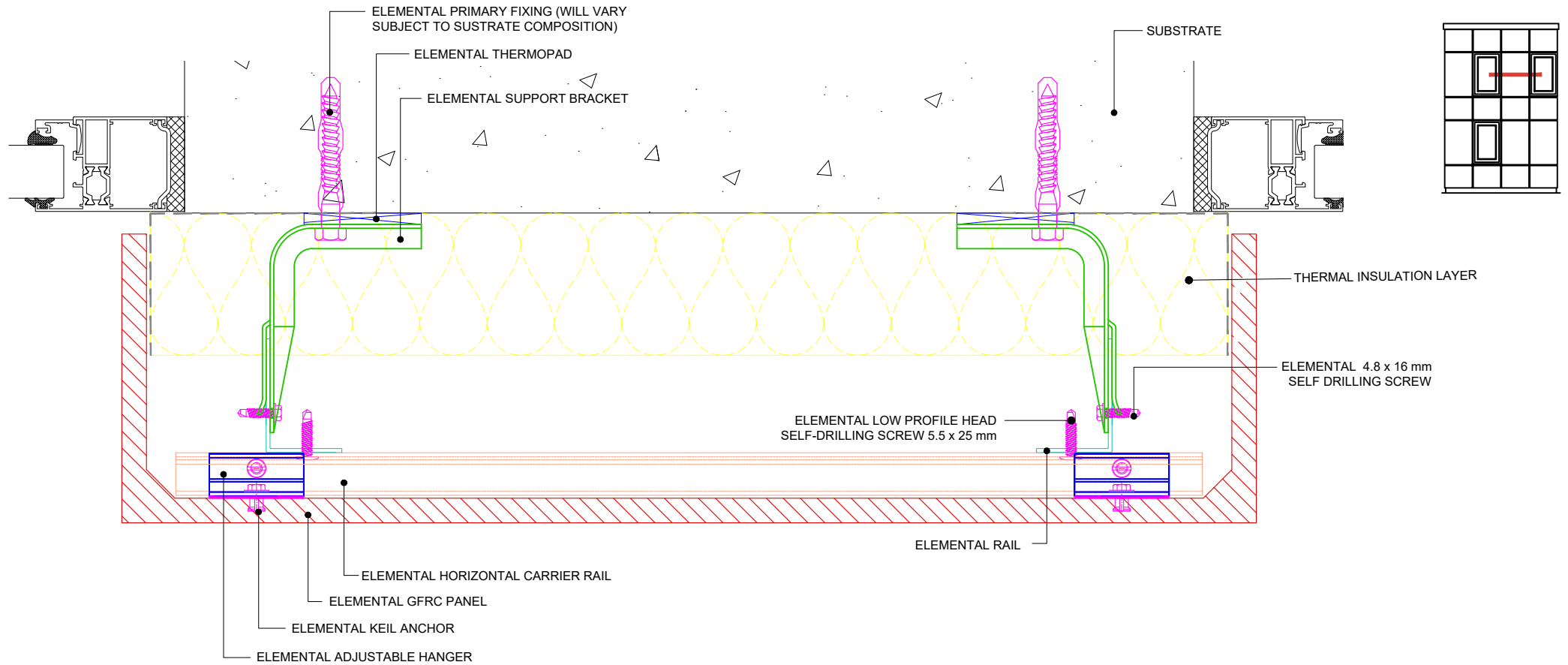

Elemental Architectural Cladding Specialists
 #29 The Cubes Offices, Beacon South Quarter,
 Sandyford
 Dublin 18, D18 A264
 Phone: +353 (0)1 293 8951
 Email: info@elemental.ie

Drawing Title

**ELEMENTAL GFRc - MSF
 WINDOW JAM REVEAL - COMPLETE PIECE OPTION 2**

Drawing No.

EL-CB-MG27

System:

**EL-MSF
 GFRc**

Size:

A4

Scale:

NTS

Drawn:

V.C.

Rev.

01

These drawings are indicative only, for use as a guide. The customer is always responsible for any specific design, structural calculations and calculating exact sizes & quantities of panels. Any project details and calculations supplied by Elemental Architectural Cladding Specialists are provided in good faith and should always be checked and approved by the project engineer responsible. Elemental Architectural Cladding Specialists will not accept any liability should the system be designed / installed incorrectly.

Adjustable Fixed Hanger

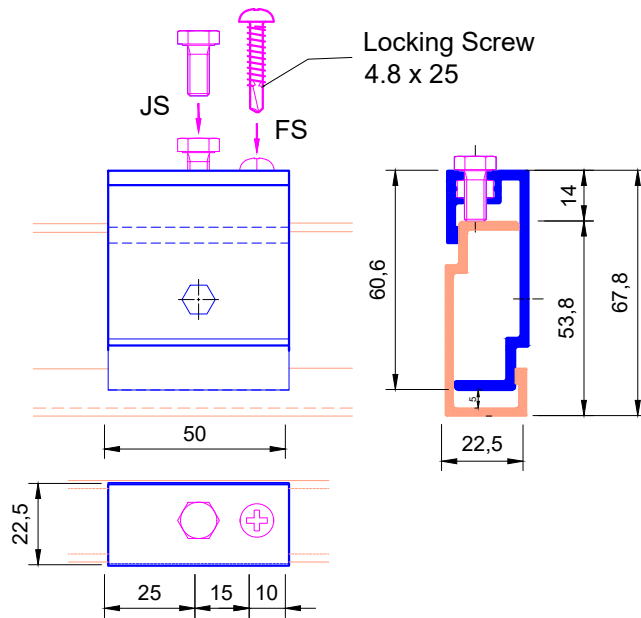

Adjustable Hanger

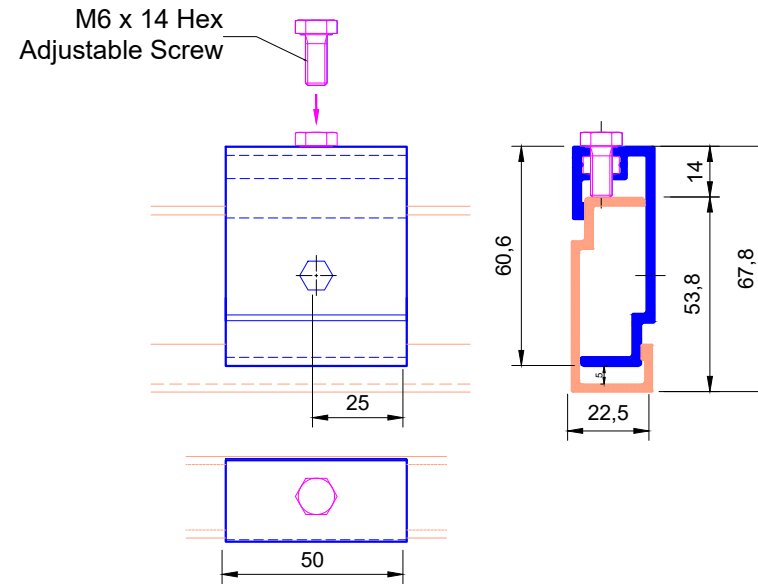

Standard Hanger

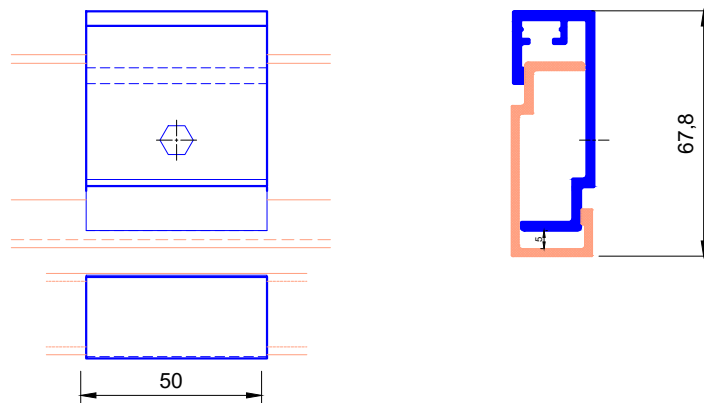

A lift of 20 mm will allow the panel hanger to clear the horizontal rail. We advise a minimum of 25mm clearance gap for ease of installation.

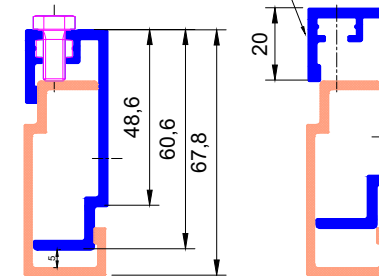

Elemental Architectural Cladding Specialists
 #29 The Cubes Offices, Beacon South Quarter,
 Sandyford
 Dublin 18, D18 A264
 Phone: +353 (0)1 293 8951
 Email: info@elemental.ie

Drawing Title

**ELEMENTAL GFRC - MSF
 PANEL HANGERS**

Drawing No.

EL-CB-MG28

System:

EL-MSF
 GFRC

Size:

A4

Scale:

NTS

Drawn:

V.C.

Rev.

01