

aluminium support system for
rain screen cladding panels

NVELOPE SYSTEM NV4 TRESPA SYSTEM TS200

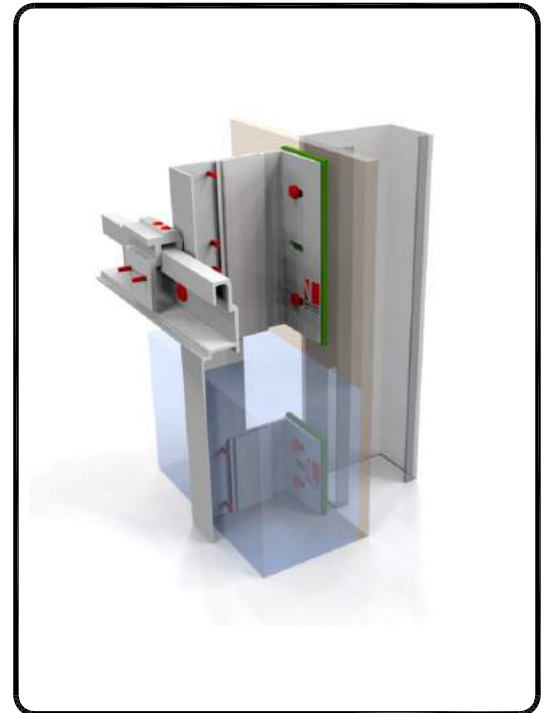

CONTENTS:

- NV4-01 Tolerances for adjustment
- NV4-02 Elevation of cladding – details
- NV4-03 Elevation of cladding
- NV4-04 Horizontal section – NVELOPE 90 SINGLE
- NV4-05 Vertical section – NVELOPE 90 SINGLE
- NV4-06 Vertical section – NVELOPE 90 DOUBLE
- NV4-07 Vertical section with joint in profile
- NV4-08 Vertical section – base detail
- NV4-09 Vertical section – head of cladding
- NV4-10 Horizontal section–external corner
- NV4-11 Horizontal section–internal corner
- NV4-12 Horizontal section–window jamb detail
- NV4-13 Vertical section–window sill detail
- NV4-14 Vertical section–window head detail
- NV4-15 Final fix detail
- NV4-16 TS200 clips and rail dimsl

LEGEND:

- A – TRESPA METEON 10mm OR 13mm SHEET
- B – PTS Screw
- C1 – Secret fixing clip with levelling screw
- C2 – Secret fixing clip.
- D – Screw
- E – Fixing screw
- F – Window profile
- 1 – Steel frame wall
- 2 – NVELOPE – support bracket
- 3 – Primary Fixing
- 4 – L profile vertical (60 X 40 X 2.2)
- 5 – SR2 self drilling stainless steel screw
- 6 – Horizontal Profile
- 7 – Insulation
- 8 – Ventilation
- 10 – NVELOPE Isolator

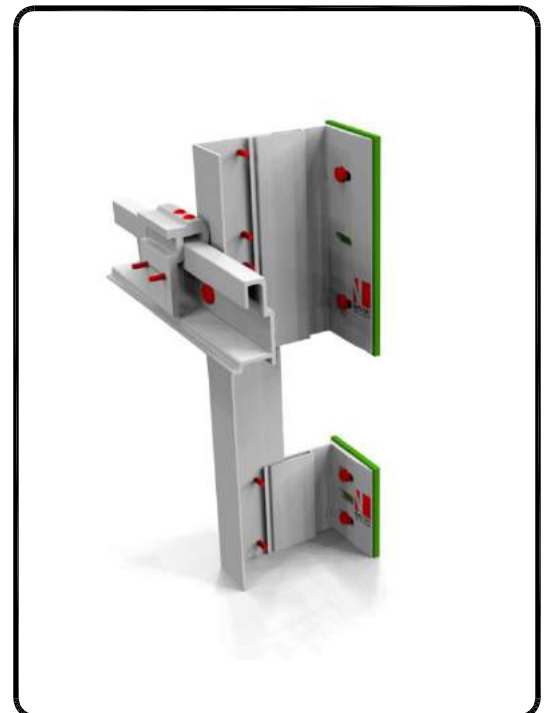

**REFER TO TRESPA DESIGN
GUIDE FOR DETAILS**

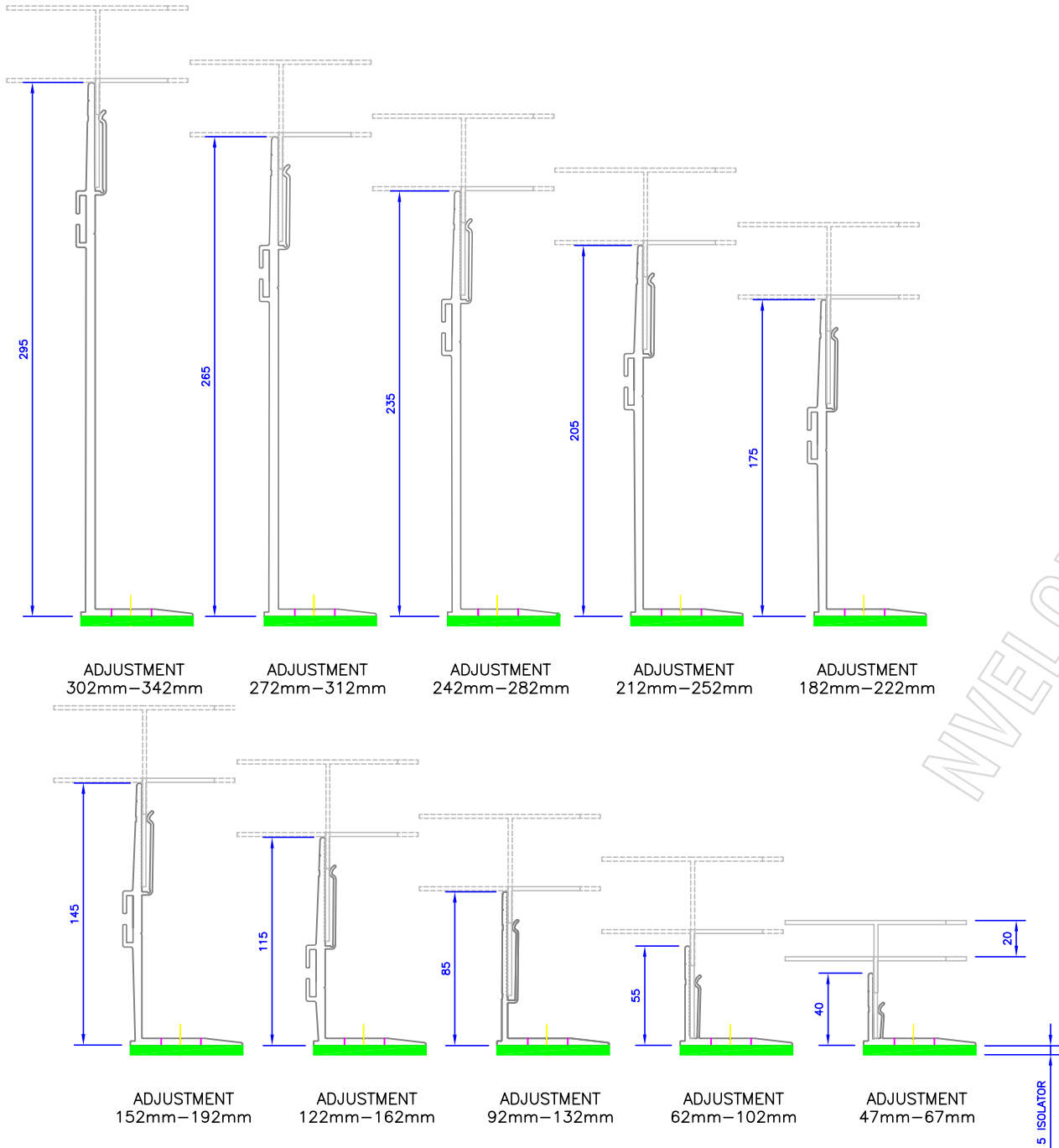

BRACKETS	Adjustment range for each bracket (mm)	
Nvelope 40	from 47	to 67
Nvelope 60	from 62	to 102
Nvelope 90	from 92	to 132
Nvelope 120	from 122	to 162
Nvelope 150	from 152	to 192
Nvelope 180	from 182	to 222
Nvelope 210	from 212	to 252
Nvelope 240	from 242	to 282
Nvelope 270	from 272	to 312
Nvelope 300	from 302	to 342

HORIZONTAL SECTIONS
 TOLERANCES FOR ADJUSTMENT



Tel: (01) 293 8951

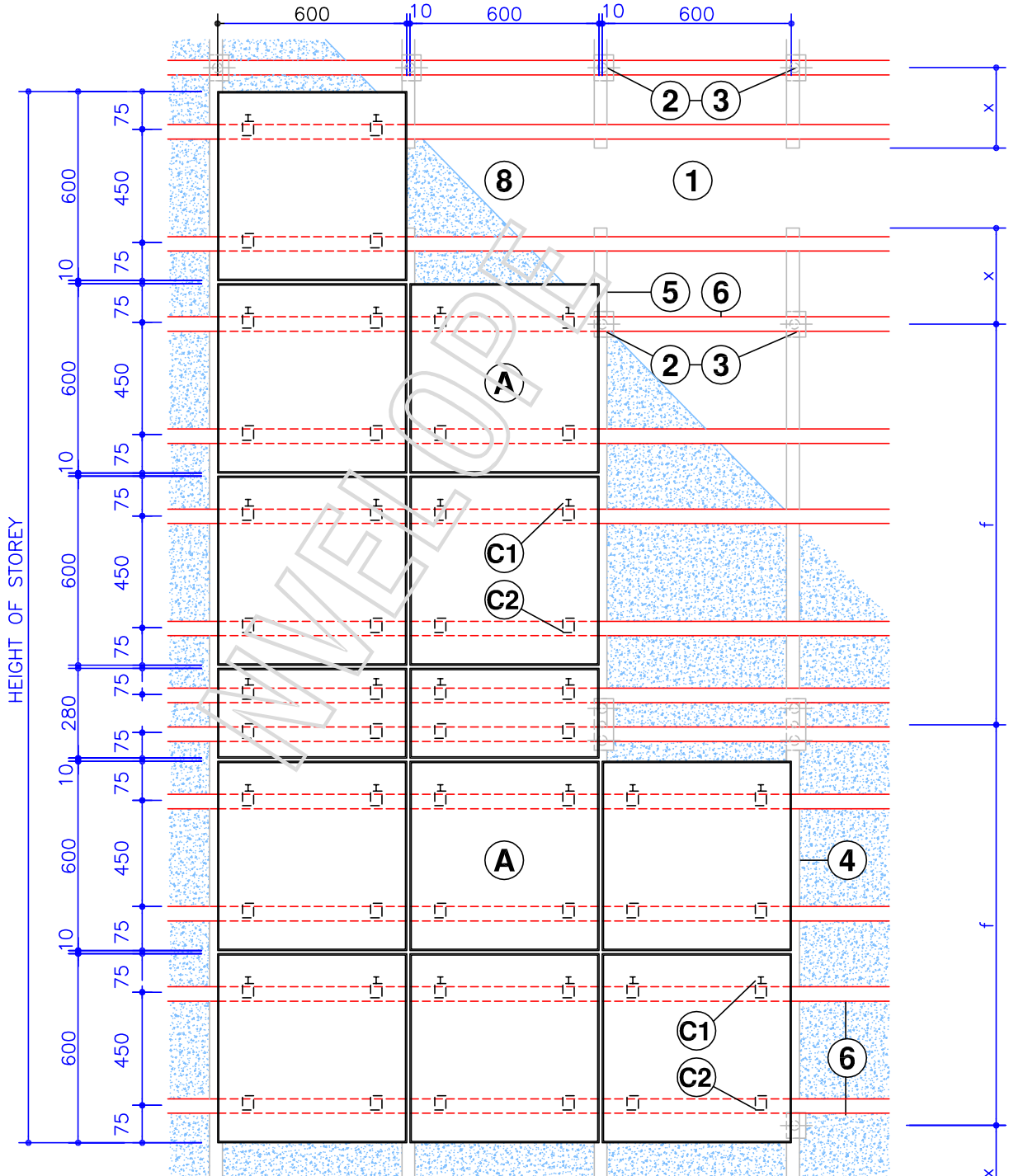

REFER TO TRESPA DESIGN
 GUIDE FOR DETAILS

PANEL MODULE 60 x 60 or 60 x 30
 ELEVATION OF CLADDING

REFER TO DRAWING
 TS200-17

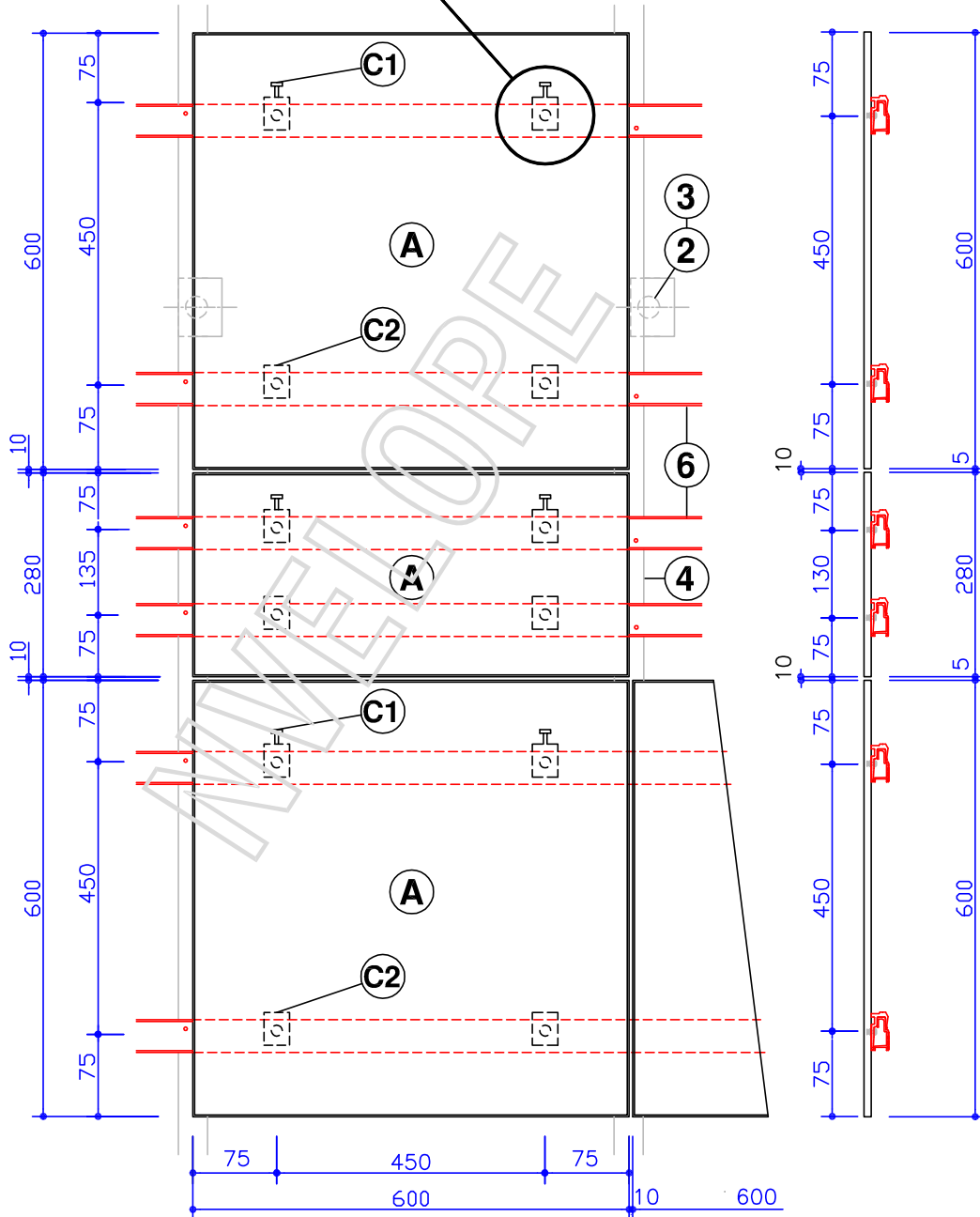

REFER TO TRESPA DESIGN
 GUIDE FOR DETAILS

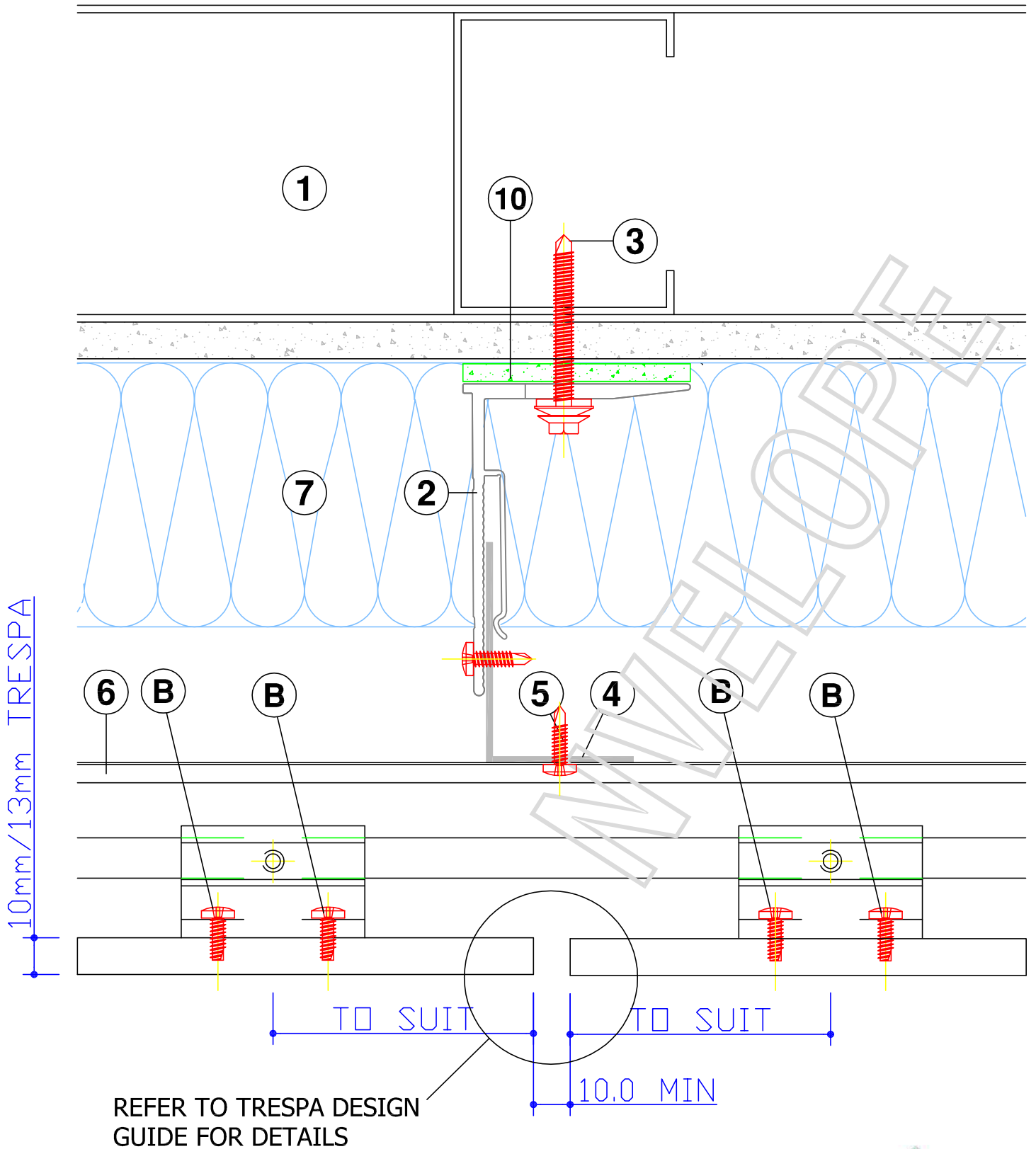

HORIZONTAL SECTION - NVELOPE 90

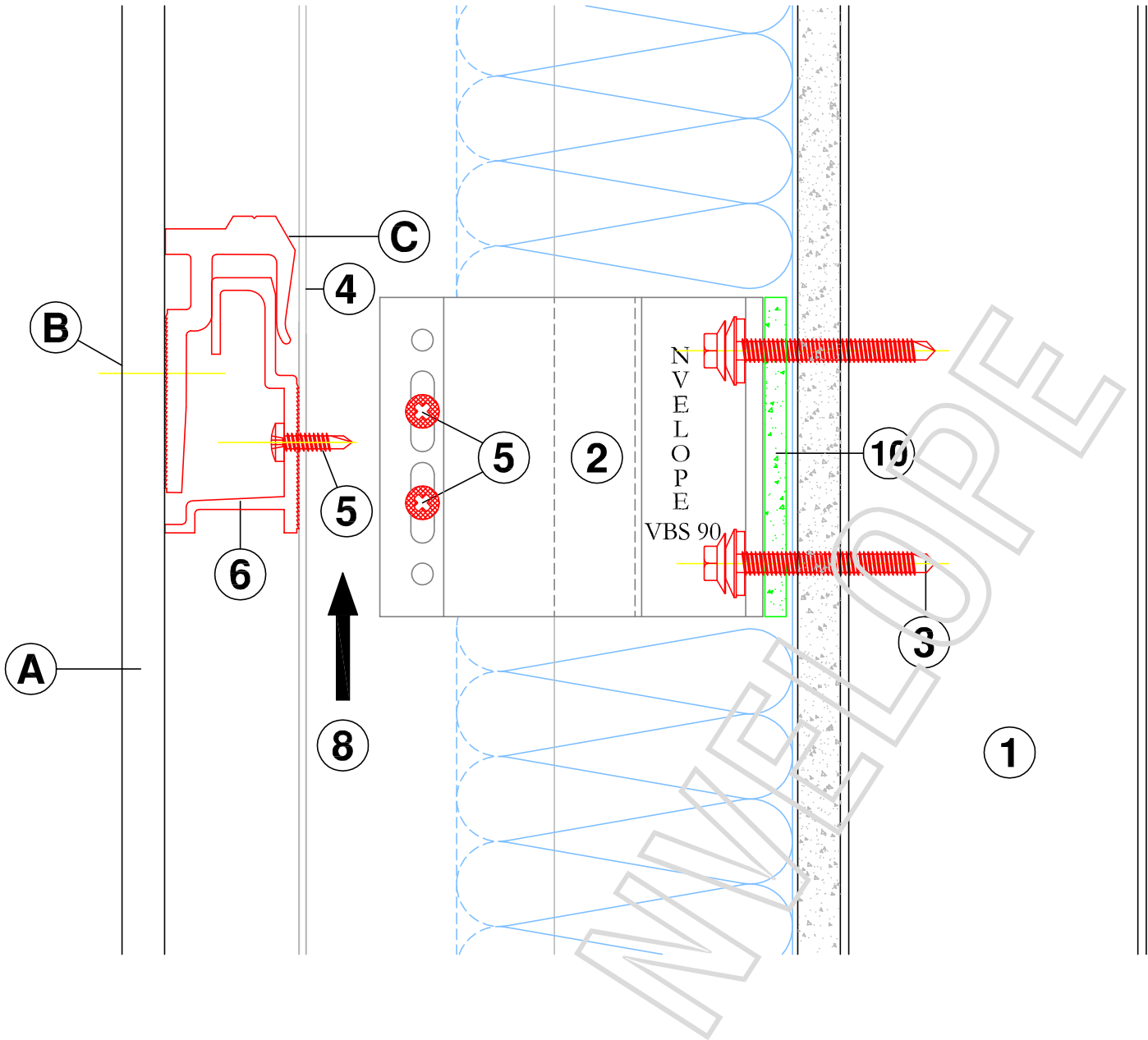

VERTICAL SECTION - NVELOPE 90 SINGLE

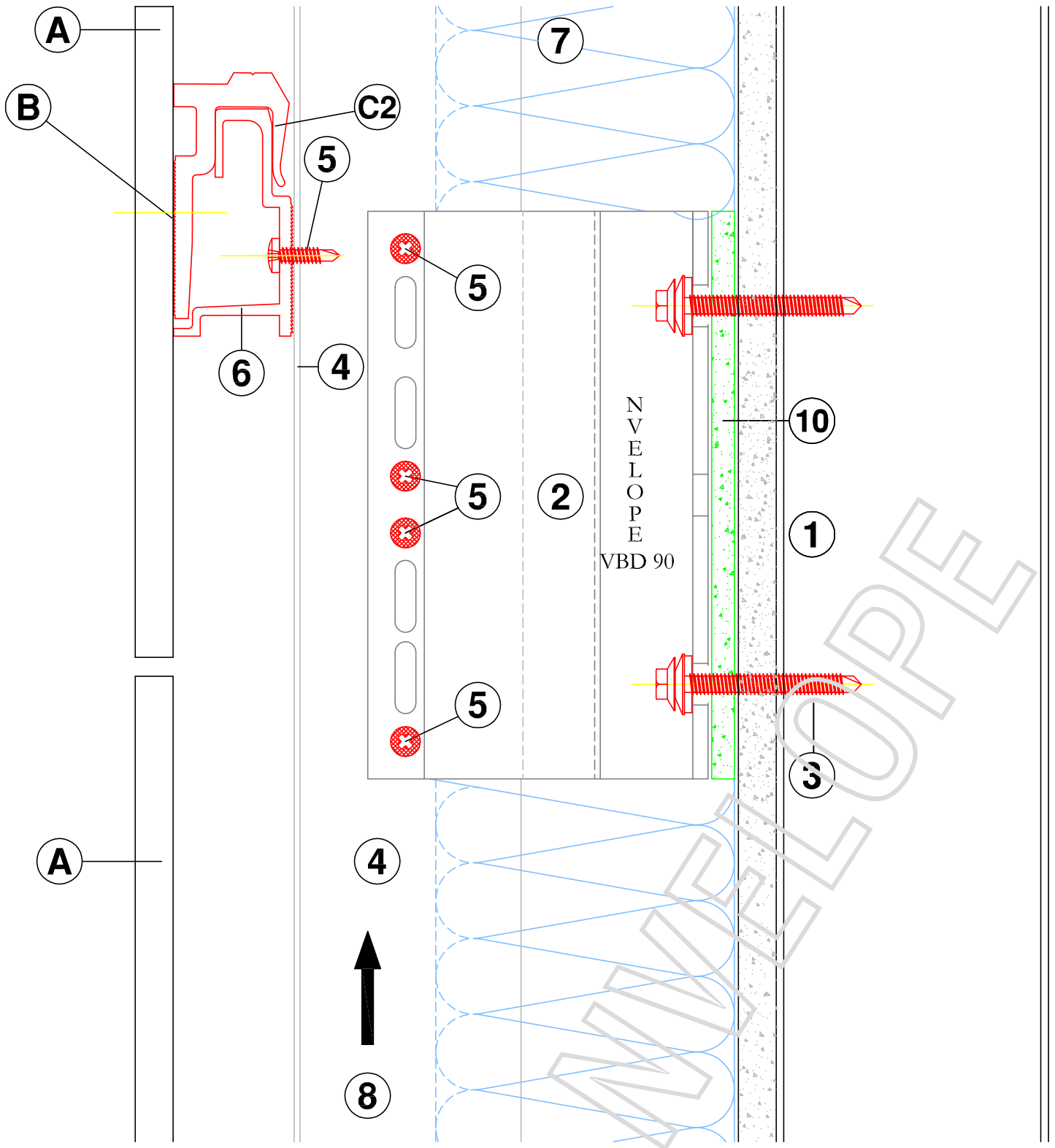

VERTICAL SECTION - NVELOPE DOUBLE

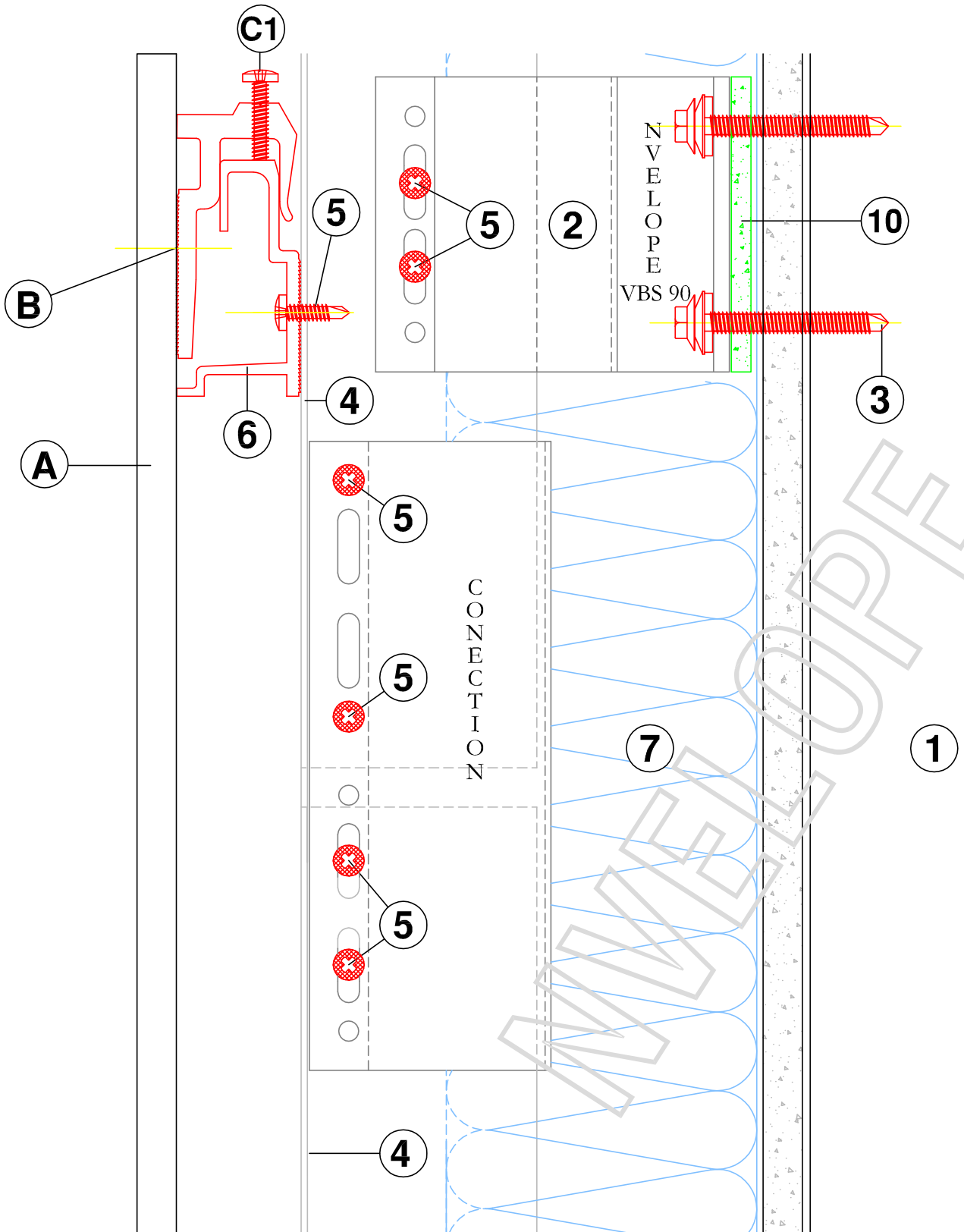

VERTICAL SECTION - CONNECTION PIECE - JOINING OF PROFILES

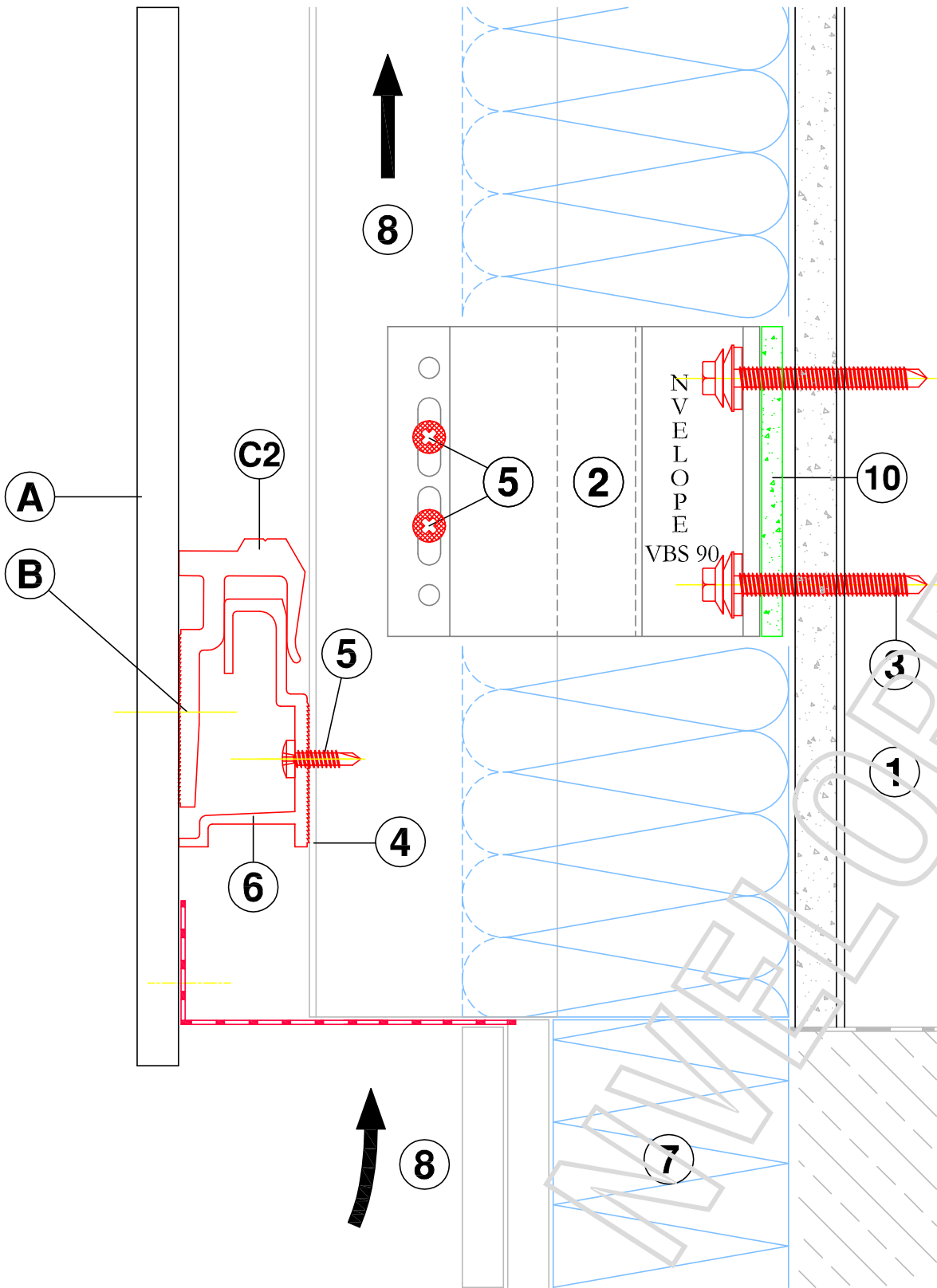

VERTICAL SECTION - BASE OF CLADDING

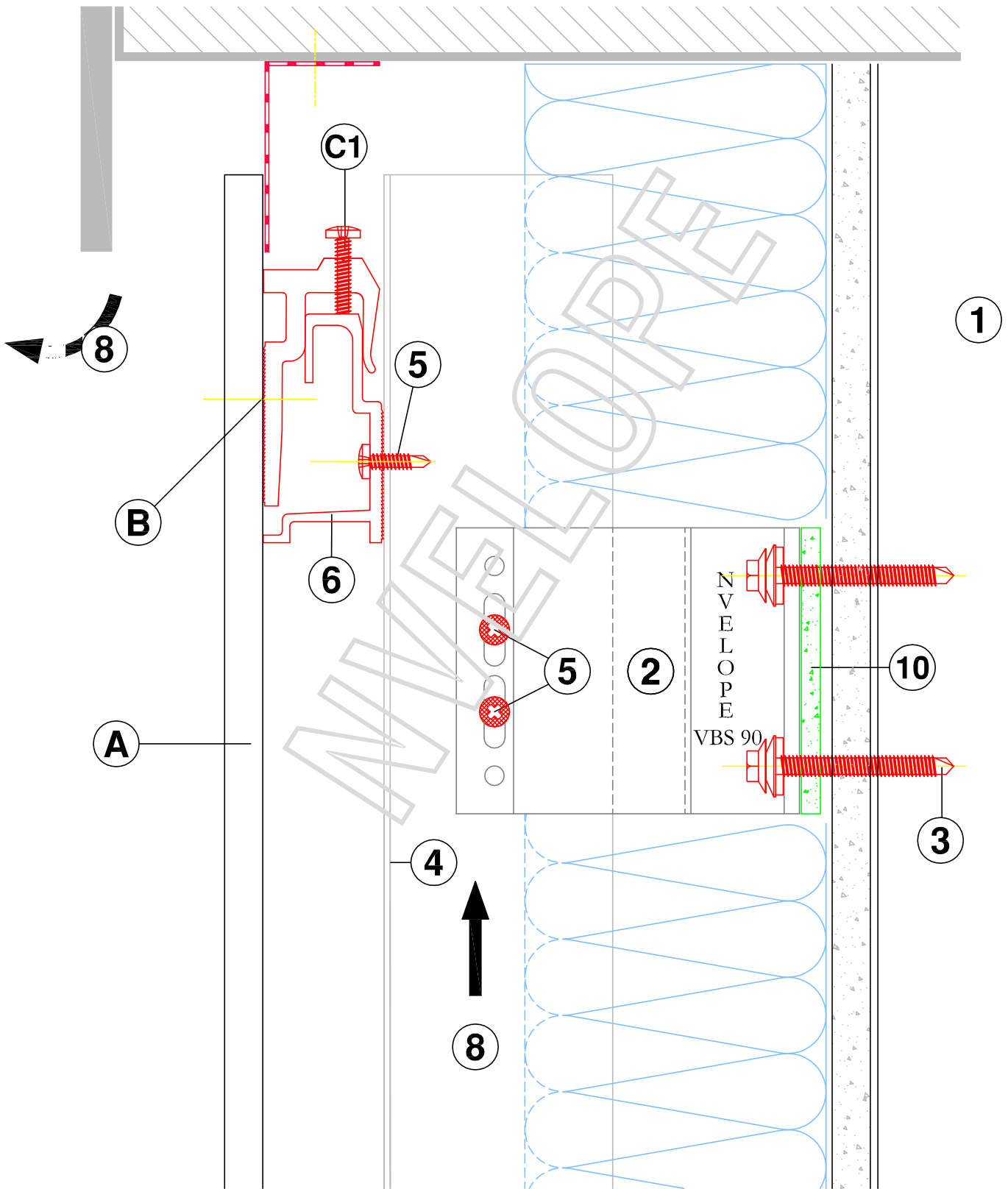

VERTICAL SECTION - HEAD OF CLADDING

NVELOPE

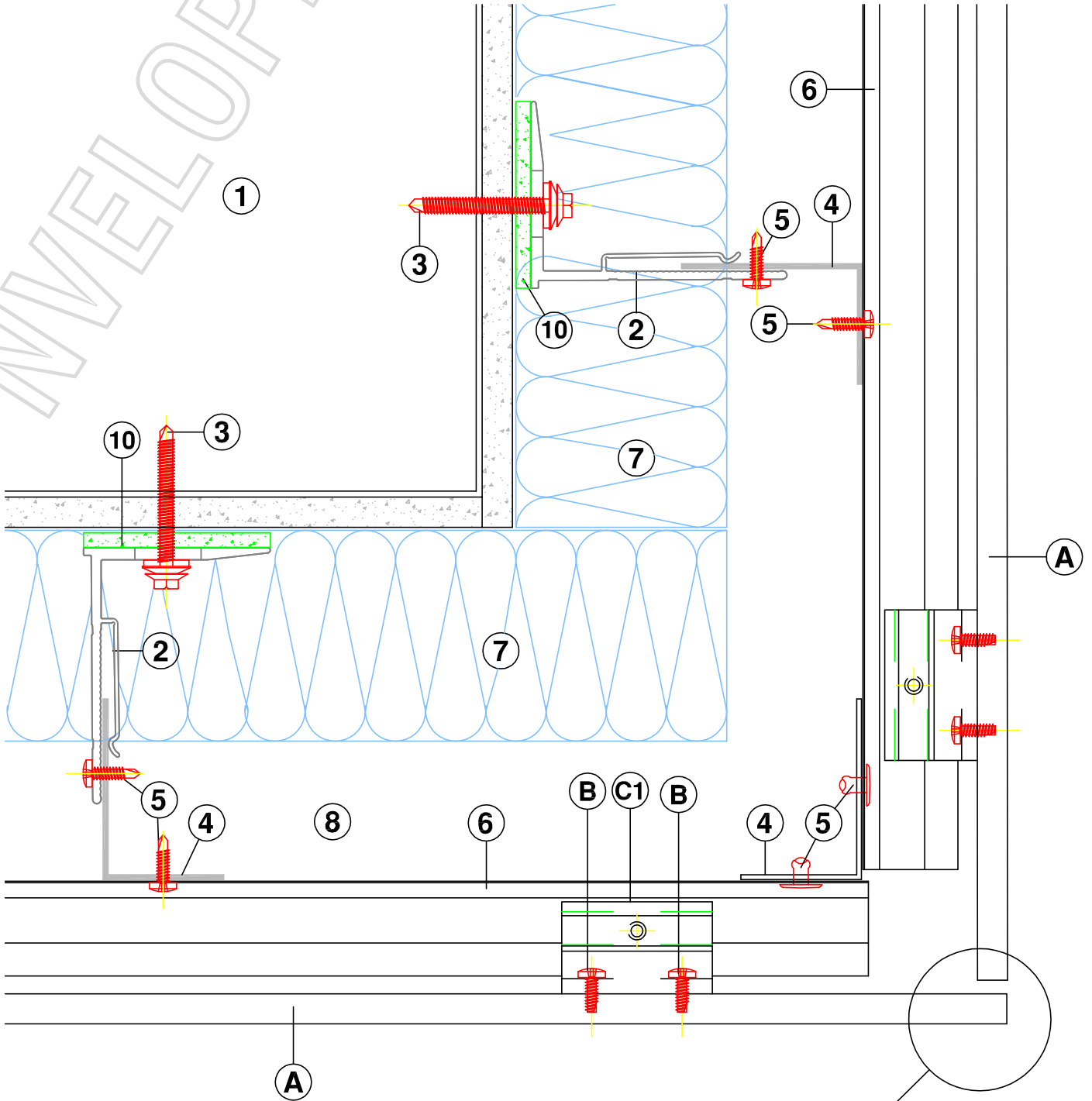

REFER TO TRESPA DESIGN
 GUIDE FOR DETAILS

HORIZONTAL SECTION - EXTERNAL CORNER

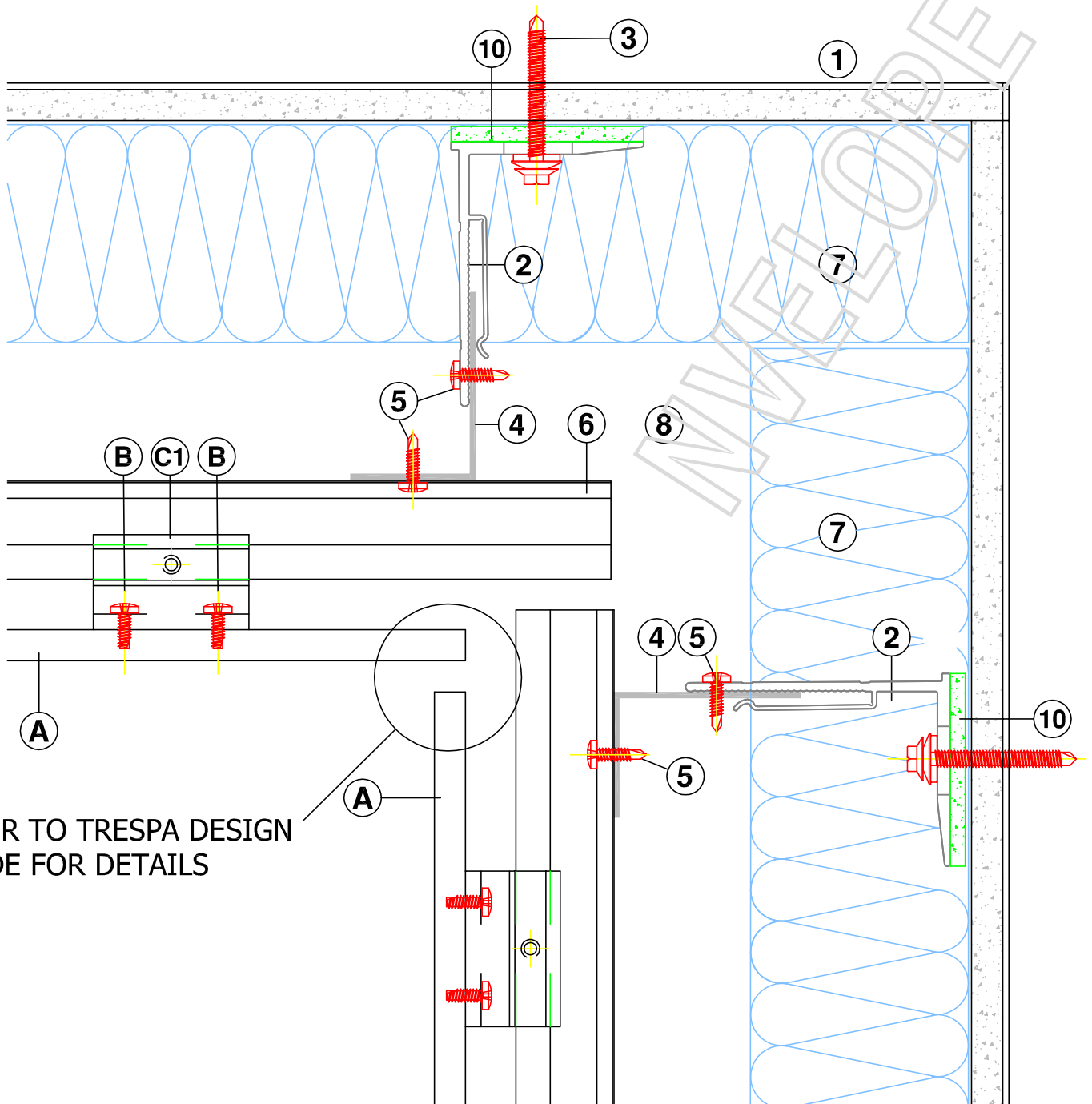

REFER TO TRESPA DESIGN
GUIDE FOR DETAILS

HORIZONTAL SECTION - INTERNAL CORNER

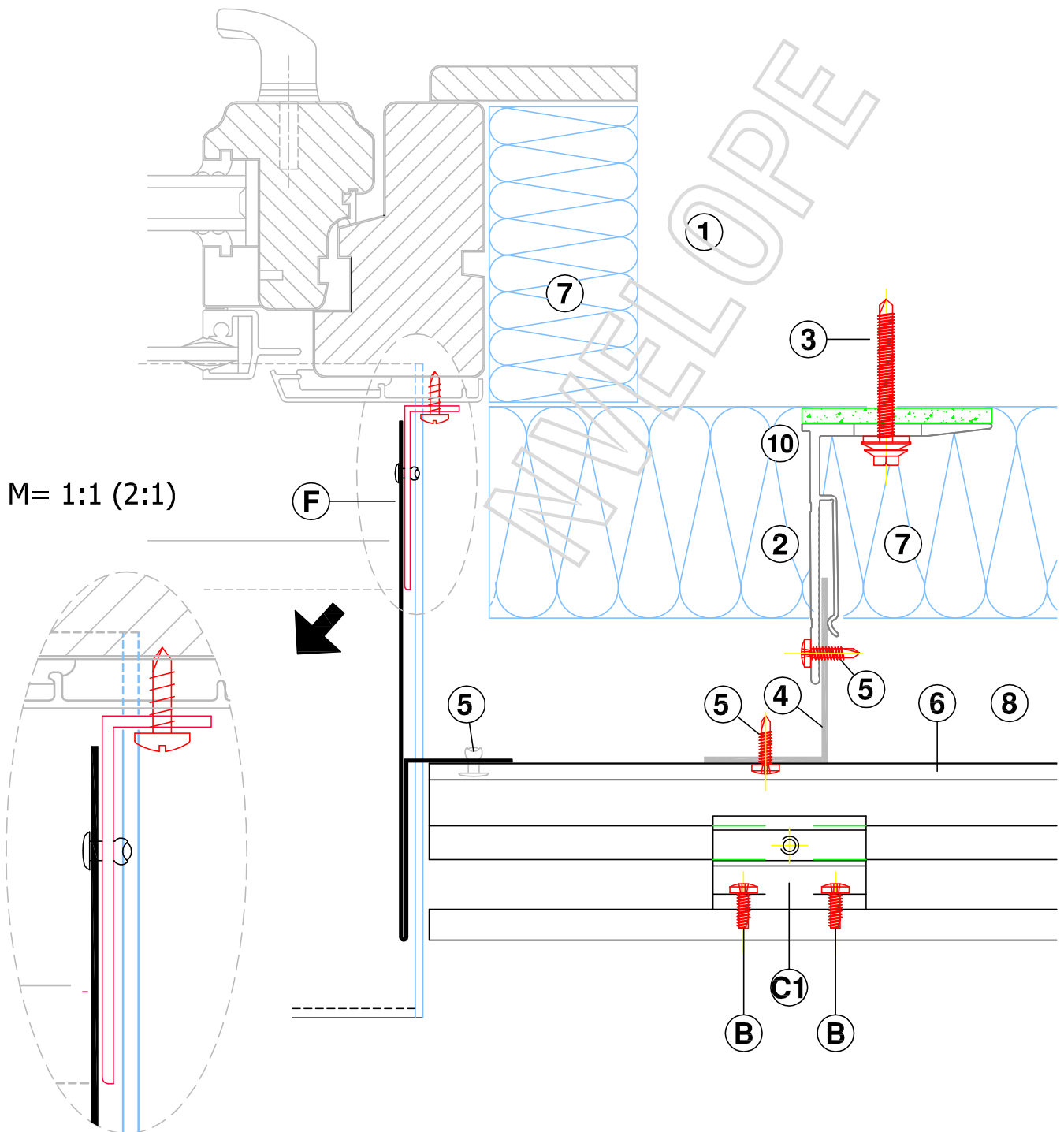

HORIZONTAL SECTION - WINDOW JAMB DETAIL

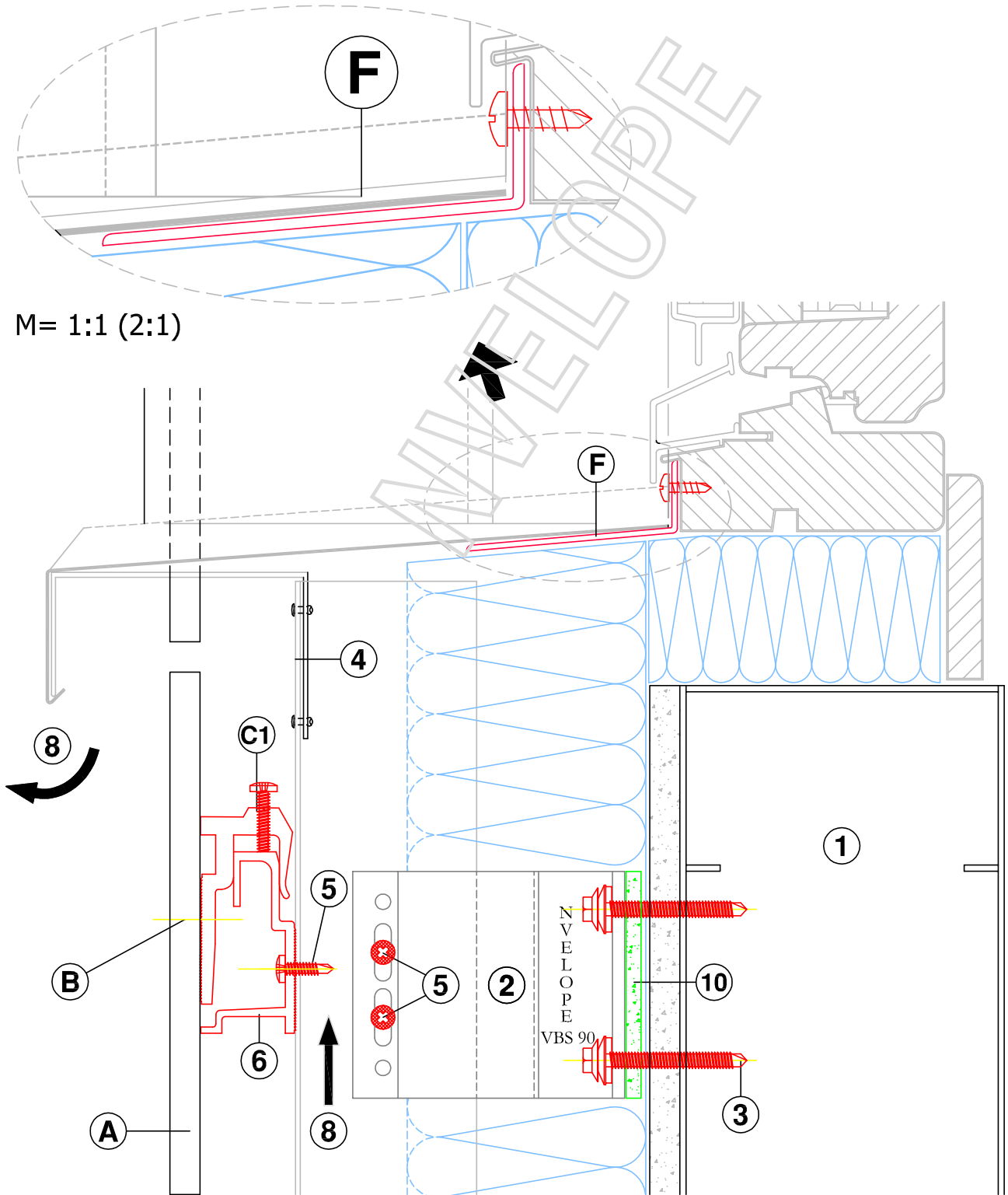

VERTICAL SECTION - WINDOW SILL DETAIL

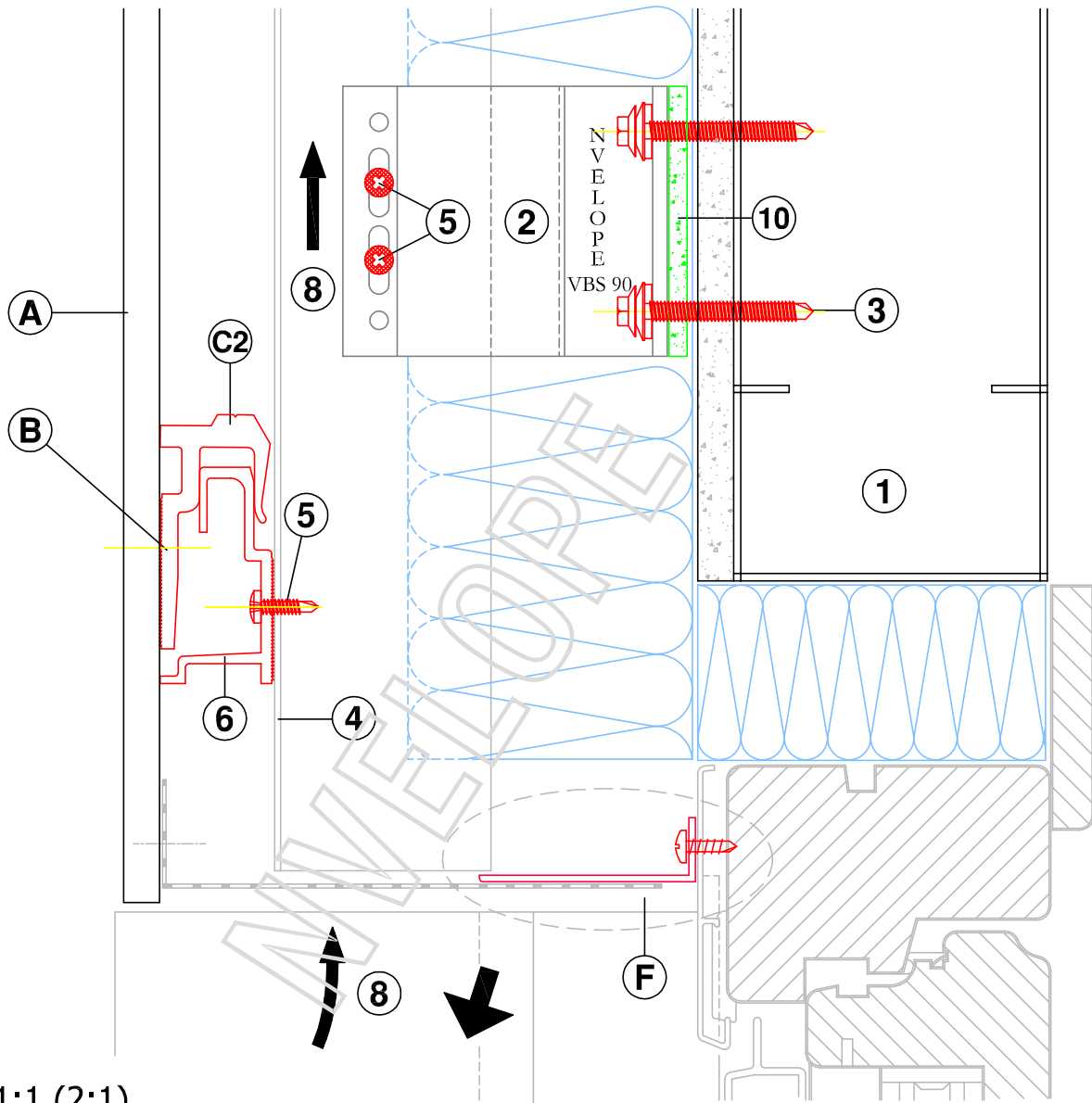

M= 1:1 (2:1)

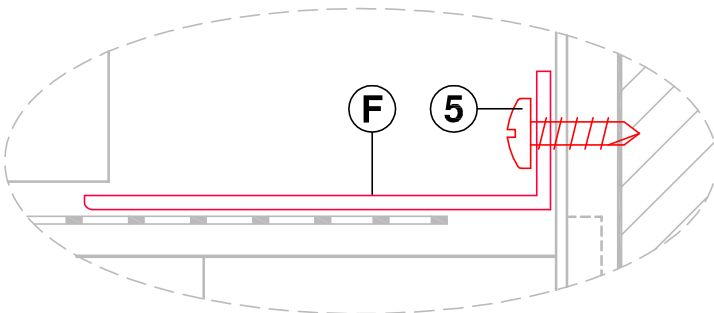

VERTICAL SECTION - WINDOW DETAIL HEAD

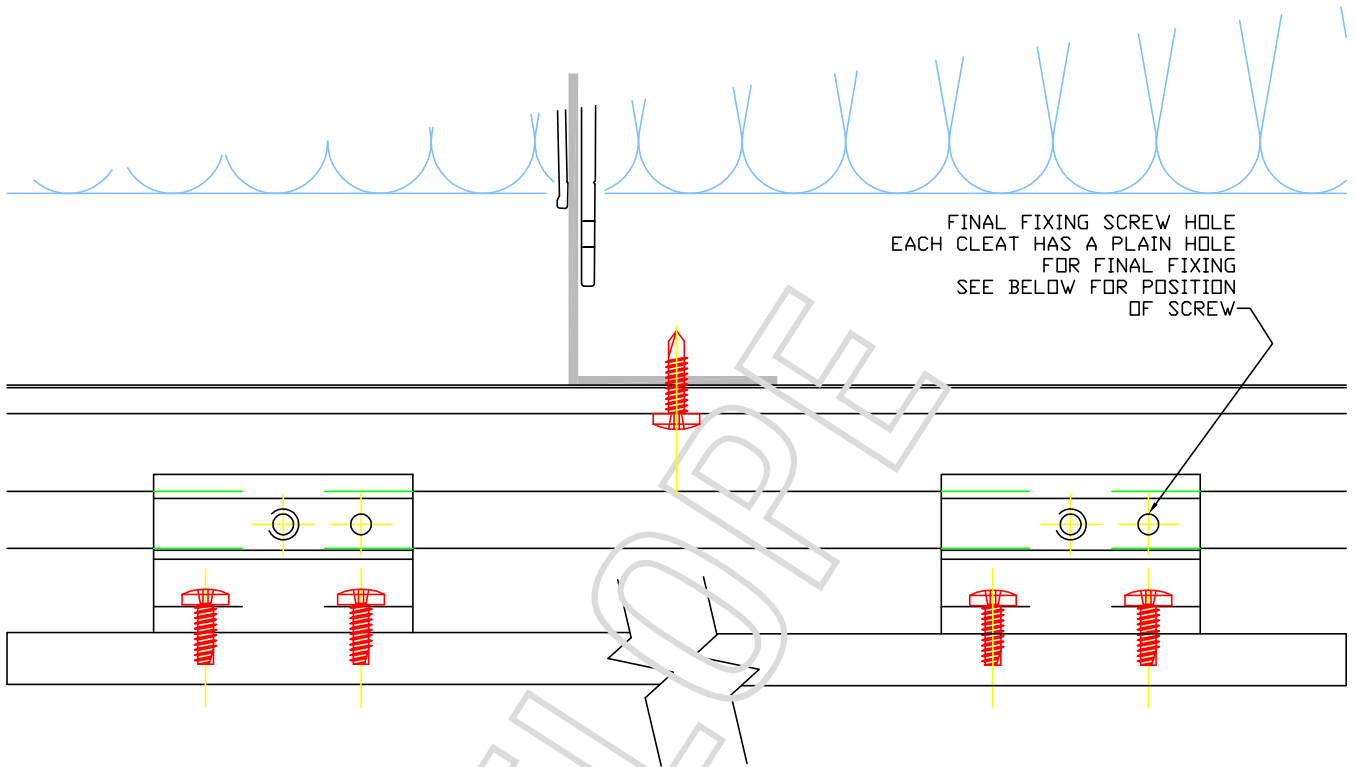

ONLY ONE FIXING REQUIRED PER PANEL AS SHOW BELOW REFER TO TRESPA DESIGN GUIDE

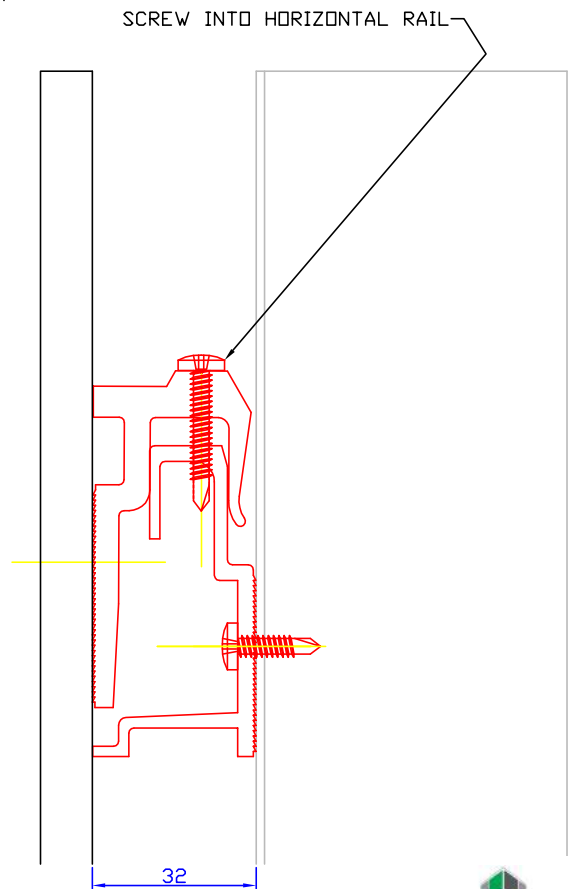
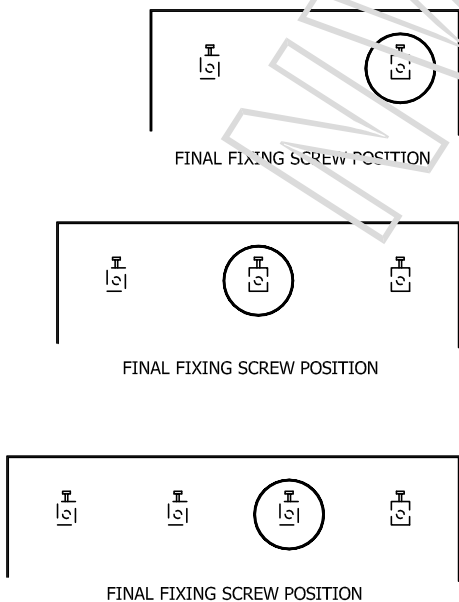

FINAL FIXING SCREW

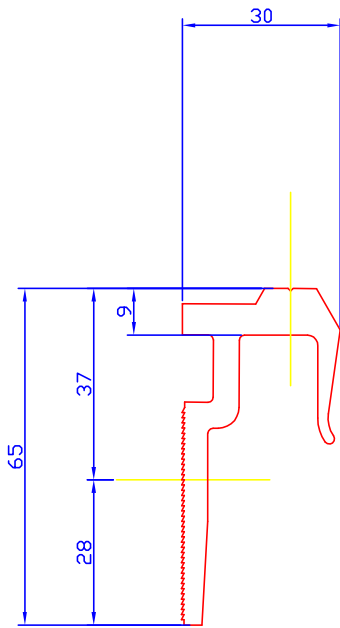

TS200 CLIP

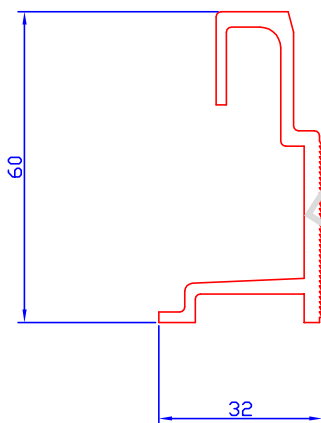
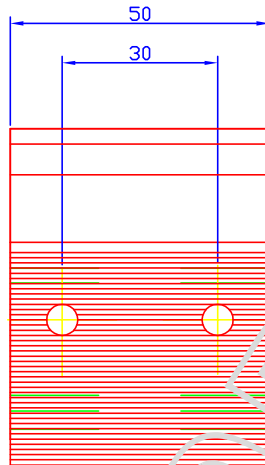

TS200 RAILS

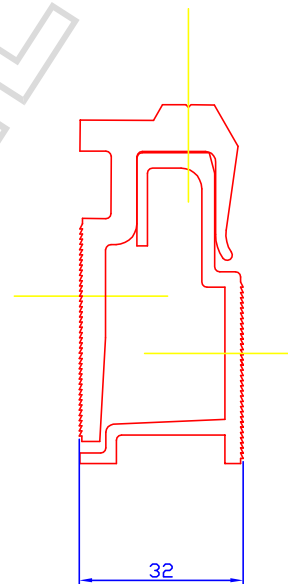

ASSEMBLY DIM